



we  clean

# User Guide

Vax Careline: AU: 1300 361 505  
NZ: 0800 800 900

## 12V Handheld

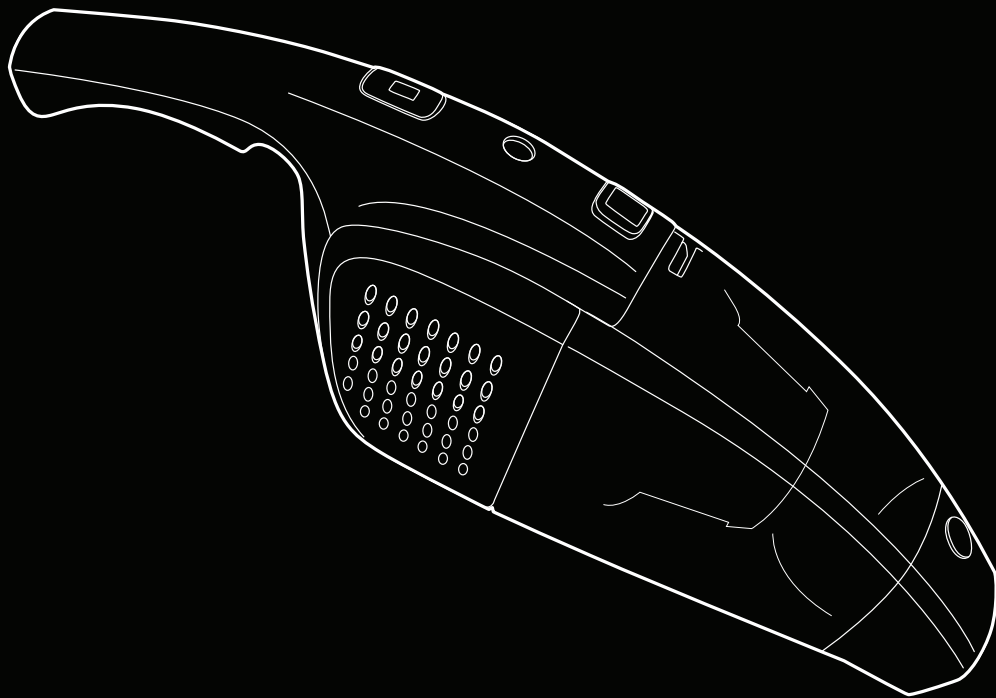

# Get Cleaning...

What's your Vax's model number?

V C - 0 9 0 2 H R

What's your serial number? (Located on the base of the machine)

■ - ■ ■ ■ ■ ■ ■ ■ - ■ ■ - ■ ■ - ■ ■ - ■ ■ ■ ■ ■ ■ ■ ■

Note these down in case you need them in future. Please keep instructions for further use.

[www.vax.com.au](http://www.vax.com.au)

VC-0902HR

Vax Service line  
AU: 1300 361 505 / NZ: 0800 800 900

# Machine Overview

- 1 Nozzle release button
- 2 Dirt container
- 3 Filter
  - a) filter shroud
  - b) filter
- 4 Dirt container release button
- 5 Charging indicator (blue LED)
- 6 On/off switch
- 7 Charging connection point
- 8 Charger
- 9 Dusting brush
- 10 Crevice tool

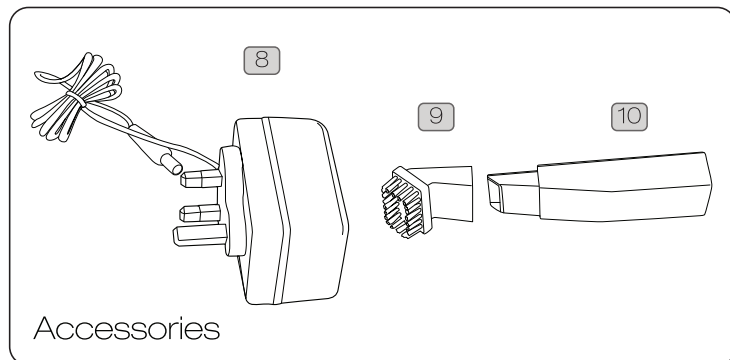
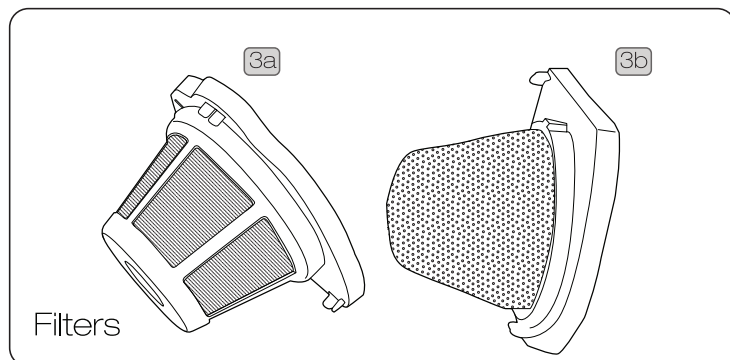
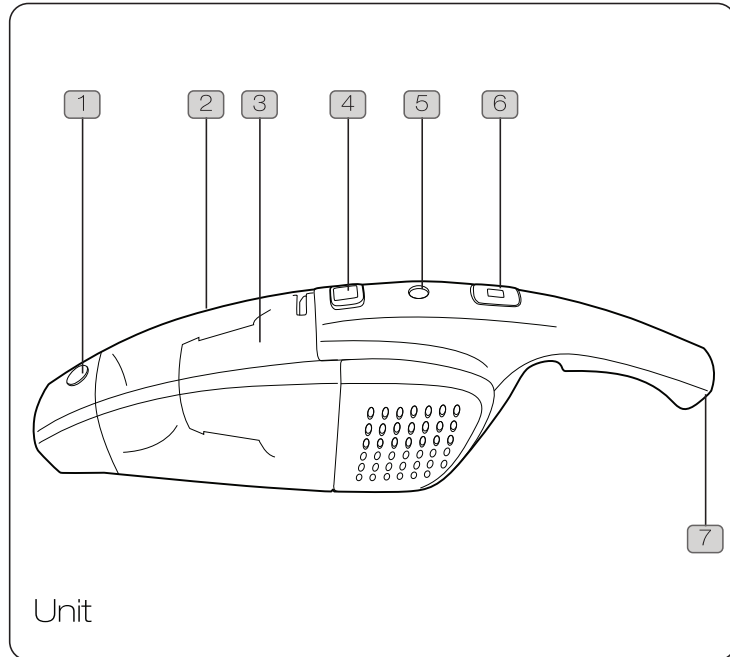

# General Safety Information

## FOR HOUSE HOLD USE ONLY.

When using the hard floor cleaner, basic safety precautions should always be observed, including the following:



**WARNING:** Do not use outdoors or on wet surfaces.

1. Do not charge the unit outdoors.
2. Turn off the handheld before connecting or disconnecting from the mains supply.
3. Children should be supervised to ensure that they do not play with the appliance.
4. This appliance is not intended for use by persons (including children) with reduced physical, sensory or mental capabilities, or lack of experience and knowledge, unless they have been given supervision or instruction concerning use of the appliance by person responsible for their safety.
5. Use only as described in this manual. Only use the manufacturer's recommended attachments.
6. Do not use the handheld vacuum if it has been dropped, damaged, left outdoors, or dropped into water. Do not use the charger with a damaged cord or plug. If the charger is damaged, it must be replaced by the manufacturer or a recommended Service Agent to avoid hazard and invalidating the guarantee.
7. Do not abuse the cord. Keep the cord away from heated surface. Do not pull the cord around sharp edges or corners. Do not close the cord in a door.
8. Do not handle the plug or appliance with wet hands.
9. Do not throw batteries into fire or expose them to high temperatures, as they may burst.
10. Do not use with any opening blocked; keep free of dust, lint, hair, and anything that may reduce airflow.
11. Keep hair, loose clothing, fingers and all parts of the body away from openings and moving parts.
12. Do not pick up hot coals, cigarette butts, matches or anything hot, smoking or burning objects.
13. Do not pick up flammable or combustible materials (lighter fluid, petrol, kerosene, etc) or use in the presence of explosive liquids or vapour.
14. Do not vacuum up harmful or toxic material (chlorine bleach, ammonia, drain cleaner, etc).
15. Do not use without the filter in place.

16. Do not vacuum up hard or sharp objects such as glass, nails, screws, coins, etc.
17. Turn off all controls before unplugging.
18. Take extra care when cleaning on stairs.
19. Store the appliance indoors in a cool, dry area.
20. Only use the charger supplied by the manufacturer to recharge.



**IMPORTANT:** For dry debris use only.



**WARNING:** Always switch off and unplug the handheld from the electrical outlet before assembling, opening or emptying the dirt container, or before connecting/disconnecting the attachments or performing any maintenance.



**IMPORTANT:** Remove the battery from the appliance before recycling. For further information please contact your local waste management centre.

**This machine is intended for house hold use only, and NOT for commercial or industrial use.**

**PLEASE KEEP THESE INSTRUCTIONS FOR FURTHER USE.**

# Operation

## Charging and operation

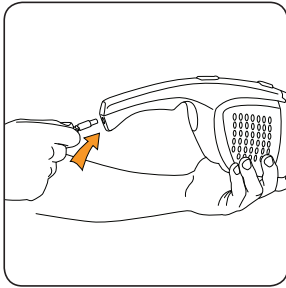

Plug charger into the mains and insert lead into back of unit.

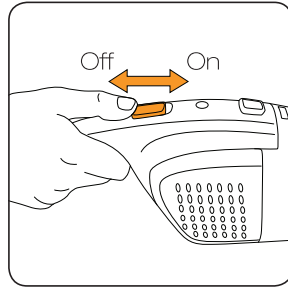

On/off switch.

**NOTE:** The initial charging time is 15 hours. While charging, the indicator will remain a steady blue. Once fully charged, the light will flash.

**NOTE:** Ensure the vacuum switch is in the 'off' position when charging.

## Tools

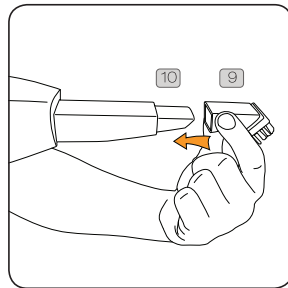
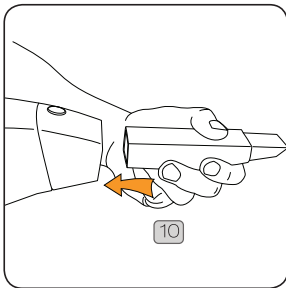

The crevice tool can be attached directly onto the nozzle. To use the dusting brush, attach to the crevice tool.

## Emptying the dirt container

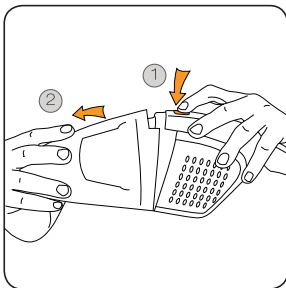

To open, press release button to remove the dirt container.

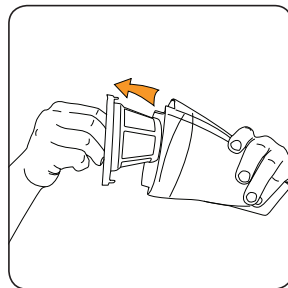

Remove filter.

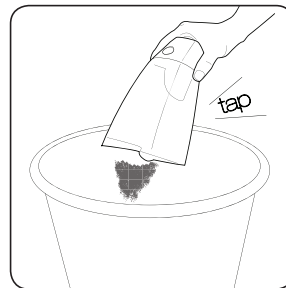

Empty over a bin.

# Maintenance (Keep your Vax as good as new)

## Dirt container and filter maintenance

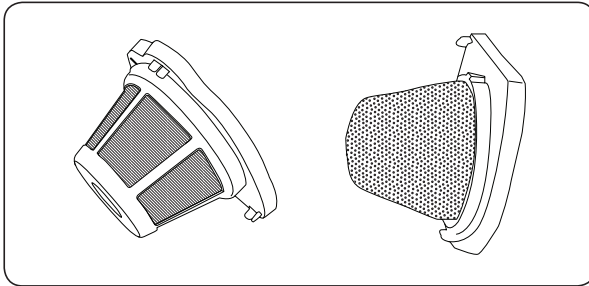

**!** **IMPORTANT:** The condition of the filter affects the performance of your machine. Please check and clean the filter periodically (depending on the level of use).

**!** **IMPORTANT:** Do not use the handheld without the filter in place.

## Cleaning the filter

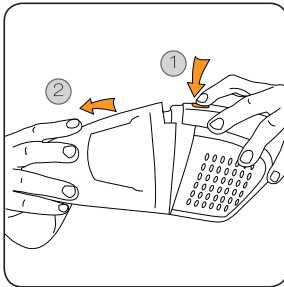

Press dust cup release button and separate.

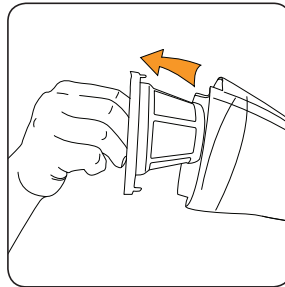

Remove the filter and shroud.

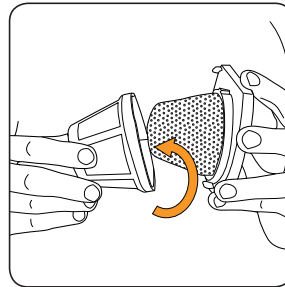

Turn anti-clockwise to separate the filters.



Tap filters against bin.

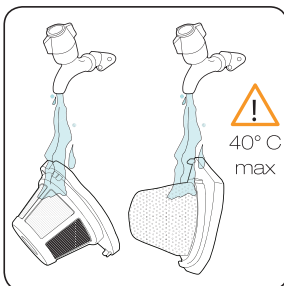

Wash filter if required.

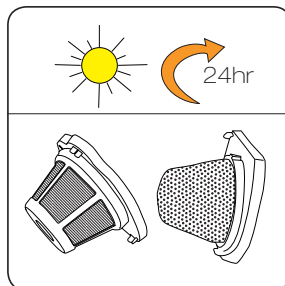

Allow to dry for 24 hours before placing it back in the machine.

# Maintenance (Keep your Vax as good as new)

## Cleaning the nozzle

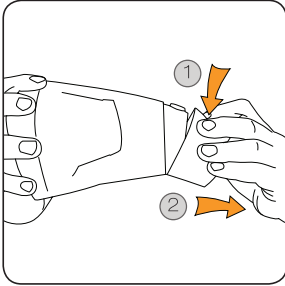

To open, press release button and pull nozzle away from dirt bin.

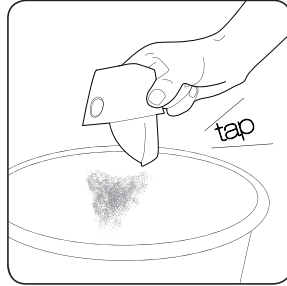

Shake excess dirt from dirt container. Tap nozzle against bin.

## To re-attach nozzle and dirt container

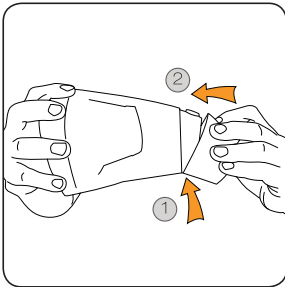

Align bottom of nozzle with dirt container and clip on.

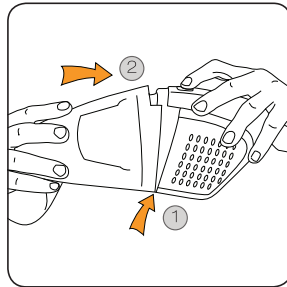

Align bottom of dirt container with main body and clip on.



**NOTE:** An audible 'click' can be heard when the nozzle and dirt container are re-attached correctly.



**NOTE:** Please ensure filter is located back in position when re-attaching nozzle and dirt container.

# Maintenance (Keep your Vax as good as new)

## Battery maintenance

### Disposal



**IMPORTANT:** The handheld vacuum contains a battery that must not be disposed of in your domestic waste. Check with your Local Authority for recycling advice.





# FAQ's



**WARNING:** To reduce the risk of personal injury, unplug the hard floor cleaner before performing maintenance/troubleshooting checks.

Problem	Solution
Why will the handheld not run?	The battery may not be charged. To charge the battery, the power switch must be in the 'off' position. The static blue light shows the unit is charging. The initial charge should be for 15 hours.
	For further assistance, Simply call us on <b>AU:</b> 1300 361 505 <b>NZ:</b> 0800 800 900
Why won't the handheld pick up?	The nozzle or crevice tool may be blocked; remove the obstruction.
	The filter may be clogged or dirty; clean the filter. Refer to the Maintenance section.
	The battery charge is getting weak; let the battery run until the vacuum slows and recharges.
	The dirt container is full; empty the container.
	For further assistance, Simply call us on <b>AU:</b> 1300 361 505 <b>NZ:</b> 0800 800 900
Why won't the battery recharge?	The charger may not be inserted correctly.
	Check the mains power is switched on.
	The electrical outlet may not be working; check the fuse or breaker and consult an electrician.
	For further assistance, Simply call us on <b>AU:</b> 1300 361 505 <b>NZ:</b> 0800 800 900



we  to help

Don't take me back to the shop, simply call us

AU: 1300 361 505  
 NZ: 0800 800 900 [www.vax.com.au](http://www.vax.com.au)

This does not affect your statutory rights

# Other Information

## Vax Service & Help

### Vax Careline:

Australia 1300 361 505

New Zealand 0800 800 900

Monday-Friday 8.30am to 5.00pm

If you have queries or concerns about using your Vax, call the Vax Careline. Calls are charged at the standard local rate. Please make a note of the serial number and model number of the vacuum cleaner before calling.

For the nearest Service Agent, please call the Vax Customer Careline or visit [www.vax.com.au](http://www.vax.com.au)

## Technical Specification

Battery Voltage:	12V
Capacity:	0.5L
Runtime:	15 minutes
Weight:	1.3kg
Charger input wattage:	230-240V ~ 50Hz , 13 Watt
Charging time:	15 hours
Filter type:	Washable

Subject to technical change without notice.



Waste electrical products should not be disposed of with household waste. Please recycle where facilities exist. Check with your Local Authority or retailer for recycling advice.

# Notes

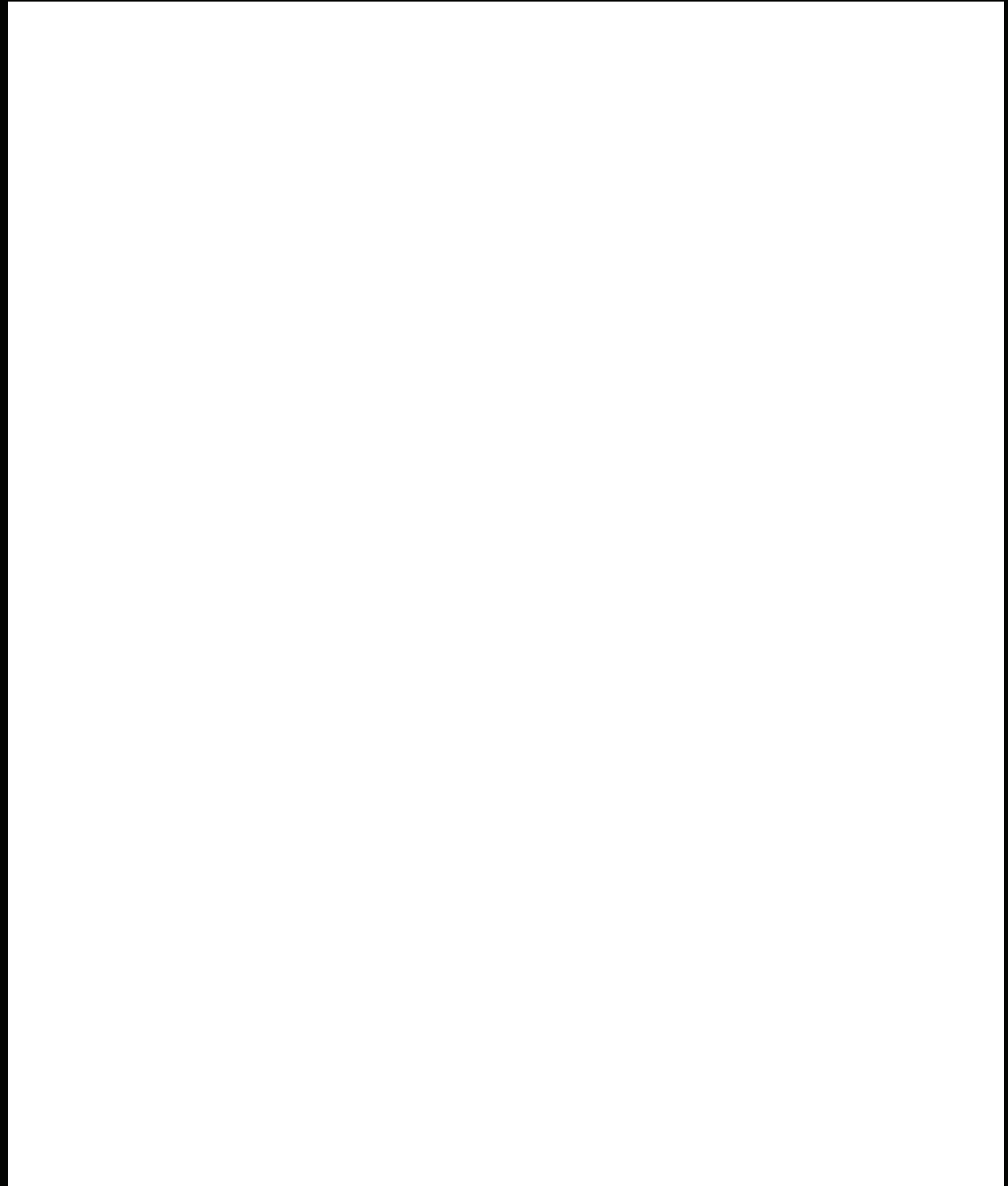



we  clean

Distributed by Techtronic Industries Pty. Ltd.  
Level 1, 660 Doncaster Road, Doncaster, Australia 3108.  
[www.vax.com.au](http://www.vax.com.au) Service Line: AU: 1300 361 505 / NZ: 0800 800 900