



TRAILPARTS PRODUCT HOW-TO GUIDE

WIRING INSTRUCTIONS FOR
Trailparts™ Credo™ Brake Control
to suit electric drum brakes

**4500KG
GVM**

CREDO CAB CONTROLS

The Trailparts™ Credo™ Braking system meets Australian Design Rules 38 braking regulations and is legal for trailers up to 4500kg GVM when used according to these instructions.

TO OPERATE:

- > The in-cab controller must be connected at all times and located within easy reach of the driver.
- > The vehicle park or head-lights must be switched on when towing the trailer. This energizes the trailer side of the system and also will allow the trailer batteries to charge.
- > Check the plug and socket of the trailer and tow vehicle are securely connected and that the trailer lighting functions all work correctly. A faulty or intermittent lighting connection could mean the brakes do not operate correctly.
- > Ensure the break away cable is securely fastened to the vehicle.
- > Test the emergency brake is working. First adjust the gain control setting to read 75%. Depress emergency stop button fully, and begin to pull forwards while still holding the button down. The trailer brakes should lock the wheels.
- > Do not use the emergency stop feature or breakaway function as a parking brake.



CREDO CAB CONTROLS

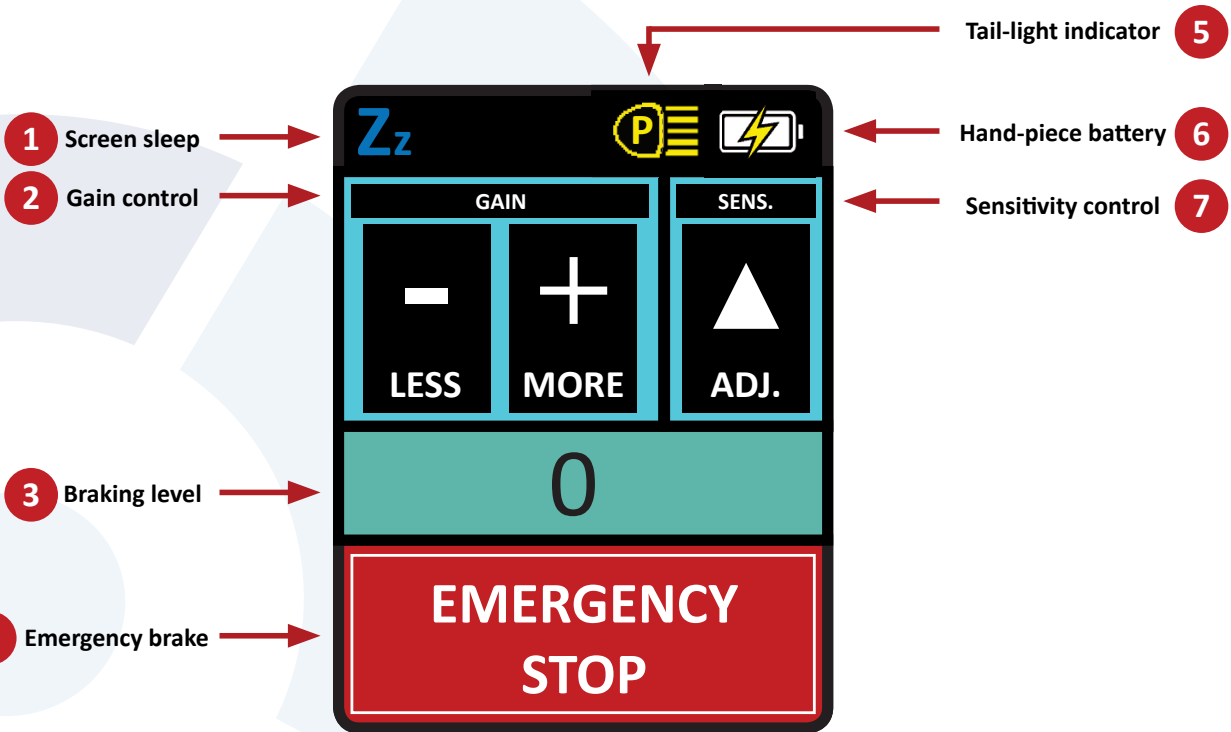

Credo Cab Controls

1 Screen Sleep Button

Press and hold for 5 seconds. Unit will beep 6 times and display sleep menu. When put to sleep while plugged into power, tap screen to wake. If put to sleep while unplugged, unit will need to be plugged into power again to wake up.

Gain Control - Adjusting Gain Control:

Press either button once to show current gain setting.

2 The plus button will increase the maximum brake percentage, and the minus button will decrease it. This should be set so the vehicle will brake to a halt without the trailer wheels locking up. An effective benchmark is to perform a brisk stop on a straight flat stretch of road from 30 kph. The vehicle trailer combination should halt without the trailer wheels locking. Increase or decrease the gain setting until the trailer is braking at just under the lock up level. Ensure conditions are safe around you before carrying out this procedure.

3 Braking Level

This number displays braking level during braking and gain and sensitivity settings.

4 Emergency Brake

When activated, this will apply the trailer brakes at 75% of the current gain setting. This can be used to control trailer sway situations and stop the vehicle combination in an emergency.

5 Tail-light Indicator

Confirms tail-lights are on. Shows red X if tail-lights not detected

6 Hand-piece Battery

Status of hand-piece batteries

Sensitivity Control

7 Press once to show current setting. Controls determine how quickly and aggressively the brakes will activate, with 1 being least and 5 the most aggressive. Pressing this advances the setting from 1 up to 5 and then back to 1. Setting this to 3 provides mid-range braking. Decrease setting to 2 or 1 if brakes come on too suddenly. Increase setting if braking action seems too slow.

CREDO SCREEN CONTROLS AND WARNINGS



Headlights Warning

Will flash on screen with 4 beeps if headlights are not on on the trailer or there is a loss of communication between the trailer and cab modules. In the event of communication loss, providing the headlamps are on and the lighting connection between the tow vehicle and the trailer is not faulty the brakes will continue to operate at the last setting. This should however be investigated as soon as it is safe to stop.

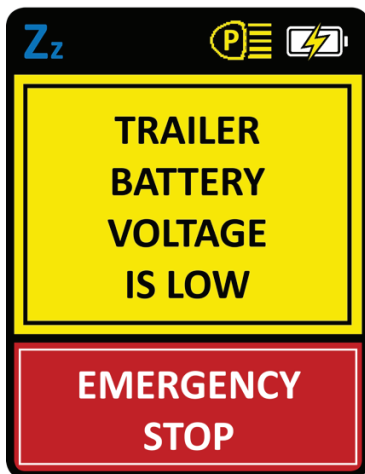

Low Trailer Battery Warning

Will flash and beep 4 times each time the brakes or emergency brake are applied if the trailer battery voltage has dropped to an unsafe level, which would result in the brakes not operating correctly. This screen will also display if the trailer battery is disconnected.



Sleep Menu

Press and hold 'Zz' in the top left corner of the screen for 5 seconds. Credo unit will beep 6 times and display sleep menu shown to the left. Press the indicated area of the screen to put the unit into sleep mode or press cancel to return to the home screen.

When put to sleep while plugged into power, tap screen to wake. If put to sleep while unplugged, unit will need to be plugged into power again to wake up.

Note: Trailer module is compatible with 12 or 24 volt. Cab unit is compatible with standard vehicle USB ports or 12 or 24 power sockets providing a 12-24 volt USB adapter is used.

CREDO INSTALLATION INSTRUCTIONS

- > Mount the Brake controller according to the mounting orientation instructions on page 7.
- > Wire the brake controller according to the instructions on page 6.
- > It is important that trailers fitted with the Credo™ braking system are also fitted with 12/24 volt LED lights, not LED or incandescent lights that are voltage specific
- > The controller is capable of running trailers with up to 6 wheels braked with electric drum brakes.
- > The earth from the trailer brakes and the trailer battery must only connect to the brake controller output earths as shown in the diagram. They cannot be connected to a common chassis earth.
- > Cable gauge should be of sufficient size to avoid voltage drop. For electric drum brakes a minimum of 15 amp cable should be used and a separate feed should be run per two wheels that are fitted with brakes.
- > The trailer lights must only be connected to the 5 core lighting output from the controller and cannot bypass this directly to the trailer plug.
- > There is a spare orange wire and pink wire that are not used when installing on a trailer fitted with electric drum brakes. These can be cut short and taped off.

ELECTRIC DRUM WIRING DIAGRAM



Wiring diagram above applies to SE Brake Controller with electric drums only

ON-TRAILER MODULE MOUNTING ORIENTATION

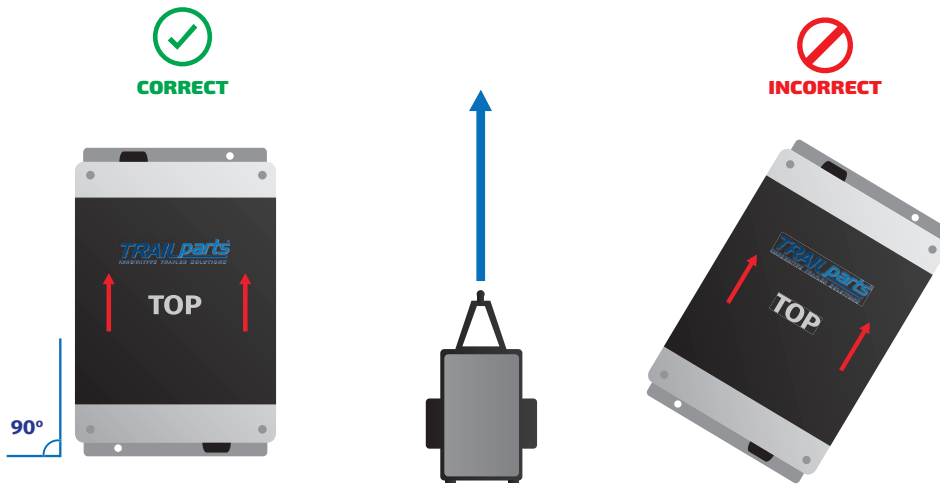

DIRECTION OF TRAVEL

Must be mounted straight longitudinally, i.e. parallel to the direction of travel

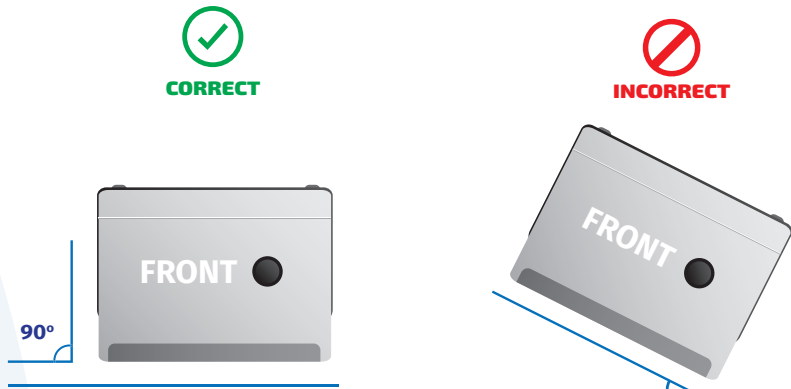

Unit must be level laterally



Direction of travel

Back can be up to 70 degrees up

OR

Back can be up to 20 degrees down

MAINTENANCE AND CHECKS

- > Check battery is keeping well charged. A well charged battery should be at or above 13 volts. This is particularly important if the trailer is left parked for extended periods of time. If the trailer is not used for extended periods the battery should be removed every 2 months and charged to ensure it does not become damaged. This can happen if the battery charge drops below 10.5 volts.
- > Check the trailer plug and vehicle socket to ensure they are not damaged and they give a sound electrical connection. An intermittent or faulty connection could mean the brakes do not function correctly.
- > If fitted with a hydraulic actuator make sure the fluid level remains sufficient. The fluid should be changed in line with general trailer service intervals.
- > If fitted with electric drums make sure they are kept properly adjusted and that the magnets and linings are not excessively worn and are replaced in line with general trailer service intervals.

OTHER INFORMATION

The trailer and cab parts of the controller are uniquely paired together by their serial numbers.

The serial number is a 3 or 4 digit number and is located on the bottom of the cab unit and is stamped on the front of the trailer unit.

FOR MORE INFORMATION

www.trailparts.com.au

1300 538 598