

# Scandinova



## Operating Instructions

FFA 253/286 FRIDGE FREEZERS



Thank you for purchasing a model from the Scandinova range. Please note that these instructions apply to all fridge-freezers in the FFA family. Illustrations and fittings may therefore not necessarily correspond exactly to your model.

## Warning

As the refrigerant used in this appliance is a flammable gas (Isobutane R600a), special care should be taken during transport, positioning and installation.

Do not use mechanical tools or other artificial ways of speeding up defrosting than those recommended by the manufacturer.

The unit must only be serviced by a qualified service centre

## Old appliances

Old refrigeration appliances are often fitted with complicated latches that can only be opened from the outside. If you have one of these old units stored away somewhere, or if you scrap it, remember to destroy the latch in order to prevent children from being exposed to danger by getting locked inside the unit.

## Disposal

This appliance contains materials which are recyclable. When disposing of the appliance you should contact your local authority technical department, who will inform you of how collection and recycling of such appliances takes place in the local authority area.

## Before use

Before operating this appliance, please read the following instructions carefully, as they contain the basic information on safe installation, operation and maintenance.

On receipt, check to ensure that the cabinet has not become damaged during transport. Transport damage should be reported to your supplier before the cabinet is put to use.

Remove all transit packaging. Wash the inside of the appliance with luke warm water with a little bicarbonate of soda added. Do not use soap or detergent as the smell may linger. Dry the appliance thoroughly.

**If during transport the appliance has been laid down, or if it has been stored in cold surroundings (colder than +5 °C) it must be allowed to stabilise for at least 1 hour before being switched on.**

## Intended usage

This appliance is intended for domestic use. It is suitable for storing and freezing food.

This appliance does not contain asbestos PCB's or CFC's in the construction.

## Contents

The fridge-freezer.....	3
Setting up and building in.....	4
Reversing the door.....	7
Electrical connection.....	8
Control panel.....	9
Refrigerator section.....	11
Freezer section.....	12
Defrosting.....	13
Cleaning.....	13
Fault finding list.....	14
Usefull hints.....	15

# The fridge-freezer (Frost free)

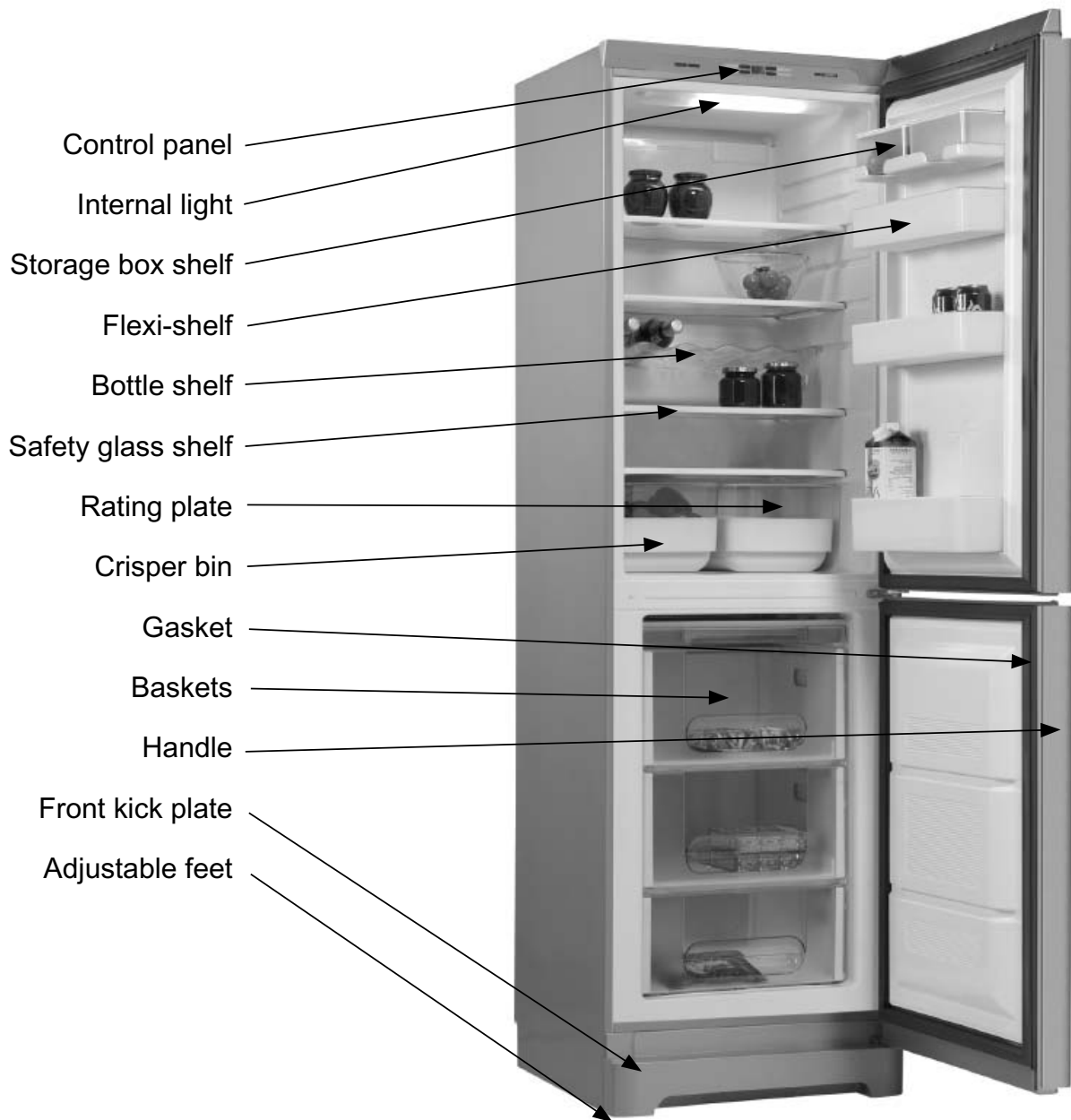

fig. 1

# Setting up and building in

## Positioning the cabinet

For safety and operational reasons, do not position the cabinet outdoors.

Your fridge freezer should be placed in a dry and well ventilated room.

Never place the cabinet close to sources of heat such as ovens or radiators, and avoid placing it in direct sunlight.

## Measure room temperature

The climate class is stated on the rating plate. This specifies the optimum temperature range for cabinet operation.

Climate Class	Ambient temperature
SN	+10 °C to +32 °C
N	+16 °C to +32 °C
ST	+18 °C to +38 °C
T	+18 °C to +43 °C

## Installation

The surface on which the appliance is placed must be level. Do not use a plinth or similar.

The appliance can be installed free-standing against a wall, built into a kitchen cupboard, or lined up with other models of the same width (fig. 2-3).

## Warning:

Do not damage the refrigerant circuit.

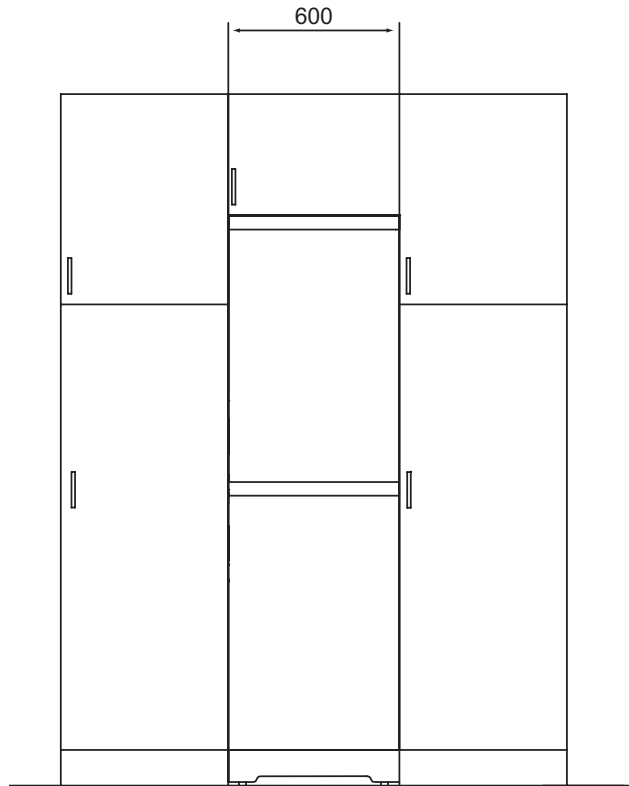

fig. 2

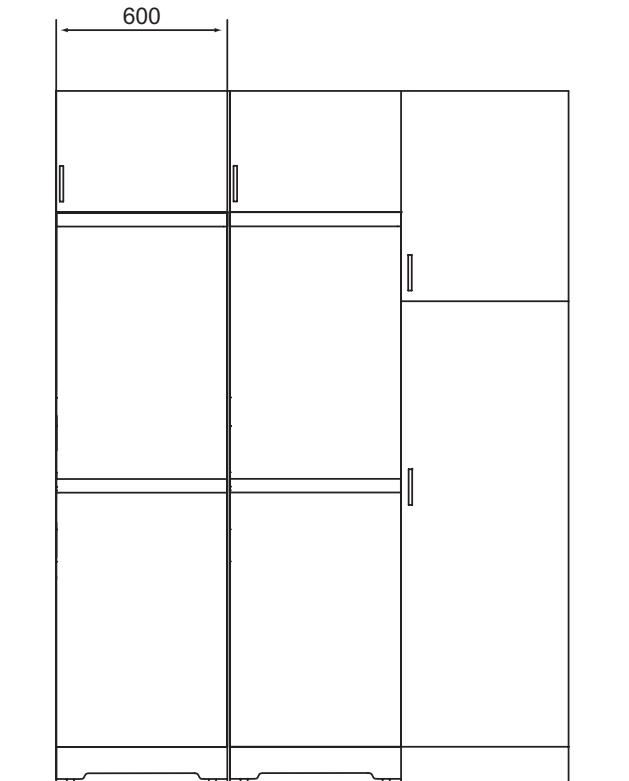

fig. 3

## Positioning

When positioning the cabinet next to an adjacent wall, ensure that there is sufficient space for the door(s) to open in order to pull any baskets out of the unit (fig. 4)

NOTE: Care must be taken when opening the door(s) against a wall so as not to damage the door(s) or handle(s).

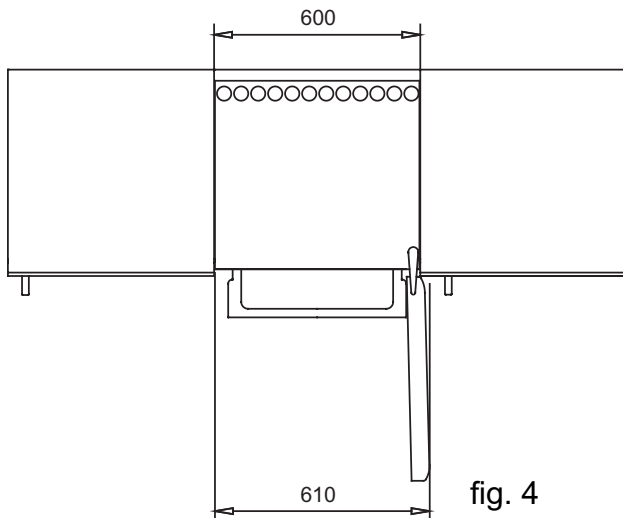

fig. 4

## Fitting of angle brace for fixing

In order to prevent the unit from tilting forward when the door is opened, an angle brace can be fitted. Fit the brace on the wall behind the cabinet 80-100 mm from the left or right side of the cabinet depending on which side the door is hinged. The angle brace must always be fitted on the opposite side of the door (5).

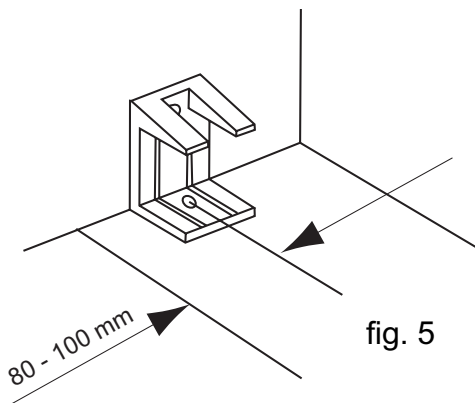

fig. 5

## Ventilation

It is important that the appliance is completely level and that there is adequate air circulation over, under and around it. The dimensions give the actual size of the opening (fig. 6-7).

When positioning the appliances side by side, a distance of 5 cm is required between the appliances to allow sufficient air flow. For this reason it is also necessary to allow 10-15 cm space above the appliance or ensure that an air duct will allow warm air to escape around cupboards above.

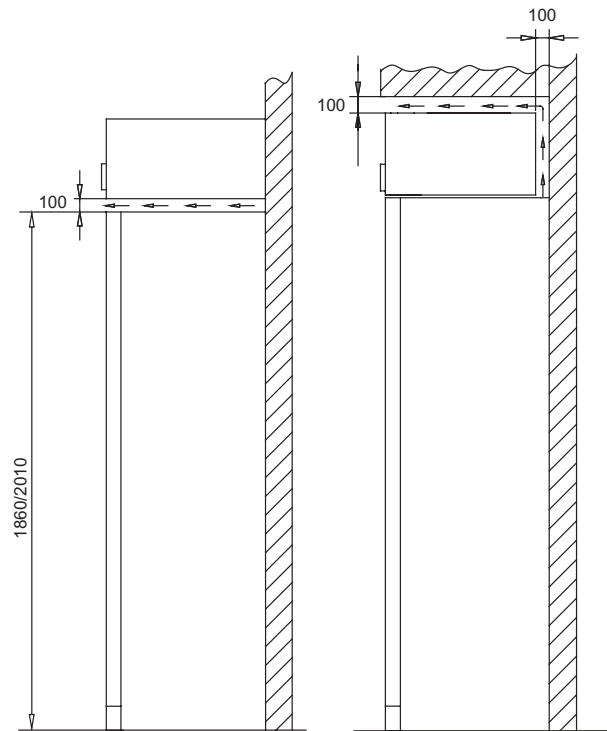

fig. 6

fig. 7

## Warning:

To avoid a hazard due to instability of the appliance, it must be fixed in accordance with the instructions:

Keep ventilation openings, in the appliance enclosure or in the built-in structure, clear of obstruction.

## Levelling

It is very important that the cabinet is absolutely level. Cabinets which are not level will become damaged over time. Any unevenness of the floor should be corrected prior to installation. Slight unevenness can be overcome by adjusting the two feet fitted to the front edge of the cabinet base panel.

To adjust the feet, first remove the kick plate by lifting and pulling the kick plate at a 45° angle towards yourself (fig. 8). Then adjust the feet as required using the tool provided (fig. 8-9)

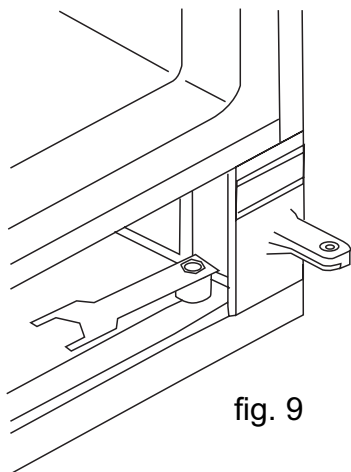
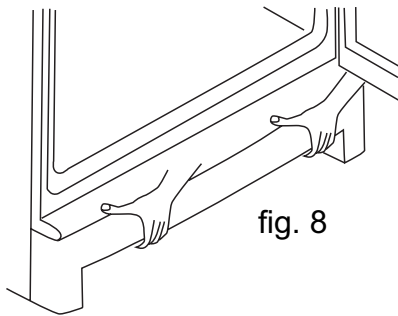

# Reversing the doors

The doors can be changed from right-hinged to left-hinged or vice versa in the following way:

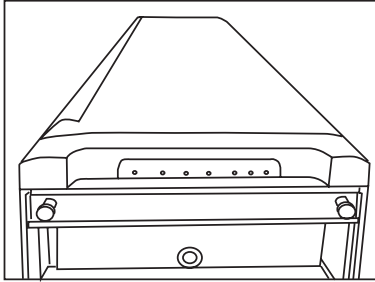

1. Lay the cabinet on its back with door(s) uppermost

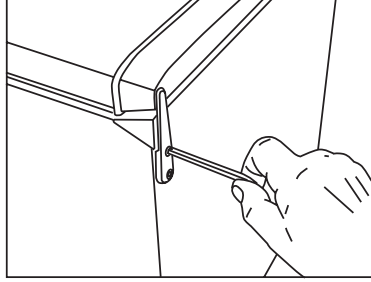

2. Remove the upper hinge  
3. Move the plastic plugs where the upper hinge was fitted.  
4. Lift off the upper door

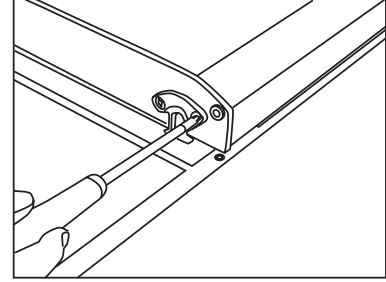

5. Remove the door-closer. Refit the door-closer on the opposite side.

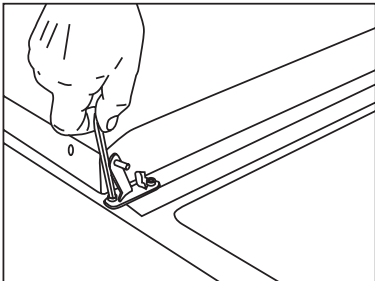

6. Remove the middle hinge.  
7. Lift off the lower door.

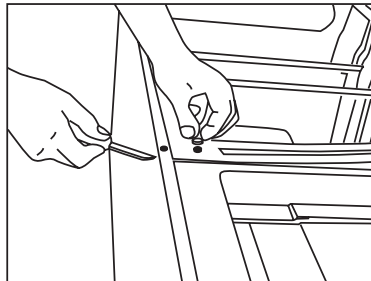

8. Opposite the hinge, there are two screws by plastic caps. Remove the caps and screws.

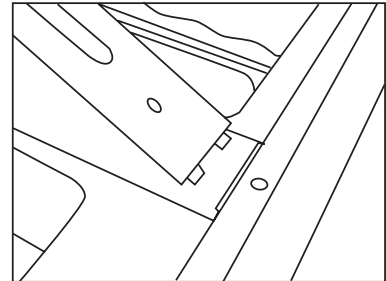

9. Turn over the central bridge plate and insert the pins into the slots on the opposite side.  
10. Refit the screws and plastic caps.

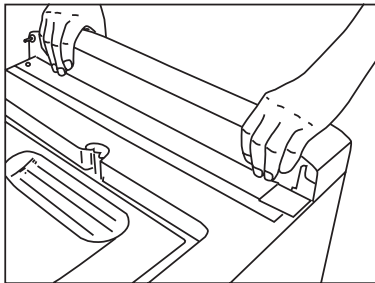

11. Remove the kick plate panel

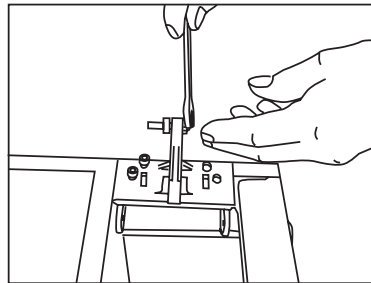

12. Remove the screws holding the lower hinge in place. Turn the pin which the door was mounted so that it points in the opposite direction. Rotate the hinge 180° and refit on the opposite side of the cabinet.

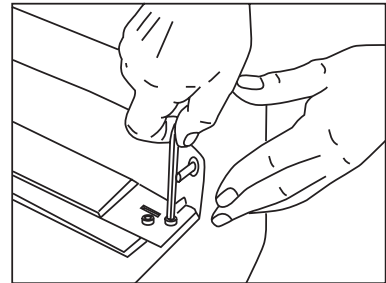

13. Refit the kick plate.  
14. Adjust the hinge and tighten.

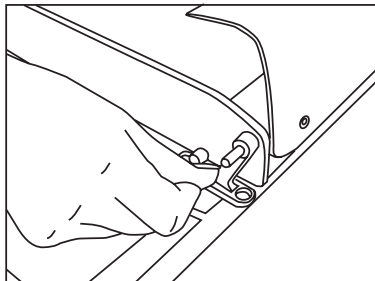

15. Fit the lower door and attach the middle hinge.  
16. Adjust the hinge and tighten.

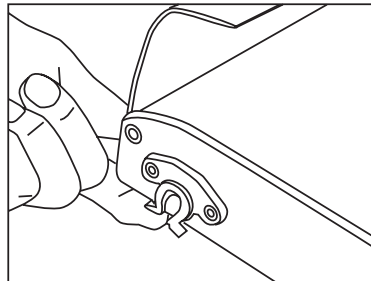

17. Fit the upper door  
18. Keep the door-closer to the left.  
19. Fit the upper hinge

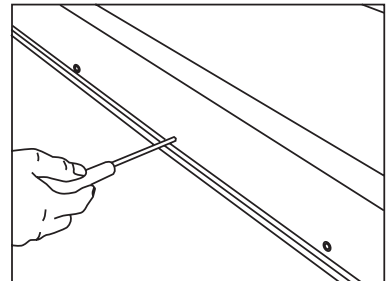

20. Remove the door handles and refit them on the opposite side. Refit the caps.  
21. The cabinet must be allowed to stabilise in an upright position for 1.5 hours before being switched on.

## Electrical connection

The cabinet is intended for connection to alternating current. The required voltage (V) and frequency (Hz) are stated on the rating plate, located inside the cabinet.

Power must be connected via a wall socket with a switch. The wall socket should be easily accessible.

All earthing requirements stipulated by local electricity authorities must be observed. The cabinet plug and wall socket should then provide correct earthing. If in doubt, contact your supplier or authorized electrician.

### Warning

**This appliance must be earthed.**

The flexible cord fitted to the appliance has three wires for use with a 3-pin 13-Amp. If a BS 1363 (13 Amp) fused plug is used, it should be fitted with a 13 Amp fuse.

### Important

The wires in the power cord are coloured in accordance with the following code:  
 GREEN-AND-YELLOW: EARTH  
 BLUE: NEUTRAL  
 BROWN: LIVE

The wire colours used in the power cord of this appliance may not correspond with the colour markings identifying the terminals in your plug.

### Proceed as follows:

Connect the GREEN-AND-YELLOW wire to the plug terminal marked by “E” or an earth symbol, or coloured GREEN or GREEN-AND-YELLOW. Connect the BLUE wire to the plug terminal marked “N” or coloured BLACK.

Connect the BROWN wire to the plug terminal marked “L” or coloured RED.

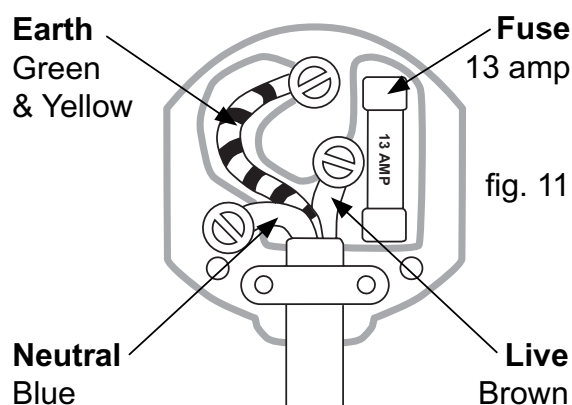

**In case of damage to the power cord it must be replaced by a power cord of corresponding type, available from the manufacturer or the service representative.**

### Technical data

The appliance concerned complies with CE marking regulation, Directives and standards.

Low Voltage Directive 73/23/EEC  
 Electromagnetic Compatibility Directive 89/336/EEC.

European Directive on Energy labelling 92/75 with subsequent modification 94/2 and 2003/66

European Directive on Energy efficiency 96/57 and subsequent modification.



# Control panel

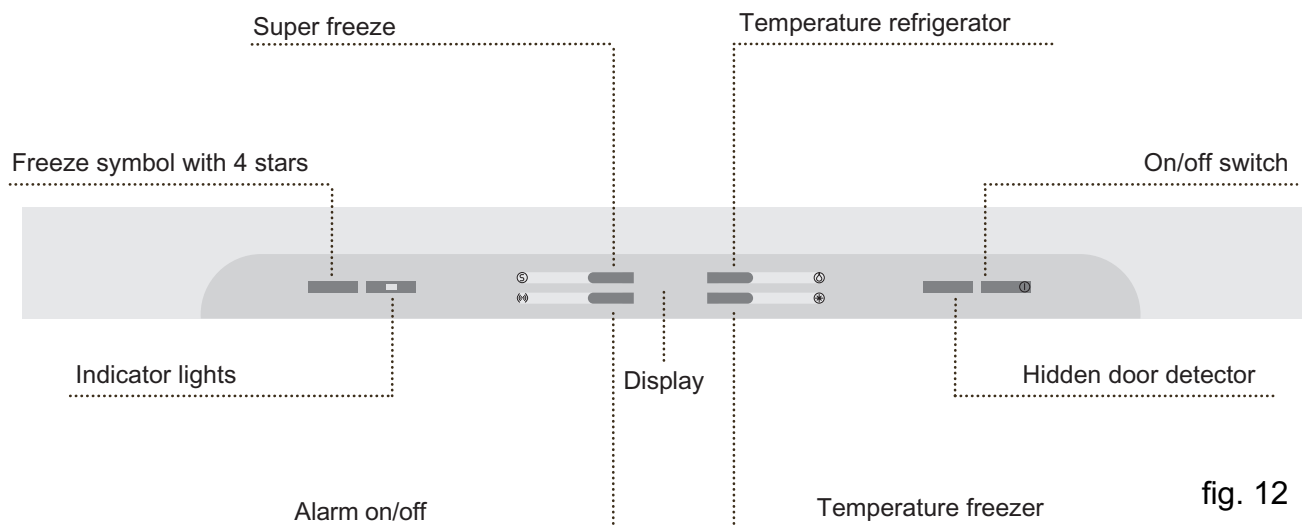

fig. 12

## Setting the controls

The appliance is factory-set to maintain +5 °C in the refrigerator section and -18 °C in the freezer section. Following power failure, these settings are automatically reset.

After switching the appliance on, it takes a few hours before the correct temperature is achieved. During this period the control lamp flashes red and the acoustic alarm is heard. It is therefore a good idea to switch off the sound. To do so, press the alarm button (🔊).

The controls have the following functions:

- Power on/off
- Temperature regulation
- Temperature display
- Automatic defrost (only frost free appliances)
- Quick freeze
- Acoustic and visual alarms
- Fault-finding, emergency and service programs.

- On/off switch
- Button for display and setting the temperature of the refrigerator.
- Button for display and setting the temperature of the freezer.
- Display showing the temperature settings.
- Button for switching off the alarm
- Quick freeze button - Super Freeze



## Switching the cabinet on

Connect the appliance to the power socket. Press the on/off switch ①.

The actual temperature in the freezer section is shown on the display.

To display the actual temperature in the refrigerator section, press the refrigerator button ②. After 1 minute, the display returns to the temperature in the freezer section. Alternatively, the temperature in the freezer section can be selected by pressing the freezer button ③.

## Temperature regulation

A temperature of between +2 °C and +9 °C can be selected for the refrigerator section by pressing the button for setting refrigerator section temperature ④. The display shows the temperature setting. Press the button until the desired temperature is displayed.

A temperature of between -24 °C and -16 °C can be selected for the freezer section by pressing the button for setting freezer section temperature ⑤. The display shows the temperature setting. Press the button until the desired temperature is displayed.

Note that the temperature in the freezer section should be lower than 18 °C in order to prevent micro-organisms from multiplying.

A temperature setting of 4 °C is recommended for the refrigerator section.

## Super Freeze

Before freezing large quantities of fresh food, it is recommended that the Super Freeze function be activated.

To do so, press the Super Freeze button ⑥. A yellow indicator light indicates that the Super Freeze function is switched on.

Super Freeze is used for freezing large quantities of fresh food and should be switched on up to 24 hours before the fresh food is placed in the freezer compartment.

When Super Freeze has been switched on, the freezer motor (compressor) runs constantly and the freezer compartment drops to a very low temperature.

Super freeze automatically switches off after 24 hours.

## Open door alarms

If the door has been open for longer than two minutes, the acoustic alarm is activated and the indicator light flashes red. Both alarms are reset when the door is closed. On pressing the alarm button, only the acoustic alarm is switched off.

## Freezer high-temperature alarm

Visual and acoustic alarms are activated if the freezer temperature has been higher than -10 °C for more than 90 minutes. If the temperature drops again, the visual and acoustic alarms remain active and the display continues to show the highest temperature recorded in the freezer. This also occurs during power failure in order to ascertain whether food could have defrosted.

# Refrigerator Section

## Glass shelves

The safety glass shelves can be moved when the door is opened 90°. To move a shelf, pull it forward and lower it. It can then be removed and replaced in the desired position. From the top and downwards, the shelves are suitable for storing bakery products, ready-made meals, dairy products, meat products and sliced meat.

## Serving boxes in the door

The storage boxes in the door can be removed and placed on one of the glass shelves. The boxes are removed by lifting. The tight-fitting box lids prevent the products stored in them from drying out and saves the need for further packaging. The boxes are ideal for storing items such as butter and cheese.



fig. 13

## Bottle shelf

The bottle shelf is ideal for both large and small bottles.

## Crisper bins

The crisper bins are ideal for storing fruit and vegetables. The shelf above the bins functions as a lid, maintaining humidity and preventing the items stored in the bins from drying out.

## Glass shelf with slide damper

The slide damper above the crisper bin allows the temperature and the humidity in the bins to be regulated.

- Opening the slide damper reduces the temperature and humidity.
- Closing the slide damper increases the temperature and humidity.



fig. 14

## Shelves in the door

The shelves in the door are positioned with the mega-shelf at the bottom, flexi-shelves in the middle and the box shelf at the top. They provide ample space for storing large and small bottles, cartons, jars and tubs. The flexi-shelf and box shelf can be repositioned if desired.



fig. 15



## Freezer Section

The freezer section is a four-star freezer, approved for freezing and storing foodstuffs.

### Freezing

To keep food at its best it should be frozen down to -18 °C in the shortest time possible.

To obtain the most efficient freezing, press the Super Freeze switch in advance. If you want to freeze more than 3 kg, the Super Freeze button should be pressed about 10 hours in advance. With small amounts, it is enough to do it a couple of hours in advance or while you are putting the goods in the freezer.

You don't need to use the freezing button when you put pre-frozen goods in the freezer, or with single small packs.

The indicator light flashes yellow when Super Freeze is in operation. After 24 hours, when freezing is complete, the yellow indicator light will stop flashing and the freezer will switch back to normal operating mode.

Only freeze good quality produce - freezing preserves the quality but cannot improve it.

Clean and prepare all items of food and pack them in freezer bags, foil, waxed containers, or similar. Keep the size of the packages small and remember that square packs utilise freezer space more efficiently. Place each package in as much contact with the shelves of the freezer as possible and avoid placing unfrozen food in contact with food that is already frozen.

### Note

**Do not put carbonated liquids (fizzy drinks) in the freezer as they may explode when frozen.**

**If water ices are consumed immediately after removal from the freezer, freezer burn could result due to the low temperature. Always allow to warm slightly before consumption.**

### Thawing Frozen Food

When thawing food that was frozen when fresh, the food will retain its quality better if thawed slowly. Slow thawing allows the food to re-absorb all the flavour and nutritional value which may be lost with rapid thawing. By far the best method to thaw fresh food is to allow the temperature to rise slowly by placing the food on a plate in the fridge section or at room temperature until completely thawed.

Commercially frozen pre-packed food should be thawed in accordance with the manufacturers instructions. Some small items of food may be cooked from frozen, but will require a longer cooking time. For thawing food in a microwave oven, refer to the manufacturers instructions.

## Defrosting

### Automatic defrost of the fridge section

Defrosting is carried out automatically every time the compressor stops. The defrost water drains from the cabinet onto a tray placed on the top of the compressor where it evaporates.

You may see a small build-up of ice or water droplets on the back wall of the fridge, but this indicates perfectly normal operation.

### Automatic defrosting the freezer section

Defrosting is fully automatic and is controlled in appliances using frost-free technology.

### Save energy

- Cool hot food and drink before placing them in the refrigerator
- Place frozen items in the refrigerator to defrost.
- Keep the door closed as much as possible.
- Ensure there are no obstructions preventing the door from closing properly.

## Cleaning

Switch the appliance off when cleaning the inside of the cabinet.

The cabinet is best cleaned with a weak soap solution (max. 85°C) Never use cleaning agents that might cause scratches or leave an odour which may contaminate the food.

Clean the gasket around the door regularly to prevent discolouration and prolong its life. Clean with clear water only. Thoroughly rub it dry.

Remove dust and threads from the compressor compartment with a vacuum cleaner. The front kick plate can be removed to enable cleaning under the appliance.

### Blocked defrost/melt water drain

If blockage does occur, the most likely point is the plastic bend at the outlet inside the cabinet. Carefully remove the blockage then for safety's sake clean the bend with a pipe cleaner or similar.

If the problem persists, the blockage might be in the tube down to the evaporator tray. The tray is located above the compressor

**The cabinet is to remain unused for a time:** After the refrigerator has been defrosted and cleaned, leave the door slightly ajar. This will prevent bad smells.

### Warning:

Do not use electrical appliances inside the food storage compartments of the appliance.



## Fault finding list

Fault	Possible cause	Remedy
No control lamps are lit	The appliance is switched off Power failure; the fuse is "off"; the appliance is not plugged in correctly.	Press the on/off switch  Check that power is connected. The fuse must be reset
Water collects on the glass shelves	Items of food at the back of the shelves are in contact with the evaporator at the rear of the interior of the cabinet, thus causing condensation to run onto the shelf.	Move the rearmost items forwards
Water collects in the bottom of the refrigerator/freezer	The defrost water pipe is blocked.	Clean the defrost water channel and the drain hole on the rear wall of the cabinet.
Vibration or bothersome noise	The appliance is not level.  The appliance is resting against other kitchen elements.  Bins, boxes or shelves are not positioned correctly or are jammed.  Containers or bottles inside the cabinet are rattling against one another.	Level the appliance using a spirit level.  Move the appliance away from the kitchen elements or appliances it is in contact with.  Check movable fittings and adjust them as required.  Move containers and bottles apart
The compressor runs conti- nously	Temperature setting too low	Adjust temperature to a higher setting. Ambient temperature too high. Reduce if possible (open the window etc)
Temperature in freezer too high	Temperature regulation  The amount of fresh food placed in the freezer is greater than the capacity of the appliance	Set a lower temperature  Wait a few hours and then recheck the temperature
Temperature in refrigerator too high	Temperature regulation  Many items have been placed in the refrigerator at the same time  The refrigerator door is opened too often	Set a lower temperature  Distribute items within the cabinet to improve air circulation  Keep door closed

# Useful hints

## Sensor faults

If a sensor fault is detected, a flashing E followed by a number will be shown on the display. The indicator light flashes red, green and yellow alternately and an acoustic alarm is activated.

If this happens, call for service. An integrated emergency program will attempt to maintain an acceptable temperature until the fault is rectified.

## Replacing the light bulb

Switch the appliance off by pressing the on/off switch and disconnect the power by pulling the plug out of the socket. Remove the lamp cover using a small flat-headed screwdriver. Replace the PL tube (11 W). Refit the lamp cover, reconnect the power supply and start the appliance by pressing the on/off switch.

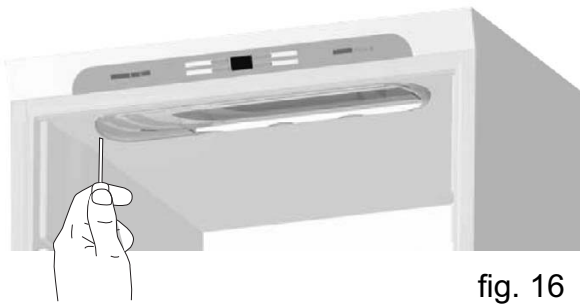

fig. 16

## Unfamiliar sounds

Can be caused by tubes in the appliance contacting each other or the outer cladding. Check to make sure the refrigerator is standing level.

## Liquid noise

Caused by circulating refrigerant. This is quite normal, even when the compressor is not running.

## Door sticking:

Opening and closing the door creates a small vacuum in the cabinet. If you need to open and close the door repeatedly within a short period, lay something between the door sealing strip and cabinet front edge to create an air gap. Remember to remove and close the door as quickly as possible.

## Blocked defrost/melt water drain

If blockage does occur, the most likely point is the plastic bend at the outlet inside the cabinet. Carefully remove the blockage then clean the bend with a pip cleaner or similar. If the problem persists, the blockage might be in the tube down to the evaporation tray. The tray is located above the compressor

## Spare parts

When ordering spare parts, please give the production number and serial number. This information is given on the rating plate.

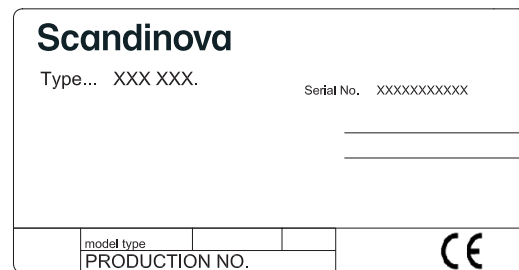

fig. 17

Subject to modification