

Dedicated to Delivery

Nasco's Ready-or-Not Tot® Basic Instruction Manual



Parenting is Forever...

Having a baby and being a parent is a wonderful thing. We do not discourage that. The issue is at what point in your life do you want to become a parent? How would having a baby now affect your short and long term goals? How does becoming a teen parent alter your opportunities for furthering your education and fulfilling your career dreams? What about your social and emotional life? Would the time commitment involved in caring for a child change your growth and development as a person and affect your friendships? Do you want to be connected to your current partner for the rest of your life? What does it cost to care for a child during the first year? For 18 years? How would you support a child? A parenting simulation raises all these questions and more.

No matter what the educational philosophy of your program (abstinence only or educating teens to prepare for safe sex), the Nasco teen pregnancy simulators will be of great assistance. These hands-on tools help teens experience the frustration and appreciate the patience required when caring for an infant. Whatever your budget, we offer a full range of simulators to help bring your program to life.

INSTRUCTION MANUAL

Basic Ready-or-Not Tot®

Used to Teach Many Parenting Concepts:

- How to quiet and comfort a real baby.
 - How a baby should be held and diapered
 - A baby's needs can be costly.
 - What it takes to be a good parent.
 - Babies cry for many reasons.
 - Babies require constant care and attention.
 - A baby means lifestyle changes that can cause loneliness, isolation, and affect friendships and family relations.
 - Day care and babysitting are a normal part of parenting, but not always available or affordable.
-

INTRODUCTION

Parenting is work! It requires a great deal of time and energy. The demands of caring for a baby keep a parent on duty 24 hours a day, seven days a week. Though the responsibilities of parenting are great, there are many rewards as well. The Ready-or-Not Tot® Manikin is the first interactive parenting manikin to simulate both the negative and positive aspects of caring for a baby!

Basic Ready-or-Not Tot® teaches students how demanding babies can be throughout the day and night. The manikin cries at random intervals, requiring action from the student parent in order to quiet the manikin.

This “baby” is an excellent replacement for the “egg baby,” “flour sack baby,” and the “plant baby,” since it requires action during the middle of the night. Simpler to use than the full-featured manikins, Basic Ready-or-Not Tot® provides an easy method to give students the opportunity to experience the ongoing demands of parenting.

Basic Ready-or-Not Tot® is also a great way to teach proper baby handling and care. The manikin is 20" long and has newborn features. Students can practice diapering, dressing, and holding a baby. It is important that you thoroughly understand this instruction book before presenting Ready-or-Not Tot® to your students. We recommend that the instructor practice with the manikin to become familiar with its operations.

NOTE: The Ready-or-Not Tot® is an educational tool and not a toy. It is intended for use by children over 12 years of age.



OPERATING INSTRUCTIONS

Batteries

The control box is powered by three "AA" alkaline batteries. **Be careful when replacing the batteries to avoid damage to the control box.** To insert the batteries, remove the control box from the manikin (Figure 1). With the control box removed, find the battery compartment door located on the back of the control box. Use a small screwdriver to remove the back (Figure 2). Install batteries, making sure the batteries are positioned correctly. Replace battery door (Figure 3) and reinsert control box into the manikin. **When inserting the control box into the cavity in the back of the manikin, position the box so it touches the bottom of the cavity** (Figure 4) — this will make it easier to remove the box from the top when necessary. If the unit is not going to be used for several days, the batteries should be removed. Store the Ready-or-Not Tot® without the batteries inserted.

Turning the Manikin On

Once the batteries have been installed, the manikin can be turned on. The on/off switch is hidden so students cannot turn the manikin off. **Do not** show students the location of the on/off switch. The hidden switch is designed to prevent students from shutting down the unit instead of completing the project.

To turn the manikin on, press the spot on the box marked "Nasco" and hold for two seconds (Figure 5). The power light will blink red and the manikin will cry. You will need to press the "quiet" button to stop the crying. The manikin will cry again 10 minutes later and you will need to press the "Quiet" button. To turn off, simply press the "Nasco" spot and hold for two to three seconds. When the power light is blinking, the manikin is set and will cry for the first time in each 10-minute tending period at approximately the following times:

Cry 1: 70 minutes (first cry after manikin is turned on)

Cry 2: 230 minutes

Cry 3: 90 minutes

Cry 4: 140 minutes

The schedule then repeats at 230-minute, 90-minute, and 140-minute intervals. There can be some flexibility in this schedule depending on when the student responds to the cry. Remember, the first cry will happen before you give the manikin to the student. The first time it cries for the student will be 10 minutes from when you turn it on and it will only have that one cry in the first tending period.



Figure 1

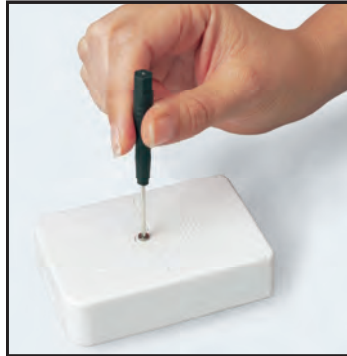

Figure 2



Figure 3



Figure 4



Figure 5

Before Giving the Manikin to Student

Insert fresh or fully charged batteries in the control box. **NOTE:** Even rechargeable batteries lose their ability to hold a charge after awhile. **It is strongly recommended that high quality alkaline batteries (or fully charged batteries, if using rechargeable batteries) are placed in the unit at the beginning of every session.** The battery life is dependent on how long the baby cries during each session. This depends on the student's attentiveness during the session. If a student puts the baby in another room and doesn't hear it cry for a period of time, the strength of the battery is depleted, thus potentially ending the session.

Right before assigning the manikin to a student, turn the control box on and insert it in the body of the manikin (see page 2 for complete instructions on how to turn the manikin on). Give the manikin to the student and remind them to press the "Quiet" button when it cries and needs tending.

Special Suggestion: When using the manikin within the school day setting, be sure to inform other faculty members about the Ready-or-Not Tot® before assigning it to students. Other faculty members will be more cooperative if they are aware of the reasons for this educational activity, as well as the manikin's operations. These faculty members can be an important ally to the success of this activity!

Tending to the Manikin

When the manikin begins to cry, the student should press the "Quiet" button. The manikin will immediately stop crying. After a 10-minute tending period, the manikin will start crying again. Pressing the "Quiet" button will again stop the crying and put the manikin back to sleep. The next cry will occur per the approximate scheduled times listed on page 2.

Cleaning the Manikin

Ready-or-Not Tot® is made of vinyl, which can be absorbent. It should not be set on printed materials of any kind (newspapers, magazines, etc.), as the inks can permanently stain the manikin.

To keep the manikin as clean as possible, we recommend that it remain dressed at all times. Newborn-size baby clothes and diapers will fit the manikin. Nasco does offer appropriate clothing and specialized diapers for Ready-or-Not Tot® in the Family & Consumer Sciences catalog and on their website at eNasco.com/fcs.

To clean most smudges, wash with a damp, soapy washcloth and rinse. **DO NOT IMMERSE THE MANIKIN IN WATER!** When cleaning the manikin, be careful not to expose the control box to water. Always remove the control box from the manikin before cleaning. For stubborn stains, Nasco Cleaner (LF09919H) is recommended.

Warranty Information

Ready-or-Not Tot® comes with a 12-month limited warranty. This product is warranted to be free from any defect in materials and/or workmanship for a period of 12 months from the date of original purchase. This limited warranty covers the ability of this product to function according to generally accepted training requirements in effect at the time of original purchase. This product will be repaired or replaced free of charge if it fails in normal use during the term of this limited warranty. This limited warranty does not include accessories, stains, cosmetic appearance, or normal replacement of disposable items. This limited warranty does not insure the physical appearance of your product, and is void due to unauthorized design modifications, improper usage, accident, or abuse. To receive warranty service on your manikin, contact your Ready-or-Not Tot® distributor for additional information and return authorization.

Ready-or-Not Tot®

Parental Consent Form

Dear Parent(s)/Guardian(s):

In order to provide students with a realistic idea of the demands of parenting, your child, _____, will be participating in a parenting simulation project as part of our _____ class. This project involves caring for our lifelike, electronic, parenting manikin for a period of _____ day(s). The manikin cries periodically throughout the day and night. Your child will be responsible for providing proper care as if this were a real baby. The manikin should be with them at all times, except in emergency situations, when a reliable babysitter can be utilized.

In order for this to be a positive learning experience for your child, we ask your support in helping to monitor student participation while they are at home. Your insistence that they alone care for their manikin will help to impress upon them the tremendous demands that a baby places on a parent's time, energy, and social life.

The Ready-or-Not Tot® is an educational tool and not a toy. It is intended for use by children over 12 years of age.

We are fortunate to have been able to purchase these interactive parenting manikins. With proper care, they should last many years. Your child will be responsible for any damage that occurs as a result of abusive handling or for the loss of the manikin.

Thank you for your support during this valuable parenting simulation project. Please sign the permission slip below and have your child return it to their teacher by ____/____/____. Please contact _____ by phone (____-____-____) or e-mail (_____) if you have any questions or concerns.



Ready-or-Not Tot® Permission Slip

I give my child, _____, permission to participate in the interactive parenting simulation using the Ready-or-Not Tot®. I understand that my child is financially responsible for any damage due to abusive handling or for the loss of the educational simulator.

Parent/Guardian Signature

Date

Please Print Name Above

EXAMPLE: Student Response Sheet

Encourage students to indicate full hours on chart and record minutes between tending periods. Intervals continue to repeat at approximately 225, 90, and 140 minutes. In the example below, **red** indicates student entries.

Turn manikin on at 9:50 am. First cry for student will be at 10:00 am. Record hours at top and minutes at bottom.

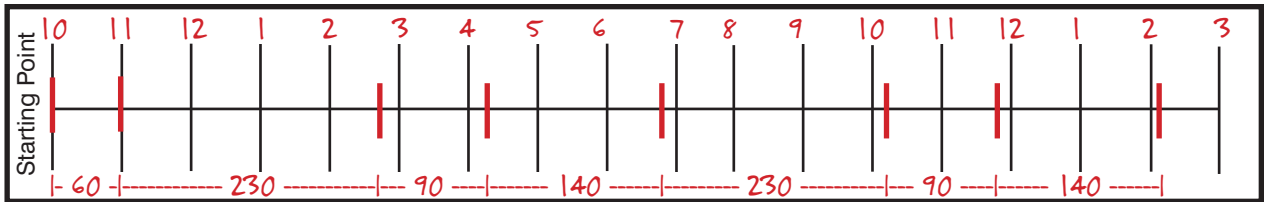

Name _____

STUDENT RESPONSE SHEET

Starting Point												

Starting Point												

Starting Point												

INSTRUCTIONS FOR RESPONDING TO BASIC READY-OR-NOT TOT®

Ready-or-Not Tot® requires tending and will cry at various intervals. When the manikin cries, press the “Quiet” button on the control box. The manikin will cry again in 10 minutes to simulate a short “tending” or care time. Push the “Quiet” button again and the manikin will go to sleep.

To graph your time on the chart above, list the time that the manikin was turned on at the line marked “Starting Point.” Then, chart the first cry in each tending cycle and write the time when the “Quiet” button was pushed. Each line equals one hour. Do not mark chart at the end of the tending cycle.

Nasco
Dedicated to Delivery

901 Janesville Avenue
P.O. Box 901
Fort Atkinson, WI 53538-0901
1-800-558-9595

eNasco.com
E-mail: info@eNasco.com

Basic Ready-or-Not Tot®

WA32125H White

WA32124H Black



COPYRIGHT © NASCO 2014
NP068-97_Basic/RV 1-14