

32

ACCESSORIES

ACCESSORIES

Recommended accessories for use with your tool are available from your local dealer. If you need assistance regarding accessories, please contact manufacturer at 1-877-571-2391.

⚠ WARNING

The use of any accessory not recommended for use with this appliance could be hazardous.

SPECIFICATIONS

SPECIFICATIONS

Boost Ampere	12 V DC, 700 A instantaneous, On: 5 seconds, 350 A Off: 1 minute
Peak Amperage	1400 A
Battery Type	Maintenance-free, sealed lead acid, 12 V DC, 21 aH
Area Light	1 long-life white LED
USB Port	3.1 A max., 5 V DC
Compressor Maximum Pressure	120 PSI
12 V DC Adaptor	12 V DC

011-1913-6



Booster Pack with Air Compressor



O W N E R ' S M A N U A L

Owner's Manual



MODEL 11-1913-6
Booster Pack
with Air Compressor



2 TABLE OF CONTENTS

INTRODUCTION	3
SAFETY INFORMATION	4
General Safety Warnings and Instructions	4
FIRST AID	9
PREPARING FOR USE	10
Controls & Features	12
Charging with an AC Source	14
Charging with a DC Source	14
COMMON ACTIONS AND UNIT RESPONSES	15
JUMP-STARTING YOUR VEHICLE	17
Negative Grounded Battery	17
Positive Grounded Battery	19
CHARGING A USB DEVICE	22
EMERGENCY AREA LIGHT	24
USING THE COMPRESSOR	25
TROUBLESHOOTING	29
MAINTENANCE AND CARE	30
LIMITED WARRANTY	31
ACCESSORIES	32
SPECIFICATIONS	32

SAVE THESE INSTRUCTIONS.

This manual contains important safety and operating instructions. Read all instructions and follow them with use of this product.

Questions? Call Customer Service at 1-877-571-2391 for model Model 11-1913-6.

INTRODUCTION

The Booster Pack with Air Compressor is a compact, durable, portable jump-start system for vehicles that have a standard 12 V battery system. This self-contained, rechargeable system will start most vehicles without the need for a host vehicle or a 12 V DC power supply. The built-in 12 V DC compressor is the ultimate compressor for all vehicle tires, trailer tires and recreational inflatables.

The purpose of this Owner's Manual is to provide explanations and procedures on operating, maintaining and troubleshooting the product to enable you to fully utilize the functions and features it provides, safely and effectively.

Important

- **This unit is delivered in a partially charged state – you must fully charge it upon purchase and before using it for the first time. Initial AC charge should be for 40 hours.**
- **This unit was designed for HOUSEHOLD USE ONLY.**

This Class B digital apparatus complies with Canadian ICES-003. CAN ICES-3(B)/NMB-3(B).

3

4 SAFETY INFORMATION

The following conventions are used in this guide:

⚠ WARNING

Warnings identify conditions that could result in damage to the product or to other equipment.

⚠ CAUTION

Cautions identify conditions or practices that could result in damage to the product or to other equipment.

Important

These notes describe an important action item or an item that you must pay attention to.

NOTE

These notes describe additional information which may add to your understanding of how to use the product.

GENERAL SAFETY WARNINGS AND INSTRUCTIONS

⚠ WARNING

General instructions pertaining to a risk of fire, electric shock, burst hazard, or injury to persons or property

- **Avoid dangerous environments.** Do not use appliances in damp or wet locations. Do not use appliances in the rain.
- **Keep children away.** All visitors should be kept at a distance from work area.
- **Dress properly.** Do not wear loose clothing or jewellery. They can be caught in moving parts. Rubber gloves and substantial, non-skid footwear are recommended when working outdoors. Wear protective hair covering to contain long hair.
- **Use safety glasses and other safety equipment.** Use safety goggles or safety glasses with side shields, complying with applicable safety standards. Safety glasses or the like are available at extra cost from your local dealer.
- **Store idle appliance indoors.** When not in use, appliances should be stored indoors in a dry, high, or locked-up place – out of reach of children.

SAFETY INFORMATION (cont'd)

- **Do not abuse cord.** Never carry appliance by cord or yank it to disconnect from receptacle. Keep cord from heat, oil, and sharp edges.
- **Disconnect appliances.** Disconnect the appliance from the power supply when not in use, before servicing, and when changing accessories.
- **Ground Fault Circuit Interrupter (GFCI)** protection should be provided on the circuits or outlets to be used. Receptacles with built in GFCI protection are available and may be used for this measure of safety.
- **Use of accessories and attachments.** The use of any accessory or attachment not recommended for use with this appliance could be hazardous. Refer to the accessory section of this manual for further details.
- **Stay alert.** Watch what you are doing. Use common sense. Do not operate appliance when you are tired.
- **Check for damaged parts.** A part that is damaged should be properly repaired or replaced by an authorized service centre before further use unless otherwise indicated elsewhere in this instruction manual. Have defective switches replaced by authorized service centre. Do not use tool if switch does not turn it on and off.
- **Do not operate this appliance near flammable liquids or in gaseous or explosive atmospheres.** Motors in these tools often spark and the sparks might ignite fumes.
- **Do not expose to extreme heat or flames.**
- **Never immerse the unit in water** or any other liquid, or use when wet.
- **NEVER ATTEMPT TO USE THE AC AND DC CHARGING METHODS AT THE SAME TIME.**
- **NEVER** connect this unit to a positive grounded vehicle using the 12 V DC Charging Adaptor.
- The 12 V DC Charging Adaptor must only be connected to batteries with a nominal output voltage of 12 volts. The unit will not operate from a 6 V battery and will sustain permanent damage if connected to a 24 V battery.

Specific Safety Instructions for Jump Starters

⚠ WARNING

Specific instructions pertaining to a risk of burst hazard or explosive gases

- **DO NOT** use the unit for charging dry-cell batteries that are commonly used with home appliances. These batteries may burst and cause injury to persons and damage property. Use the unit for charging/boosting a lead-acid battery only. It is not intended to supply power to a low-voltage electrical system other than in a starter-motor application.

6

SAFETY INFORMATION

SAFETY INFORMATION (cont'd)

- Use of an attachment not supplied, recommended or sold by manufacturer specifically for use with this unit may result in a risk of electrical shock and injury to persons.
- Working in the vicinity of a lead acid battery is dangerous. Batteries generate explosive gases during normal battery operation. For this reason, it is of the utmost importance that each time before using the jump-starter you read this manual and follow instructions exactly.
- To reduce the risk of battery explosion, follow these instructions and those published by the battery manufacturer and manufacturer of any equipment you intend to use in the vicinity of the battery. Review cautionary markings on these products and on the engine.
- This equipment employs parts (switches, relays, etc.) that produce arcs or sparks. Therefore, if used in a garage or enclosed area, the unit **MUST** be placed not less than 18 inches (45.5 cm) above the floor.
- **This unit is not for use by children and should only be operated by adults.**

⚠ CAUTION

To reduce the risk of injury or property damage

- **NEVER ATTEMPT TO JUMP-START OR CHARGE A FROZEN BATTERY.**
- Vehicles that have on-board computerized systems may be damaged if vehicle battery is jump-started. Before jump-starting, read the vehicle's owner's manual to confirm that external-starting assistance is suitable.
- Never smoke or allow a spark or flame in vicinity of vehicle battery, engine or power station.
- Stay clear of fan blades, belts, pulleys, and other parts that can cause injury to persons.
- Remove personal metal items such as rings, bracelets, necklaces and watches when working with a lead acid battery. A lead acid battery can produce a short circuit current high enough to weld a ring, or similar metal object, to skin, causing a severe burn.
- Do not wear vinyl clothing when jump-starting a vehicle. Friction can cause dangerous static-electrical sparks.
- Be extra careful to avoid dropping a metal tool onto the battery. It might spark or short-circuit the battery or another electrical part and could cause an explosion.
- Jump-start procedures should only be performed in a safe, dry, well-ventilated area.
- Always store battery clamps when not in use. Never touch battery clamps together. This can cause dangerous sparks, power arcing and/or explosion.

SAFETY INFORMATION (cont'd)

- When using this unit close to the vehicle's battery and engine, stand the unit on a flat, stable surface, and be sure to keep all clamps, cords, clothing and body parts away from moving vehicle parts.
- Never allow red and black clamps to touch each other or another common metal conductor — this could cause damage to the unit and/or create a sparking/explosion hazard.
- For negative-grounded systems, connect the positive (red) clamp to the positive ungrounded battery post and the negative (black) clamp to the vehicle chassis or engine block away from the battery. Do not connect the clamp to the carburetor, fuel lines or sheet-metal body parts. Connect to a heavy gauge metal part of the frame or engine block.
- For positive-grounded systems, connect the negative (black) clamp to the negative ungrounded battery post and the positive (red) clamp to the vehicle chassis or engine block away from the battery. Do not connect the clamp to the carburetor, fuel lines or sheet-metal body parts. Connect to a heavy gauge metal part of the frame or engine block.
- If the clamps are connected incorrectly with regard to polarity, the backlit LCD screen will display the Battery Status Icon, Battery Voltage Indicator, and the Clamp Icons. The Alarm Icon, the "+" and "-" signs and the Reverse Polarity Icons will flash and the unit will sound a continuous alarm until the clamps are disconnected. Disconnect the clamps and reconnect to battery with correct polarity.
- Always disconnect the negative (black) jumper cable first, followed by the positive (red) jumper cable, except for positive grounded systems.
- Do not expose battery to fire or intense heat since it may explode. Before disposing of the battery, protect exposed terminals with heavy-duty electrical tape to prevent shorting (shorting can result in injury or fire).
- Place this unit as far away from the battery as cables permit.
- Never allow battery acid to come in contact with this unit.
- Do not operate this unit in a closed area or restrict ventilation in any way.
- This system is designed to be used only on vehicles with a 12V DC battery system. Do not connect to a 6V or 24V battery system.
- This system is not designed to be used as a replacement for a vehicular battery. Do not attempt to operate a vehicle that does not have a battery installed.
- Excessive engine cranking can damage a vehicle's starter motor. If the engine fails to start after the recommended number of attempts, discontinue jump-start procedures and look for other problems that may need to be corrected.
- Do not use this jump starter on a watercraft. It is not qualified for marine applications.
- Although this unit contains a non-spillable battery, it is recommended that unit be kept upright during storage, use and recharging. To avoid possible

7

SAFETY INFORMATION

SAFETY INFORMATION (cont'd)

damage that may shorten the unit's working life, protect it from direct sunlight, direct heat and/or moisture.

- All ON/OFF switches should be in the OFF position when the unit is charging or not in use. Make sure all switches are in the OFF position before connecting to a power source or load.

Specific Safety Instructions for the USB Ports**⚠ CAUTION**

To reduce the risk of property damage

- **Do not insert foreign objects into the unit's USB outlets.**
- Do not attach USB hubs or more than one personal electronic device to each USB Port.
- Do not use this unit to operate appliances that require more than 3.1A (5V) to operate from each of the USB Ports.
- Some household USB-powered electronics will not operate with this unit.

Specific Safety Instructions for Compressors**⚠ WARNING**

Specific instructions regarding the risk of bursting

- **Bursting articles can cause serious injury.**
- Carefully follow instructions on articles to be inflated.
- Never exceed the recommended pressure listed in instructions on articles to be inflated. If no pressure is given, contact article manufacturer before inflating.
- Monitor the pressure at all times on the LCD screen.

⚠ CAUTION

To reduce the risk of injury or property damage

- Never leave the compressor unattended while in use.
- Do not operate compressor continuously for longer than approximately 10 minutes, depending on ambient temperatures, as it may overheat. This could damage the compressor. Follow the instructions in the "Portable Compressor" section.

FIRST AID**⚠ CAUTION**

To reduce the risk of injury

When working with lead acid batteries, always make sure immediate assistance is available in case of accident or emergency.

Always have protective eyewear when using this product: contact with battery acid may cause blindness and/or severe burns. Be aware of first aid procedures in case of accidental contact with battery acid.

Have plenty of fresh water and soap nearby in case battery acid contacts skin.

- **Skin:** If battery acid comes in contact with skin, rinse immediately with water, then wash thoroughly with soap and water. If redness, pain, or irritation occurs, seek immediate medical attention.
- **Eyes:** If battery acid comes in contact with eyes, flush eyes immediately, for a minimum of 15 minutes and seek immediate medical attention.
- **LCD liquid crystal display:** If liquid crystal comes in contact with your skin: Wash area off completely with plenty of water. Remove contaminated clothing. If liquid crystal gets into your eye: Flush the affected eye with clean water and then seek medical attention. If liquid crystal is swallowed: Flush your mouth thoroughly with water. Drink large quantities of water and induce vomiting. Then seek medical attention.

10 PREPARING FOR USE

Lead acid batteries require routine maintenance to ensure a full charge and long battery life. All batteries lose energy from self-discharge over time and more rapidly at higher temperatures. Therefore, batteries need periodic charging to replace energy lost through self-discharge. When the unit is not in frequent use, manufacturer recommends the battery be recharged at least every 30 days.

NOTE: Recharging battery after each use will prolong battery life; frequent heavy discharges between recharges and/or overcharging will reduce battery life. The battery can be recharged using the built-in 120 V AC charger.

NOTE: Make sure all other unit functions are turned off during recharging, as this can slow the recharging process.

Important

This unit is delivered in a partially charged state. Fully charge unit with a household extension cord (not supplied) for a full 40 hours before using for the first time. You cannot overcharge the unit using the AC charging method.

- To recharge this unit, use only the built-in AC charger.
- All On/Off switches should be in the Off position when the unit is charging or not in use. Make sure all switches are in the Off position before connection to a power source or load.

PREPARING FOR USE (cont'd)

⚠ WARNING

SHOCK HAZARD

- Outdoor use extension cords. When appliance is used outdoors, only use extension cords intended for outdoor use.
- Extension cords. Make sure your extension cord is in good condition. When using an extension cord, be sure to use one heavy enough to carry the current your product will draw. An undersized cord will cause a drop in line voltage resulting in loss of power and overheating. The following table shows the correct size to use depending on cord length and nameplate ampere rating. If in doubt, use the next heavier gauge. The smaller the gauge number, the heavier the cord.

Length	0-25' (0-7.6 m)	26'-50' (7.9-15.2 m)	51'-100' (15.5-30.4 m)	101'-150' (30.7-45.7 m)
American Wire Gauge (AWG)	18	16	16	14

- If an extension cord is used, make sure that:
 - the pins of extension cord are the same number, size and shape as those in the charger;
 - the extension cord is properly wired and in good electrical condition;
 - the wire size is large enough for the AC rating of the charger as indicated in the table above.
- DO NOT** operate unit with damaged cord or plug; or if the unit has received a sharp blow, been dropped, or otherwise damaged in any way. Do not disassemble the unit; take it to a qualified service technician when service or repair is required. Incorrect reassembly may result in a risk of electric shock or fire, and will void warranty.
- Use of an attachment not supplied, recommended or sold by manufacturer specifically for use with this unit may result in a risk of electric shock and injury to persons.
- NEVER** submerge this unit in water; **DO NOT** expose it to rain, snow or use when wet.
- To reduce risk of electric shock, disconnect the unit from any power source before attempting maintenance or cleaning. Turning off controls without disconnecting will not reduce this risk.

11 PREPARING FOR USE

12

PREPARING FOR USE

PREPARING FOR USE (cont'd)

Controls and Features

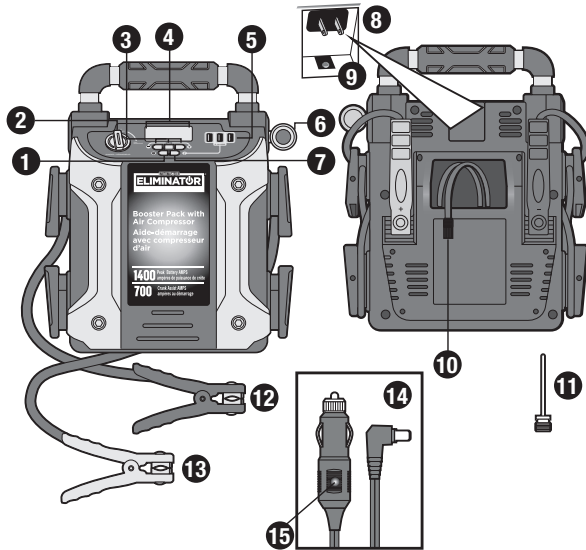

Feature	Description
1	Area Light Power Button
2	Jump-Starter Power Switch
3	Compressor Controls: Decrease Pressure Control (-), Power Button, and Increase Pressure Control (+)
4	Backlit LCD Screen (see details on the next page)
5	USB Ports (3)
6	Pivoting LED Emergency Light
7	USB Power Button

Feature	Description
8	Built-in 120 Volt AC Charger (under protective cover)
9	12 V DC Charging Port (under protective cover)
10	Air Hose and Sure Fit® Nozzle
11	Needle Adaptor
12	Positive (+) Red Clamp
13	Negative (-) Black Clamp
14	12 V DC Charging Adaptor
15	12 V DC Charging Adaptor LED Indicator

PREPARING FOR USE (cont'd)

13

PREPARING FOR USE

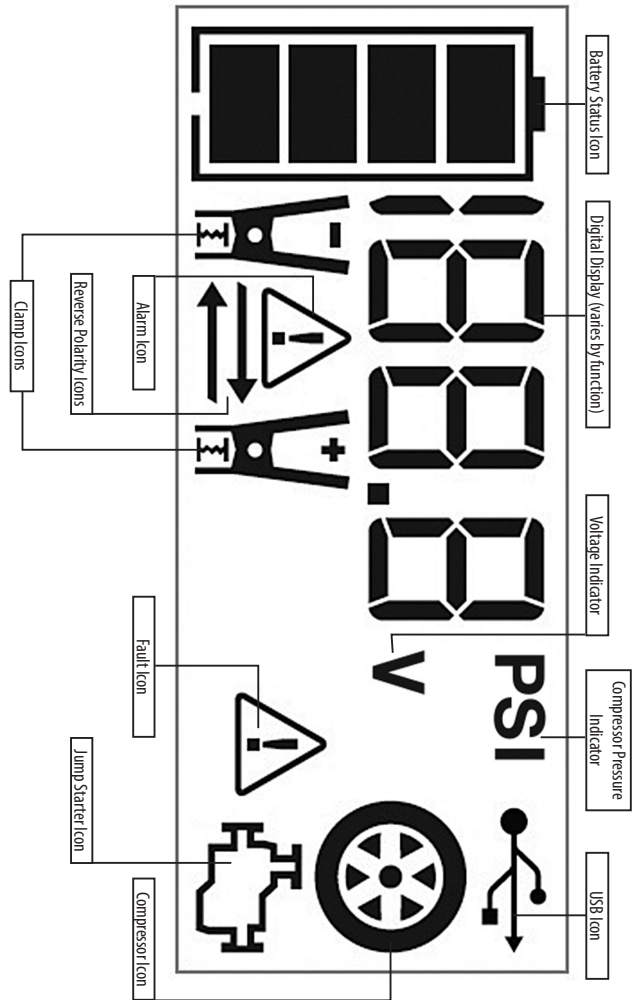

PREPARING FOR USE (cont'd)

Charging with an AC Source

- 1 Pull open the AC adaptor cover located on the back of the unit.
- 2 Connect an extension cord to the unit. (Extension cord not included.)
- 3 Plug the other end of the cord into a standard 120 V AC wall outlet. When the unit is properly connected to an AC power source, the LCD screen will display the following:

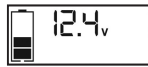

The bars on the Battery Status Icon represent the charge level of the unit's internal battery. The bars on the Battery Status Icon will change from empty to solid (bottom to top) repeatedly to indicate the unit is charging. The backlight will turn on for 10 seconds only.

- 4 Charge for approximately 40 hours or until the Battery Status Icon shows 4 solid bars.
- 5 When charging is complete, unplug the AC extension cord from the AC outlet and then disconnect it from the unit.

NOTE: The unit cannot be overcharged using this method.

Charging with a DC Source

- 1 Lift the protective cover of the Built-in 120 V AC Charger located on the back of the unit. Make sure the AC extension cord is disconnected from the 120 V AC Charger.
- 2 Insert the barrel tip of the 12 V DC Charging Adaptor into the 12 V DC Charging Port on the back of the unit.
- 3 Insert the grooved tip of the 12 V DC Charging Adaptor into the vehicle's 12 V DC accessory outlet or other functioning 12 V DC power source. The 12V DC Charging Adapter LED Indicator will light to indicate the unit is properly plugged into the 12V DC power source and is in charging.
- 4 Charge the unit until the Battery Status Icon shows 4 solid bars when either the Area Light, USB or Compressor Power Button is pressed (with the adapter unplugged from the unit).
- 5 When charging is complete, remove the DC Charging Adaptor from the unit and the 12 V DC power source when not in use and store in a safe place.

COMMON ACTIONS AND UNIT RESPONSES

Important

- The DC recharging method will NOT recharge the unit as effectively as recharging from 120 volt AC. Manufacturer suggests that you only use the 12 Volt DC Charging Adaptor if the unit needs to be charged immediately and no 120 volt power source is available.
- When using a vehicle's 12 V DC accessory outlet as a power source, be aware that some vehicles require the ignition be turned on to power the accessory outlet.
- The LCD screen will not activate when using the 12 volt DC charging method.

The following actions turn the unit on and activate the LCD screen:

Press the Area Light Power Button. (Refer to the "Emergency Area Light" section.)	A beep will sound and the Area Light will turn on. The backlight will turn on for 10 seconds only. The LCD screen will continue to display the Battery Status Icon and Battery Voltage Indicator. The unit remains on until the Area Light Power Button is pressed again to turn it off.
Press the USB Power Button. (Refer to the "Charging a USB Device" section.)	A beep will sound and the USB Ports will turn on. The backlight will turn on for 10 seconds only. The LCD screen will display the Battery Status Icon, Battery Voltage Indicator, and the USB Icon; indicating the three USB Ports are active. The unit remains on until the USB Power Button is pressed again to turn it off.
Press the Compressor Power Button. (Refer to the "Using the Compressor" section.)	A beep will sound and the backlit LCD screen will display the Battery Status Icon, "XXX" PSI and the Compressor Icon. If no further actions are taken after 1 minute, the unit will display the Battery Status Icon and Battery Voltage Indicator for 10 seconds before automatically turning off.
Whenever the clamps are properly connected to a battery (refer to the "Jump-Starting Your Vehicle" section) a beep will sound and the backlit LCD screen will display the Battery Status Icon, Battery Voltage Indicator, the Clamp Icons, and the "+" and "-" signs. The Jump Starter Icon will flash. The unit remains on until the clamps are disconnected from the battery.
If the Jump Starter Switch has been turned to the ON position and the clamps are not connected to a battery (refer to the "Jump-Starting Your Vehicle" section) a two-second warning will sound every 10 seconds. The backlit LCD screen will display the Battery Status Icon, Battery Voltage Indicator, the Clamp Icons, and the "+" and "-" signs. The Alarm Icon and the Jump Starter Icon will flash. The unit remains on until the Jump Starter Power Switch is switched off and then displays the battery status icon and the voltage of digital display for 10 seconds before automatic shut down.

COMMON ACTIONS AND UNIT RESPONSES (cont'd)

The following actions turn the unit on and activate the LCD screen:

If the clamp connections to the battery's positive and negative terminals are reversed (refer to the "Jump-Starting Your Vehicle" section) the backlit LCD screen will display the Battery Status Icon, Battery Voltage Indicator, and the Clamp Icons. The Alarm Icon, the "+" and "-" signs and the Reverse Polarity Icons will flash and the unit will sound a warning continuously until the clamps are disconnected from the battery.
If the red and black clamps touch each other (refer to the "Jump-Starting Your Vehicle" section) the backlit LCD screen will display the Battery Status Icon and Battery Voltage Indicator. The Clamp Icons, "+" and "-" signs and the Alarm Icon will flash. The unit will sound a two-second warning every ten seconds continuously until the clamps are separated.
When the unit is charging or recharging using the built-in 120 Volt AC Charger (refer to the "Preparing For Use" section) a beep will sound and the backlight will turn on for 10 seconds only. The LCD screen will continue to display the Battery Status Icon and Battery Voltage Indicator. The bars on the Battery Status Icon will change from empty to solid (bottom to top) repeatedly.

Viewing Battery Status

The Battery Status Icon and Battery Voltage Indicator indicate the battery charge level as follows:

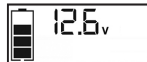

- If the battery charge level is at full capacity, four solid bars will display.
- If the battery is partially charged, two or three solid bars will display.
- If the battery is nearly empty, one solid bar will display. The unit should be charged at this time.
- If the battery is completely empty, four blank bars will display. The unit MUST be charged at this time or the unit's built-in low voltage protection will activate. The empty Battery Status Icon will flash for a short period of time before automatic shut down. The unit will not operate until the battery is recharged.

JUMP-STARTING YOUR VEHICLE

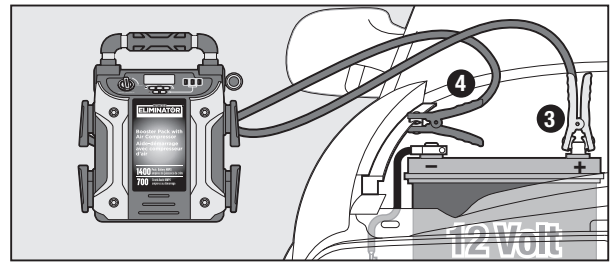
Negative Grounded Battery

- 1 Turn off vehicle ignition and all accessories (radio, A/C, lights, connected cell phone chargers, etc.), put vehicle in "park" and set emergency brake.
- 2 Make sure the Jump-Starter Power Switch is turned to OFF.
- 3 Connect the positive (red) clamp from battery booster to a positive (POS, P, +) ungrounded post of the battery.
- 4 Connect the negative (black) clamp from the battery booster to vehicle chassis (must be a heavy gauge metal part of the frame) or engine block away from the battery. **DO NOT** connect the clamp to carburetor, fuel lines, or sheet metal body parts.
- 5 When the clamps are connected properly, the backlit LCD screen will display the following to indicate the unit is ready to jump-start:



The Battery Status icon, Battery Voltage Indicator, Clamp Icons and the "+" and "-" signs light solid. The jump starter icon will flash to indicate the clamps are properly connected.

IMPORTANT – To reduce the risk of a spark near battery:

- Stay clear of fan blades, pulleys, and other parts that can cause injury.
- Check polarity of battery posts. A positive (POS, P, +) battery post usually has a larger diameter than a negative (NEG, N, -) battery post.
- Remove jumper clamps from clamp tabs.

NEVER allow the DC output clamps to touch each other. This may cause a spark.



- 3 Connect the positive (red) clamp from battery booster to a positive (POS, P, +) ungrounded post of the battery.
- 6 Turn the Jump-Starter Power Switch on.

JUMP-STARTING YOUR VEHICLE (cont'd)

- 7 Turn on ignition switch and crank the engine in 5-6 second bursts until engine starts. The backlit LCD screen will display the following:



The Battery Status Icon, the Battery Voltage Indicator, Jump Starter Icon, Clamp Icons and the "+" and "-" signs light solid to indicate the unit is jump-starting.

- 8 Turn the Jump-Starter Power Switch back to the OFF position. **Disconnect the negative (-) clamp first, then disconnect the positive (+) clamp.**

Important

Always turn the unit off when not in use. Recharge this unit fully after each use.

⚠ WARNING

A SPARK NEAR A BATTERY MAY CAUSE A BATTERY EXPLOSION.

Important

Make sure the Compressor Power Button has been turned OFF before attempting to use the unit as a Jump-Starter.

JUMP-STARTING YOUR VEHICLE (cont'd)

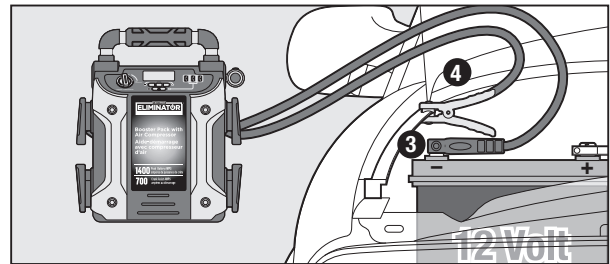
Positive Grounded Battery

- 1 Turn off vehicle ignition and all accessories (radio, A/C, lights, connected cell phone chargers, etc.), put vehicle in "park" and set emergency brake.
- 2 Make sure the Jump-Starter Power Switch is turned to OFF.
- 3 Connect the positive (red) clamp from battery booster to the vehicle chassis (must be a heavy gauge metal part of the frame) or engine block away from the battery. **DO NOT** connect the clamp to carburetor, fuel lines or sheet metal body parts.

IMPORTANT – To reduce the risk of a spark near battery:

- Stay clear of fan blades, pulleys, and other parts that can cause injury.
- Check polarity of battery posts. A positive (POS, P, +) battery post usually has a larger diameter than a negative (NEG, N, -) battery post.
- Remove jumper clamps from clamp tabs.

NEVER allow the DC output clamps to touch each other. This may cause a spark.



- 3 Connect the negative (black) clamp from the battery booster to the negative (NEG, N, -) ungrounded post of the battery.
- 4 Connect the positive (red) clamp from battery booster to the vehicle chassis (must be a heavy gauge metal part of the frame) or engine block away from the battery. **DO NOT** connect the clamp to carburetor, fuel lines or sheet metal body parts.
- 5 When the clamps are connected properly, the backlit LCD screen will display the following to indicate the unit is ready to jump-start:



The Battery Status icon, Battery Voltage Indicator, Clamp Icons and the "+" and "-" signs light solid. The jump starter icon will flash to indicate the clamps are properly connected.

- 6 Turn the Jump-Starter Power Switch on.

JUMP-STARTING YOUR VEHICLE (cont'd)

- 7 Turn on ignition switch and crank the engine in 5-6 second bursts until engine starts. The backlit LCD screen will display the following:

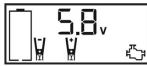

The Battery Status Icon, the Battery Voltage Indicator, Jump Starter Icon, Clamp Icons and the "+" and "-" signs light solid to indicate the unit is jump-starting.

- 8 Turn the Jump-Starter Power Switch back to the OFF position. **Disconnect the positive (+) clamp first, then disconnect the negative (-) clamp.**

Important

Always turn the unit off when not in use. Recharge this unit fully after each use.

⚠ WARNING

A SPARK NEAR A BATTERY MAY CAUSE A BATTERY EXPLOSION.

Important

Make sure the Compressor Power Button has been turned OFF before attempting to use the unit as a Jump-Starter.

JUMP-STARTING YOUR VEHICLE (cont'd)

⚠ WARNING

To reduce the risk of injury or property damage

- Follow all safety instructions found in the "Specific Safety Instructions for Jump Starters" section of this instruction manual.
- Never touch red and black clamps together. This can cause dangerous sparks, power arcing, and/or explosion.
- If the clamps are connected incorrectly with regard to polarity, the unit will sound a continuous alarm until the clamps are disconnected. The backlit LCD Screen will display the Battery Status Icon, the Battery Voltage Indicator and the Clamp Icons. The "+" and "-" signs above the Clamp Icons, the Arrow Icons and the Alarm Icon will flash. The backlit LCD screen will display the following:

**⚠ CAUTION**

To reduce the risk of injury or property damage

- The unit will suffer permanent damage if the Jump Starter Power Switch is turned on while the clamps connected with reverse polarity. Disconnect the clamps and reconnect to battery with correct polarity.
- If the Jump Starter Power Switch is turned on and the unit detects that the clamps are not connected to a battery, a two-second warning will sound every 10 seconds. The LCD screen will display the Battery Status Icon, the Battery Voltage Indicator, and the Clamp Icons with the "+" and "-" signs. The Alarm Icon and the Jump Starter Icon will flash. The backlit LCD screen will display the following :



Turn off the Jump Starter Power Switch; connect the clamps to the battery, making sure the clamps are connected with correct polarity; then turn the Jump Starter Power Switch back on.

- Vehicles that have on-board computerized systems may be damaged if vehicle battery is jump-started. Before jump-starting this type of vehicle, read the vehicle manual to confirm that external-starting assistance is advised.
- Excessive engine cranking can damage the vehicle's starter motor. If the engine fails to start after the recommended number of attempts,

22 JUMP-STARTING YOUR VEHICLE (cont'd)

discontinue jump-start procedure and look for other problems that need to be corrected.

- If vehicle fails to start, turn off the ignition, turn off the Jump-Starter Power Switch, disconnect the jump-start system's leads and contact a qualified technician to investigate why the engine did not start.

USB PORTS

CHARGING A USB DEVICE

This product's USB power output is designed to power or charge small to medium sized devices (e.g. smartphones, MP3 players, etc.). The three USB Ports provide 3.1A (5V) each.

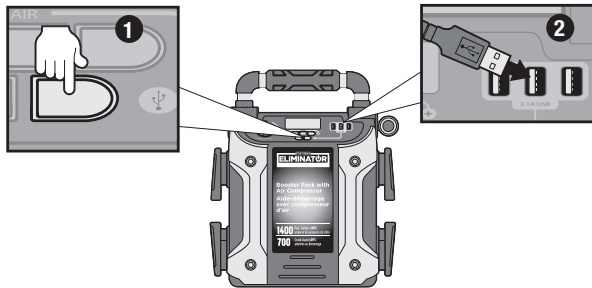

Important Notes

- When the USB Ports are in use, the unit will monitor for the following USB fault conditions on all the USB Ports: low battery voltage fault, overload and short circuit. In any of these cases, the backlit LCD screen will continuously display the following:



The Fault Icon will flash. The USB Ports will automatically shut down. Should this occur:

- Disconnect the USB-powered device and press the USB Power Button again to turn off the USB Ports immediately.
- Make sure the unit does not need to be recharged.

USB PORTS

- Allow the unit to cool down for several minutes before attempting to use the USB Ports again.
- If a fault occurs again, make sure that the total draw of the USB device plugged into the USB Port does not exceed 3.1A (5V).
- If an individual USB device is within specifications and the fault occurs, have the USB device checked for malfunction and do not continue to use it with these USB Ports.
- This unit's USB Ports do not support data communication. They only provide power to external USB-powered devices. The USB Ports provide 3.1 A (5 V) each.
- Some household USB-powered electronics will not operate with this unit.
- 1 Press the USB Power Button to turn on all of the USB Ports. A beep will sound. The backlight will turn on for 10 seconds only. The backlit LCD screen will continuously display the following:



The Battery Status Icon and Battery Voltage Indicator will light solid, as well as the USB Icon, indicating the USB ports are ready to use.

- 2 Plug the USB-powered device into the USB power port(s) and operate normally.
- 3 Press the USB Power Button again to turn off the USB Ports.

Periodically check the unit's battery status on the backlit LCD screen. Four solid bars in the battery icon indicates a full battery. When the battery level is nearly empty with only one solid bar or completely empty with 4 empty bars, the unit must be recharged at this time or the unit's built-in low voltage protection will activate. The empty Battery Status Icon will flash for a short period of time before automatic shut down.

Important

Make sure the USB Ports are turned off when the unit is being recharged or stored.

23

USB PORTS

24 EMERGENCY AREA LIGHT

EMERGENCY AREA LIGHT

The Emergency Area Light is controlled by the Area Light Power Button on front of the unit.

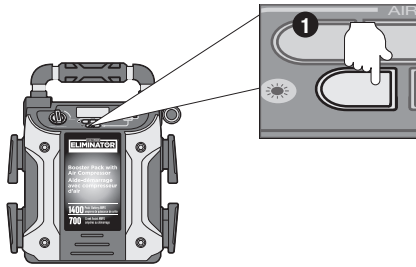

When the Area Light Power Button is pressed to turn it on, a beep will sound. The backlit LCD screen will turn on for 10 seconds only and will then continuously display the Battery Status Icon and the Battery Voltage Indicator.

Periodically check the unit's battery status on the backlit LCD screen. Four solid bars in the battery icon indicates a full battery. When the battery level is nearly empty with only one solid bar or completely empty with four empty bars, the unit must be recharged at this time or the unit's built-in low voltage protection will activate. The empty Battery Status Icon will flash for a short period of time before automatic shut down.

Important

Make sure the Emergency Area Light is turned off when the unit is being recharged or stored.

25 USING THE COMPRESSOR

25

USING THE COMPRESSOR

The built-in 12 volt DC compressor is the ultimate compressor for all vehicle tires, trailer tires and recreational inflatables. A needle adaptor is supplied that screws onto the end of the Sure Fit® nozzle at the free end of the compressor hose. The compressor hose with tire fitting is stored in the compressor hose storage compartment. The Compressor Power Button and Increase (+) and Decrease (-) Compressor Pressure Control Buttons are located on the control panel on the front of the unit.

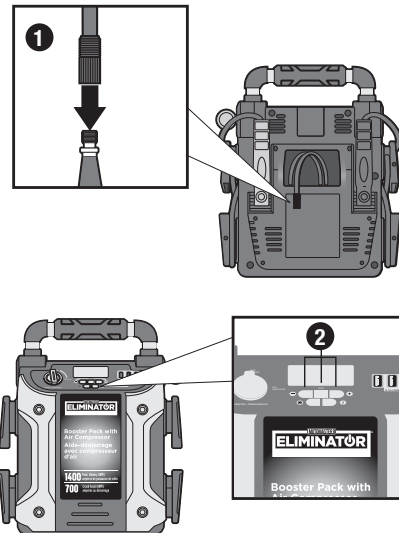

BEFORE PROCEEDING, check the unit's battery status on the LCD screen. Four solid bars in the battery icon indicates a full battery. When the battery level is nearly empty with only one solid bar, the unit **MUST** be recharged before use or the unit's built-in low voltage protection will activate. The empty Battery Status Icon will flash for a short period of time before automatic shut down.

The compressor is capable of inflating up to 120 pounds per square inch (PSI) pressure. The compressor can operate long enough to fill up to 3 average sized tires before the battery must be recharged. Return hose to the storage compartment after use.

26 USING THE COMPRESSOR (cont'd)

Important

Make sure the Jump-Starter Power Switch has been turned OFF before attempting to use the unit as a Compressor.

⚠ WARNING

To reduce the risk of serious injury or property damage, follow all safety instructions found in the "Specific Safety Instructions for Compressors" section of this instruction manual.

⚠ CAUTION

To reduce the risk of injury or property damage

When the compressor is operated at a low PSI, the unit may start in low and gradually rev up. When the compressor is operated at higher PSIs, the unit may operate normally for several minutes, then rev down for a few minutes before returning to normal operation.

This feature protects the unit from overheating during normal use. In any event, do not operate compressor continuously for longer than 10 minutes, as it may overheat. This could damage the compressor.

If the compressor must be operated for longer periods: every 10 minutes press the Compressor Power Button to turn the compressor off, then restart after a cooling down period of approximately 30 minutes.

USING THE COMPRESSOR (cont'd)

Inflating Tires or Products With Valve Stems

- 1 Screw the Sure Fit® nozzle onto the valve stem. Do not overtighten.
- 2 Press the Compressor Power Button. A beep will sound and the backlit LCD screen will display the following:



The Compressor Icon will light and the digital display will alternately show the flashing pre-set PSI value (that was last set by the compressor pressure control buttons) and the current pressure of the item being inflated (which will light solid).

- 3 Press the "+" and "-" Pressure Control Buttons to set the desired pressure from a range pre-set values (between 1 and 120), which will display on the backlit LCD screen. The unit will sound a beep with each press of the buttons (holding the button speeds up the upward or downward value selection). Once the desired pressure has been entered, release the button and the flashing digital display will show the new selected pressure, as follows:



The new selected value is now stored in the unit's memory until it is manually reset.

- 4 Press the Compressor Power Button once more to begin inflating. The Compressor Icon will flash and the digital display will only show the current pressure value (which will light solid) to indicate the compressor is activated. Monitor the pressure on the LCD screen.

IMPORTANT NOTE: To interrupt during inflation, press the Compressor Power Button again.

- 5 When desired pre-set pressure is reached, the compressor will automatically stop.
- 6 Press the Compressor Power Button again to turn off the unit.
- 7 Unscrew and remove the Sure Fit® nozzle from the valve stem.
- 8 Allow the unit to cool, then recharge before storing away.
- 9 Store the compressor hose and Sure Fit® nozzle in storage compartment.

27

USING THE COMPRESSOR (cont'd)

Inflating Other Inflatables Without Valve Stems

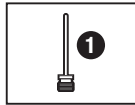

- 1 Inflation of other items requires use of the needle adaptor. Screw the needle adaptor into the Sure Fit® nozzle. Do not overtighten.
- 2 Insert the needle adaptor into item to be inflated.
- 3 Follow steps 2 through 4 of the "Inflating Tires or Products With Valve Stems" section.

IMPORTANT NOTE: Small items such as volleyballs, footballs, etc. inflate very rapidly. Keep this in mind when setting pressure. Take extra care not to over-inflate.
- 4 When the desired pressure is reached, the compressor will automatically stop. Press the Compressor Power Button again to turn off the unit.
- 5 Disconnect the adaptor from the inflated item.
- 6 Unscrew and remove the needle adaptor from the Sure Fit® nozzle.
- 7 Allow the unit to cool, then recharge before storing away.
- 8 Store the compressor hose, Sure Fit® nozzle and needle adaptor in the storage compartment when not in use.

TROUBLESHOOTING

Condition	Solution
Unit will not charge	<p>Make sure all of the unit's functions are turned off.</p> <p>Make sure a suitable gauge extension cord is properly connected to both the unit and a functioning AC outlet.</p>
Unit fails to jump-start	<p>Make sure the unit is not being operated in the Compressor mode.</p> <p>Make sure unit's Jump-Starter Power Switch is in the ON position.</p> <p>Make sure a proper polarity cable connection has been established.</p> <p>Check that unit has a full charge. Recharge unit if necessary.</p>
USB power port will not power appliance	<p>Make sure the USB charging port power button has been pressed.</p> <p>If a fault condition exists in any of the USB Ports, the Fault Icon on the LCD screen will flash. Refer to the Important Notes in the "Charging a USB Device" section to remedy any faults.</p> <p>Some USB-powered household electronics will not operate with this USB charging/power port. Check the manual of the corresponding electronic device to confirm that it can be used with this type of USB charging/power port.</p> <p>Make sure that the total draw the USB device plugged into the USB Port does not exceed 3.1A (5V).</p> <p>Check that unit has a full charge. Recharge unit if necessary.</p>
LED area light does not come on	<p>Make sure the LED area light power button has been pressed.</p> <p>Check that unit has a full charge. Recharge the unit if necessary.</p>
Built-in compressor will not inflate	<p>Make sure the unit is not being operated in the Jump-Starter mode.</p> <p>Make sure the compressor power button has been pressed to turn the compressor on.</p> <p>Make sure the Sure Fit® nozzle connector is securely screwed on to the valve stem when attempting to inflate tires; or that the needle adaptor is securely screwed into the Sure Fit® nozzle connector and is inserted properly into the item to be inflated on all other inflatables.</p> <p>The compressor may be overheated. Press the compressor power button to turn the compressor off. Restart after a cooling down period of approximately 30 minutes.</p> <p>Check that unit has a full charge. Recharge unit if necessary.</p>

30 MAINTENANCE AND CARE

All batteries lose energy from self-discharge over time and more rapidly at higher temperatures. When the unit is not in use, we recommend that the battery be charged at least every 30 days.

Never submerge the unit in water. If the unit gets dirty, gently clean the outer surfaces of the unit with a soft cloth moistened with a mild solution of water and detergent.

Except for the fuse in the 12 V DC Charging Adaptor, there are no user-replaceable parts. Periodically inspect the condition of adaptors, connectors, and wires. Contact manufacturer to replace any components that have become worn or broken.

Battery Replacement/Disposal

The battery should last the service life of the unit. Contact manufacturer for any information you may need.

Contains a maintenance-free, sealed, non-spillable, lead acid battery, which must be disposed of properly. Recycling is required, contact your local authority for information. Failure to comply with local, provincial, and federal regulations can result in fines or imprisonment. Contact your local waste management authority to dispose of this product.

⚠ WARNING

- Do not dispose of the battery in fire as this may result in an explosion.
- Before disposing of the battery, protect exposed terminals with heavy-duty electrical tape to prevent shorting (shorting can result in injury or fire).
- Do not expose battery to fire or intense heat as it may explode.

12 volt DC Adaptor plug fuse replacement

The fuse in the plug end of the 12 V DC Adaptor protects the adaptor's charging circuit. If the built-in 120 V AC Charger operates, but the DC charging adaptor does not, then this fuse may be opened (blown). To replace the fuse:

- Unscrew the end cap of the DC plug (counterclockwise).
- Remove spring center contact and fuse.
- Check fuse with a continuity checker.
- If blown, locate a replacement 2 amp fuse.
- Replace the fuse, spring, contact and end cap.
- Screw end cap clockwise until it is finger tight – DO NOT OVER-TIGHTEN.
- Test for proper operation of the 12 V DC charging adaptor.

LIMITED WARRANTY

MotoMaster® MAKES THIS LIMITED WARRANTY TO THE ORIGINAL RETAIL PURCHASER OF THIS PRODUCT. THIS LIMITED WARRANTY IS NOT TRANSFERABLE OR ASSIGNABLE.

MotoMaster® warrants this battery booster for 1 year from the date of purchase at retail against defective material or workmanship that may occur under normal use and care. If your unit is not free from defective material or workmanship, the Manufacturer's obligation under this warranty is solely to repair or replace your product with a new or reconditioned unit at the option of the Manufacturer. It is the obligation of the purchaser to forward the unit, along with proof of purchase and mailing charges prepaid to the Manufacturer or its authorized representatives in order for repair or replacement to occur.

The Manufacturer does not provide any warranty for any accessories used with this product that are not manufactured by MotoMaster® and approved for use with this product. This Limited Warranty is void if the product is misused, subjected to careless handling, repaired, or modified by anyone other than the Manufacturer or if this unit is resold through an unauthorized retailer.

The Manufacturer makes no other warranties, including, but not limited to, express, implied or statutory warranties, including without limitation, any implied warranty of merchantability or implied warranty of fitness for a particular purpose. Further, the Manufacturer shall not be liable for any incidental, special or consequential damage claims incurred by purchasers, users or others associated with this product, including, but not limited to, lost profits or revenues, anticipated sales, business opportunities, goodwill, business interruption and any other injury or damage. Any and all such warranties, other than the limited warranty included herein, are hereby expressly disclaimed and excluded. Some provinces do not allow the exclusion or limitation of incidental or consequential damages or length of implied warranty, so the above limitations or exclusions may not apply to you. This warranty gives you specific legal rights and it is possible you may have other rights which vary from this warranty.

THIS LIMITED WARRANTY IS THE ONLY EXPRESS LIMITED WARRANTY AND THE MANUFACTURER NEITHER ASSUMES NOR AUTHORIZES ANYONE TO ASSUME OR MAKE ANY OTHER OBLIGATION TOWARDS THE PRODUCT OTHER THAN THIS WARRANTY.

DO NOT RETURN THIS PRODUCT TO THE STORE!

Whether you need technical advice, repair, or genuine factory replacement parts, call Customer Service for Assistance: 1-877-571-2391

31