

KRUPS

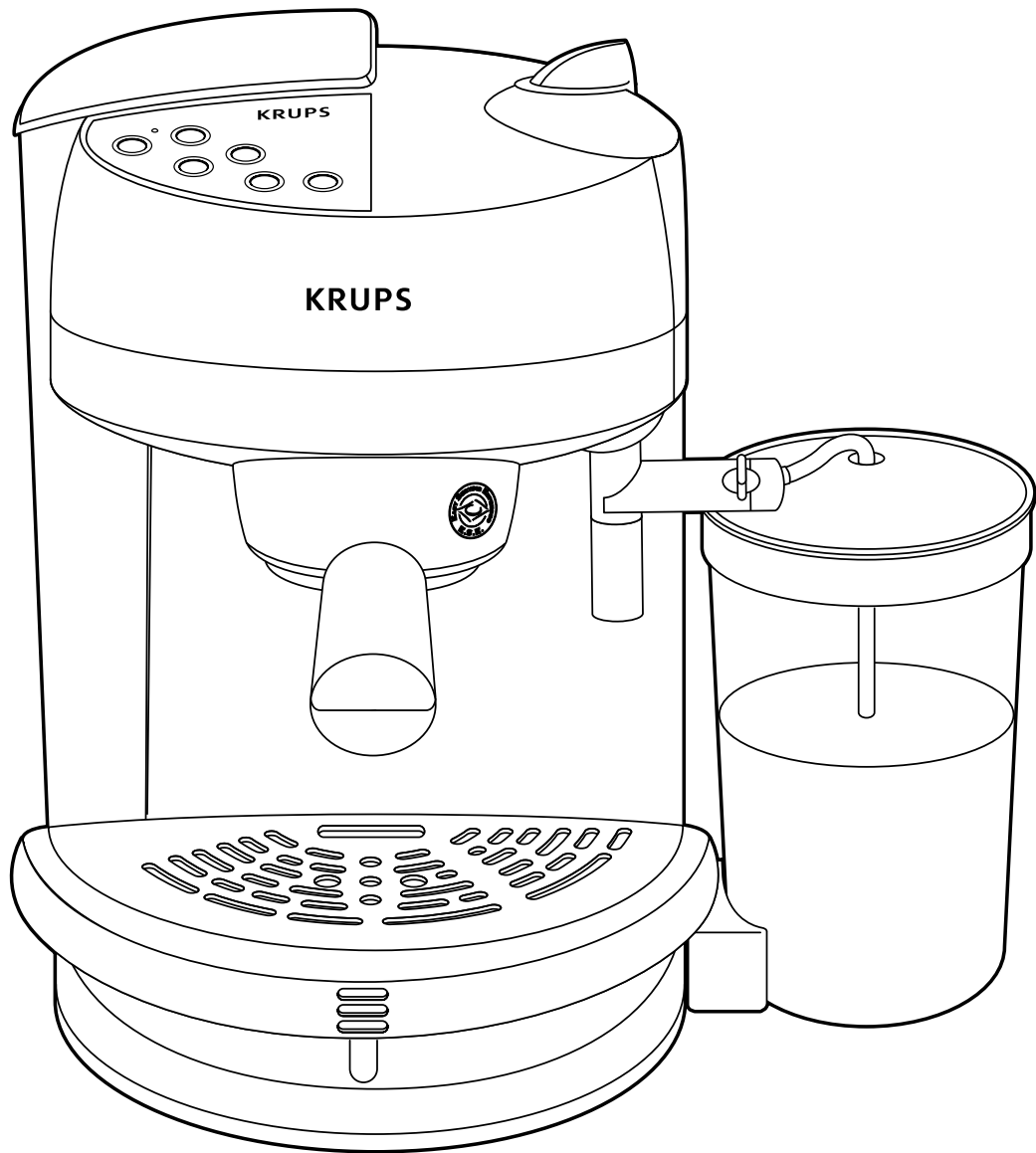

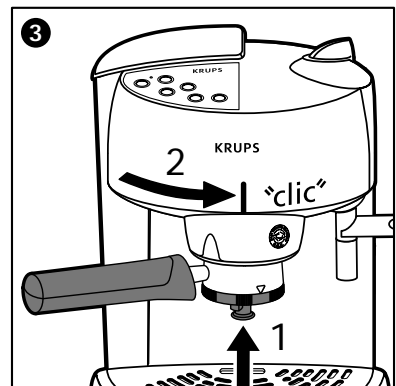

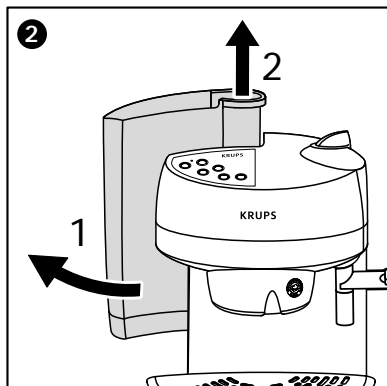
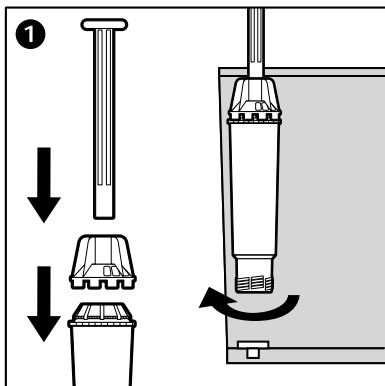
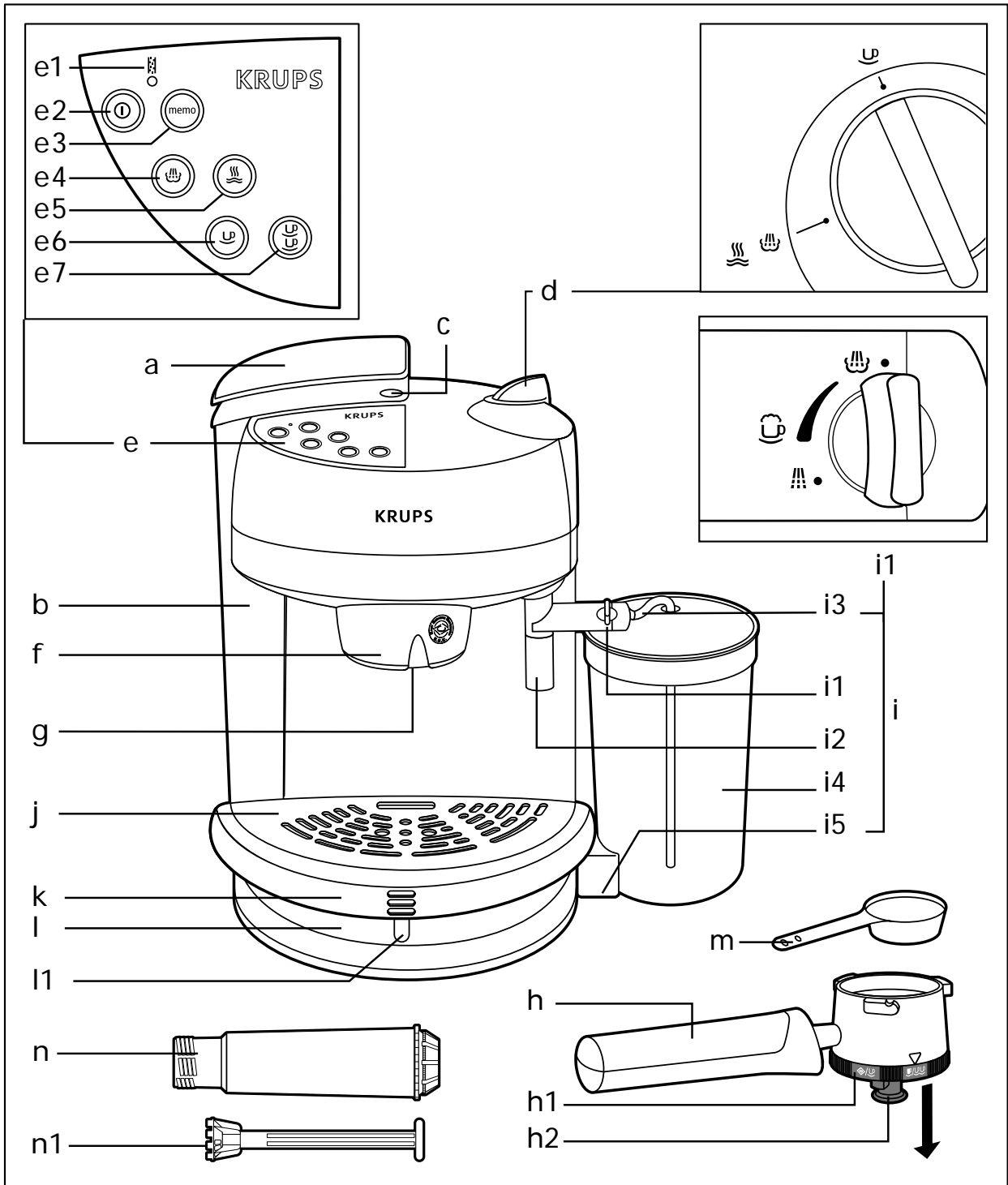
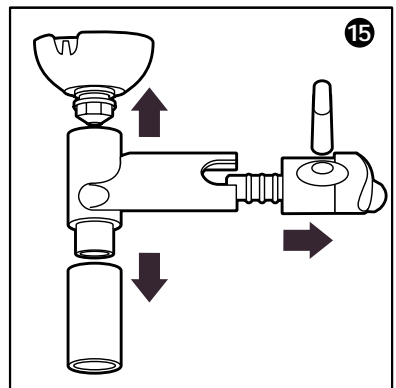
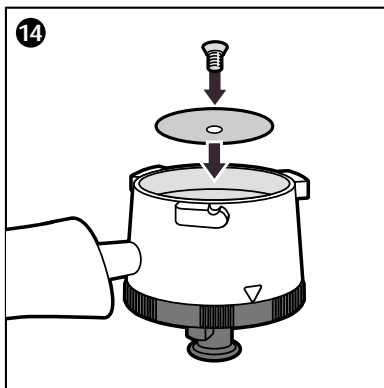
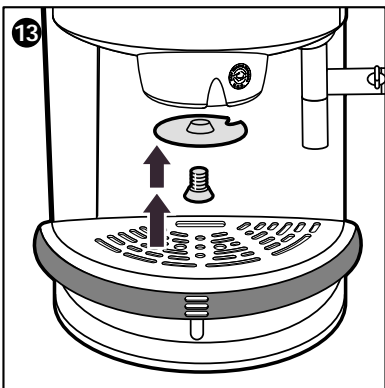
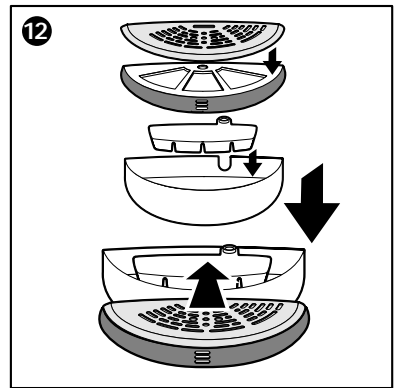
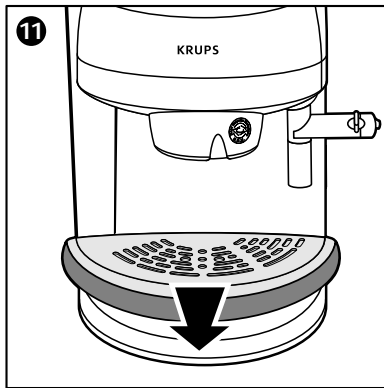
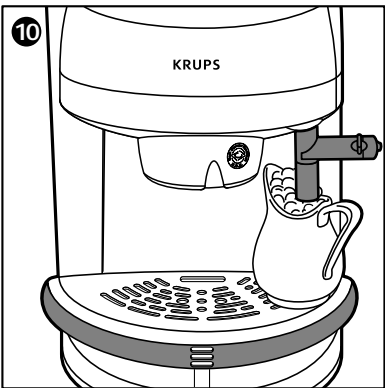
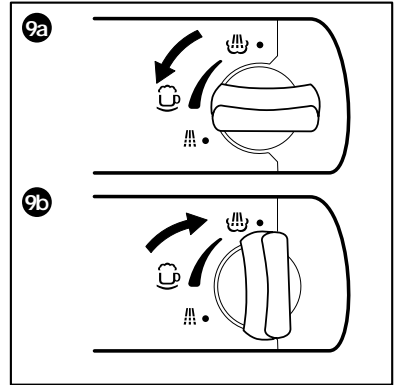
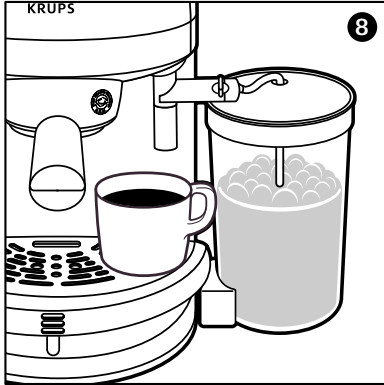
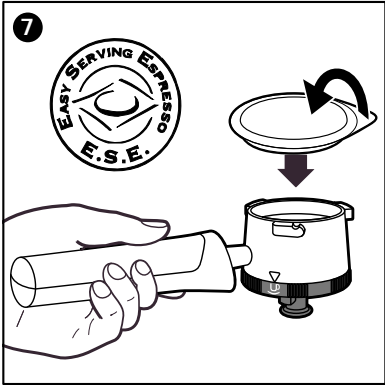
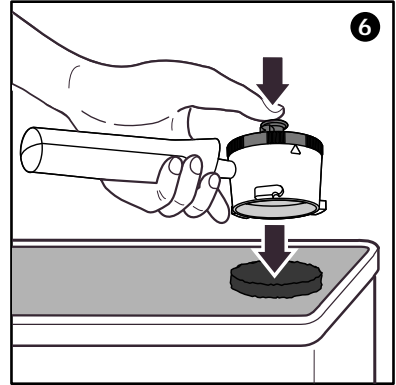
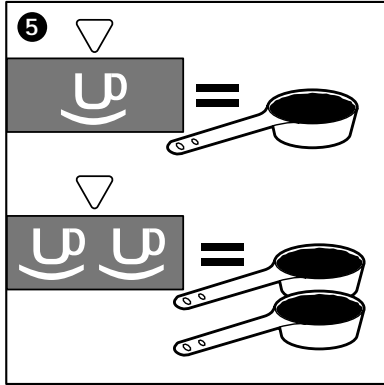
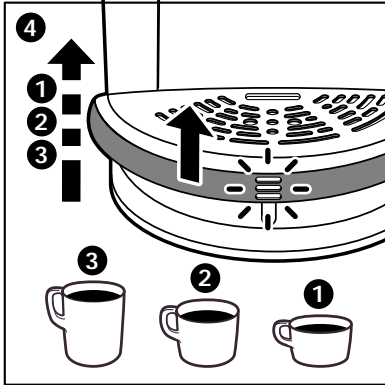

IMPORTANT SAFEGUARDS

When using electrical appliances, basic safety precautions should always be followed to reduce the risk of fire, electric shock and personal injury, including the following:

- Read all instructions carefully.
- Do not touch hot surfaces. Use handles or knobs.
- To protect against fire, electric shock and injury to persons, do not immerse cord, plugs, or appliance in water or other liquid.
- Close supervision is necessary when any appliance is used by or near children.
- Unplug from outlet when not in use and before cleaning. Allow to cool before putting on or taking off parts, and before cleaning the appliance.
- Do not operate any appliance with a damaged cord or plug or after the appliance malfunctions, or has been damaged in any manner. Return appliance to your nearest authorized KRUPS Service Center for examination, repair or adjustment (see Guarantee of Performance).
- The use of an accessory not evaluated for use with this appliance may cause injuries.
- Do not use outdoors.
- Do not let cord hang over edge of table or counter, or touch hot surfaces.
- Do not place on or near a hot gas or electric burner, or in a heated oven.
- To disconnect, turn switch to "OFF", then remove plug from wall outlet.
- Do not use appliance for other than intended use.
- Use extreme caution when dispensing hot steam.

SAVE THESE INSTRUCTIONS

CAUTION

- **This appliance is for household use only. Any servicing other than routine cleaning and user maintenance should be performed by authorized KRUPS service personnel only (see Guarantee of Performance).**
- **Do not immerse base in water.**
- **To reduce the risk of fire or electric shock, do not remove the base of the machine. There are no user serviceable parts inside. Repairs should be performed by authorized KRUPS service personnel only.**





SPECIAL CORD SET INSTRUCTIONS

Regarding your Cord Set:

- A. A short power-supply cord is provided to reduce risks resulting from entanglement in a longer cord.**
- B. Longer extension cords are available and may be used if proper care is exercised in their use.**
- C. If a long extension cord is used, (1) the marked electrical rating of the extension cord should meet or exceed the electrical rating of the appliance, (2) if the appliance is of the grounded type, the extension cord should be a grounding-type 3-wire cord, and (3) the longer cord should be arranged so that it will not drape over the counter top or table top where it can be accessed by small children or readily tripped over.**
- D. This appliance has a polarized plug (one blade is wider than the other). To reduce the risk of electric shock, this plug is intended to fit into a polarized outlet only one way. If the plug does not fit fully in the outlet, reverse the plug. If it still does not fit, contact a qualified electrician. Do not attempt to modify the plug in any way.**

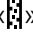
Thank you for choosing an appliance from the **KRUPS** range.

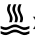
Description

a	Lid
b	Removable pivoting water tank
c	«Change cartridge » indicator
d	Function selector
e	Control panel:
e1	limescale indicator light «  »
e2	On/off switch «  »
e3	reminder control « memo »
e4	«Steam» control «  »
e5	«Hot water» control «  »
e6	«1 cup of coffee» control «  »
e7	«2 cups of coffee» control «  »
f	Swivelling collar
g	Percolation head
h	Filter holder
h1	selection ring : 1 cup (ground coffee) / 1 dose "ESE" 2 cups (ground coffee)
h2	ejection control
i	Auto cappuccino accessory
i1	tap
i2	nozzle
i3	flexible tube
i4	tank with lid
i5	tank support
j	Grille
k	Adjustable grille support
l	Drip tray
l1	Fill indicator
m	Measuring spoon
n	Filtration cartridge
n1	fitting key

Safety instructions



- **Read the instructions for use with care before using your appliance for the first time and retain them for future use : any use which does not conform to the**

instructions will absolve KRUPS from any liability.

- **Never leave the appliance within reach of children without supervision. The use of this appliance by young children or disabled persons must be supervised at all times.**

- Check that the voltage rating of your appliance does in fact match that of your electrical system.
- Only connect the appliance to an earthed socket.

Any connection error will render the guarantee null and void.

- Your appliance is intended solely for **domestic and indoor use**.
- Unplug your appliance as soon as you have finished using it and when you are cleaning it.
- Never use your appliance if it is not working correctly or if it has been damaged. If this happens, contact an approved KRUPS service center (see list in the service booklet).
- Any intervention apart from normal cleaning and maintenance by the customer must be carried out by an approved KRUPS service center.
- Never place the appliance, the power cord or the plug in water or in any other liquid.
- Do not allow the power cord to hang down within the reach of children.
- The power cord must never be close to or in contact with the hot parts of your appliance, close to a source of heat or resting on a sharp edge.
- Never unplug the appliance by pulling on the cord.
- If the power cord or the plug are damaged, do not use the appliance. In order to avoid any risk, these must be replaced by an approved KRUPS service center (see list in the service booklet).
- Do not place the appliance on a hot surface, such as a hotplate, and do not use it close to an open flame.
- For your own safety, you should use only the KRUPS accessories and spare parts which are suitable for your appliance.
- Do not use the appliance unless the drip tray and the grille are in place.

- Make sure the filter holder is correctly positioned before starting to make, and do not remove the filter holder containing the ground coffee while water is passing through, as the appliance is under pressure at that time.
- All KRUPS appliances are subjected to very strict quality controls. Practical tests are done with some appliances selected at random, which explains any signs of use.

Before first use

1. Fitting the filtration cartridge (n) :

- Assemble the 2 parts of the key (n1).
- Unpack the cartridge and attach it to the key.
- Position the cartridge in the tank and screw in **(1)** then remove the key.

The cartridge change indicator (c) lets you know when to change the filtration cartridge:

- . place the left part of the notch over the figure indicating the month of first use,
- . the right part of the notch shows you the month to change the cartridge.

E.g.: if the left part is on "1" (January), you must change it in "3" (March).

Note :

- After each cartridge change, perform a full rinse of the machine with half a tank of water (see paragraph «Rinsing the water system»).

2. Adjusting the limescale monitoring system

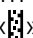
Your appliance is equipped with a limescale monitoring system which lets you know when to perform descaling: the indicator light marked «» (e1) comes on.

To find out the hardness of the water in your area, use the stick supplied with the appliance. You will also find this stick in the KRUPS descaling accessory reference no. 054, which is available from approved KRUPS service center.

The appliance is delivered with the pre-set «3» as descaling interval.



Adjustment :

- Dip the stick in cold water for one second.

Shake off the excess water and work out the hardness according to the number of pink zones showing on the stick.

- Using the following table, determine the adjustment you need to make depending on whether or not you are using the filtration cartridge (n) :

Pink zones on stick	Descaling interval	
	With filtration cartridge	Without filtration cartridge
0 or 1	1	1
2	1	2
3	2	3
4	2	4

- Plug in the appliance.
- Press simultaneously on the "memo" control (e3) and on the on/off switch «» (e2) until the «» indicator light (e1) flashes. Then release the controls.

The descaling interval selected is indicated by the number of indicator lights which are lit.

E.g. : the interval 3 is indicated by the «» indicator light (e1) flashing and the lighting of 3 indicators on the control panel.

- Set the desired descaling interval by pressing the corresponding control:

Interval 1 : «» control (e6)

Interval 2 : «» control (e7)

Interval 3 : «» control (e5)

Interval 4 : «» control (e4)

- Press the «memo» control (e3) to store your selection in memory and to complete the adjustment procedure.

Note :

- . If you do nothing for 10 seconds, the adjustment procedure stops automatically and the changes are not recorded.

3. Rinsing the water system

Rinse the water system with one or two tanks of water, as follows:

- Remove the lid (a), take out the tank (b) and fill it with water **(2)**.
- Replace the tank, positioning it firmly so as to open the connecting valve situated below the tank, and replace the lid.
- Plug in the appliance.

- Press the "on/off" switch «**ⓐ**» (e2), and its indicator light will flash.
- Fit the filter holder (without coffee) onto the percolation head:
 - . make sure that the slot in the pivoting ring (f) catches on the left.
 - . engage the handle of the filter holder in the slot and turn the assembly to the right until it locks (click) **(3)**.
- Turn the function selector (d) to the «**☺**» position.
- Place as large a container as possible below the filter holder. You can adjust the height of the grille depending on the size of the container. To raise or lower the grille, pull horizontally on the support (k), choose one of the 3 positions and slide the support (k) horizontally onto the drip tray (l) **(4)**.

As soon as the appliance reaches the right temperature, the indicator light of the "on/off" control «**ⓐ**» (e2) becomes fixed.

- Press the «**☺**» control (e7) to start the water running.
- Repeat this last operation as many times as necessary to empty half the tank.
- Empty the container regularly and repeat the operation.
- Then move the container under the nozzle (i2) and turn the tap (i1) to the «**☹**» position.
- If necessary, wait for the indicator light of the "on/off" control «**ⓐ**» (e2) to become steady and press the «**☺**» control (e5).
- Turn the function selector (d) to the «**☹**» position and allow the water contained in the tank to run through. The tip of the nozzle (i2) must not touch the bottom of the container.
- Once the container is full, turn the function selector (d) to the «**☺**» position.
- Empty the container then resume the operation until the tank has been completely emptied.
- At the end of the operation, turn the function selector (d) to the «**☺**» position, press the «**☺**» control (e5) and press the "on/off" control «**ⓐ**» (e2) to turn off the appliance.

Using the various functions of your espresso

Important :

. Appliance ready

When using the various functions, after pressing the control (e2), the indicator lights of the other controls may be either on or off. This has nothing to do with the progress of the operation. The important thing is to wait for the indicator light of the "on/off" control «**ⓐ**» (e2) to stop flashing.

. Interrupting operations in progress when the water tank (b) is empty :

The appliance stops and all the indicator lights flash for about 5 seconds when the water tank (b) is empty.

- Fill it and resume the last operation in progress.

. Automatic appliance switch-off

If the appliance is plugged in and the control (e2) is activated, if no operation is performed for 2 hours, the appliance switches itself off automatically: all the indicator lights go out. To restart the appliance, press the control (e2).

1. ESPRESSO FUNCTION

Espresso coffee

Espresso coffee is richer in flavour and stronger than a normal coffee. It is drunk from small, pre-heated espresso cups. The hot water passes through the ground coffee to obtain this delicious black, foamy coffee, which has an invigorating effect.

You can recognize the espresso by its characteristic flavour and its typical foam. But this requires high pressure and an excellent espresso coffee which has been well roasted and correctly ground. If you are unable to buy ground espresso coffee, use a coffee grinder to grind your own beans. This coffee must not be ground «too fine». It should be slightly grainy. If it is too fine, you run the risk of blocking the grilles of the percolation head and of the filter.

To guarantee a completely successful espresso, it is also necessary to use fresh water (i.e., which has not been standing open

to the air for a long time), without any odor of chlorine and at a cold enough temperature.

Tips :



- For best results, preheat the accessories (filter holder and cups) by running water directly into the cups (see paragraph «Rinsing the water system»).
- The quantity of coffee is already preprogrammed for the preparation of one or two cups. To change the pre-programmed quantity of coffee, refer to the paragraph «Programming cup filling».

. Preparing an espresso :

Your appliance allows you to prepare an espresso using either ground coffee or an «ESE» measure.

- Fill the water tank (b).
- Press the “on/off” control «**1**» (e2), and its indicator light will flash.
- Turn the function selector (d) to the position «».

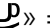
a. Preparing an espresso with ground coffee:

- Align the arrow located on the filter holder with the desired position by turning the selection ring (h1) **(5)**:
«» = 1 cup
«» = 2 cups
- Put ground coffee into the filter holder, pressing the ground coffee down firmly with the back of the spoon (1 measuring spoon (m) = 1 cup) **(5)**.
- Clean the edges of the filter holder.
- Put the filter holder in place **(3)**.
- Place one or two espresso cups beneath the filter holder. If necessary, adjust the height of the grille support **(4)**.

As soon as the appliance reaches the right temperature, the indicator light on the “on/off” control «**1**» (e2) stops flashing.

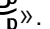
- Press the control (e6) «» or the control (e7) «».

Extraction stops automatically when the preprogrammed quantity of coffee is obtained.

- Take out the filter holder and remove the ground coffee by pressing the ejection control (h2) **(6)**.

Notes :

- **To obtain a shorter coffee, it is possible to interrupt the automatic cycle at any time by pressing the control (e6) or (e7).**
- **To obtain a longer coffee, it is possible to prolong extraction after the machine has stopped automatically by holding down the control (e6) or (e7).**

b. Preparing an espresso with an “ESE” measure

- Use only measures of the type “ESE”.

The E.S.E system was designed to make an Italian-style «ristretto» (pressed) espresso for a quantity of coffee between 35 and 50 ml.

«ESE» for «**E**asy **S**erving **E**spresso» (simplified preparation of espresso) is a measure of selected coffee, ground and compacted between two filter papers which makes it ready to use. This system simplifies the preparation of an espresso by avoiding the measuring and compressing operations and facilitating the cleaning of the appliance.

It is neither intended nor recommended that you make a long coffee with these measures.

We advise that you take care not to deform the «ESE» measures during handling and storage.

- Align the arrow on the filter holder with the position 1 cup «» by turning the selection ring (h1) **(5)**.
- Place the measure in the filter holder fitted with its «ESE» filter. If the measure has a tongue, fold down the tongue towards the interior **(7)**.
- Put the filter holder in place **(3)**.
- Place a cup below the filter holder. If necessary adjust the height of the grille support **(4)**.

As soon as the appliance reaches the right temperature, the indicator light of the “on/off” control «**1**» (e2) stops flashing.

- Press the control (e6) «».

Extraction stops automatically once the preprogrammed quantity of coffee has been obtained.

- Remove the filter holder and throw away the used measure by pressing the ejection control (h2) **(6)**.

Notes :

- . **To obtain a shorter coffee, it is** possible to interrupt the automatic cycle at any time by pressing the control (e6).
- . **To obtain a longer coffee**, it is possible to prolong extraction after the machine has stopped automatically by holding down the control (e6).

2. STEAM FUNCTION

With the auto cappuccino accessory (i), you can :

- . easily obtain more or less frothy milk to make a cappuccino, a café crème or a hot chocolate.
- . heat thick liquids (for example soup).

Practical tips :

- . **Cappuccino** : 1/3 coffee, 1/3 hot milk, 1/3 milk foam.
- . **Café crème** : 1/2 coffee, 1/2 less foamy hot milk.
- . **Hot chocolate**: 1 cup of hot milk (more or less foamy, depending on your taste) into which you mix chocolate powder.

. Preparing steam function

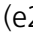
- Fill the water tank (b).
- Press the control «» (e2), and its indicator light will flash.

As soon as the appliance reaches the right temperature, the indicator light of the control (e2) stops flashing.

- Press the «» control (e4).



The indicator light of the “on/off” control (e2) flashes.

a . Foaming milk :

- Pour the milk into the tank (i4). For best results, use cold fresh whole or semi-skimmed milk.
- Place the tank (i4) with its lid, on the support (i5).
- Insert the flexible tube (i3) into the opening in the lid of the tank. The tube must touch the bottom of the container **(8)**.
- Turn the tap (i1) to the position “” to obtain a fine, smooth foam **(9a)**.
- To obtain less frothy milk, turn the tap (i1) towards the top of the scale **(9b)**.

- Place a cup under the nozzle (i2) **(8)**. If necessary, adjust the height of the grille support **(4)**.

As soon as the appliance reaches the right temperature, the indicator light (e2) stops flashing.

- Turn the function selector (d) to the «» position until you obtain the required quantity of foamy milk.
- Turn the function selector (d) to the «» position and remove the cup.



Note :

- Keep the tank (i4) containing any unused milk in the fridge.

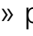

b. Heating thick liquids (e.g. soup):

- Turn the tap (i1) to the «» position.
- Immerse the nozzle (i2) in the liquid to be reheated **(10)**. If necessary, adjust the height of the grille support **(4)**. The tip of the nozzle must not touch the bottom of the container so as not to obstruct the passage of the steam.

As soon as the appliance reaches the right temperature, the indicator light (e2) stops flashing.

- Turn the function selector (d) to the «» position until the liquid is hot enough, then reset the function selector (d) to the «» position and remove the container.

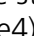
. Important notes :



- After using the steam function, press the «» control (e4) to deactivate this function. The appliance will cool itself down automatically until it reaches the correct temperature to return to the espresso function.
- If you do not press the «» control (e4) within about 2 minutes after using the steam function, the appliance will cool itself down automatically to return to the espresso function.
- The intermittent noise produced during the preparation of steam is caused by the pump being regulated and has nothing to do with the correct operation of the appliance.
- During and after operation of the appliance, **the nozzle (i2) is very hot**.
- We would recommend that you clean the auto cappuccino accessory immediately after use (see “Maintenance” section).

3. HOT WATER FUNCTION

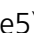

Warning: In certain cases, steam may come out of the nozzle before any hot water is obtained.

- Fill the water tank (b).
- Press the control "on/off" control «**1**» (e2), and its indicator light will flash.
- Turn the tap (i1) to the «» position.
- Place the container under the nozzle (i2) **(8)**. If necessary, adjust the height of the grille support **(4)**. The tip must not touch the bottom of the container so as not to obstruct the passage of the water.

As soon as the appliance reaches the right temperature, the indicator light of the control (e2) stops flashing.

- Press the «» control (e5).
- Turn the function selector (d) to the «» position.
- Once the quantity of water required is obtained, turn the function selector (d) to the «» position.

Notes :

- After using the hot water function, press the «» control (e5) to deactivate this function. The appliance will cool itself down automatically until it reaches the correct temperature to return to the espresso function.
- If you do not press the «» control (e5) within about 2 minutes after using the hot water function, the appliance will cool itself down automatically to return to the espresso function.

4. PROGRAMMING CUP FILL



This function allows you to programme the quantity of coffee you want for each of the espressos prepared.

The appliance is preprogrammed for a quantity of 50 ml per cup.

This programming is to be done while an espresso is being made.

- Prepare the appliance to make one or 2 cups of espresso (see paragraph "Espresso function").

As soon as the appliance reaches the right temperature, the indicator light of the control «**1**» (e2) stops flashing.

- Press the "memo" control (e3). Its indicator light will flash.
- Hold down the control (e6) «» or the control (e7) «» until you obtain the desired quantity of espresso.
- Press again on the "memo" control (e3) to store this quantity of coffee in memory and to end the programming procedure.

If you do not press the "memo" control (e3) within 10 seconds, programming stops automatically and the changes are not recorded.

Maintenance

- Unplug the appliance and allow it to cool.
- Never wash the accessories for your espresso in the dishwasher.
- Clean the body of the appliance with a damp cloth.

After use, the water tank must be emptied.

. The drip tray (l)

- Each time an espresso is prepared, the drip tray fills with water. This is perfectly normal. If there is any water in the fill indicator (l1) you must then empty the drip tray.
- Remove the grille and its support **(11)** and empty the drip tray (l).
- If necessary, clean the drip tray, the grille and its support with water and a little non-abrasive dish detergent, rinse and dry. When reassembling, put back the plastic block situated at the back of the tray **(12)**.

. The percolation head and the filter holder

Please note : These may be burning hot.

These must be cleaned after every use. All you need to do is run a damp cloth over the percolation head and clean the other accessories with water and a little non-abrasive dish detergent. Rinse and dry.

- If the percolation head becomes heavily encrusted, unscrew its grille using a coin, clean it and replace it, tightening it firmly **(13)**.
- If the filter holder becomes heavily encrusted, unscrew its grille using a coin, clean it and replace it, tightening it firmly **(14)**.

. The seal for the percolation head

When you are not using your espresso, do not leave the filter holder in the appliance in order to prevent wear on the seal.

- Clean the seal regularly using a damp cloth.

. Auto cappuccino accessory

After each use, we advise you to rinse the auto cappuccino accessory as follows:

- Press the «☕» control (e4). The indicator light (e2) will flash.
- Turn the tap (i1) to the «☕» position.
- Immerse the flexible tube (i3) into the clean tank (i4) 1/3 full of water.
- Place a container under the nozzle (i2). If necessary, adjust the height of the grille support (4). The tip must not touch the bottom of the container so as not to obstruct the passage of the water.

As soon as the appliance reaches the right temperature, the indicator light of the control (e2) stops flashing.

- Turn the function selector (d) to the «☕» position.
- When all the water has run through, turn the function selector (d) to the «☕» position and press the «☕» control (e4).
- Next, clean the nozzle (i2) with a damp cloth.

We advise you to completely dismantle the auto cappuccino accessory at regular intervals and clean it with water, a little non-abrasive dish detergent and a small brush. Rinse and dry it before refitting it (15).

Please note the direction of fitting the flexible tube: engage the straight-cut end in the auto cappuccino accessory.

Descaling

It is vital that you descale your espresso in order to guarantee its continued operation.

You must descale your appliance when the indicator light «☕» (e1) is lit (see "Before first use" section).

- Descale your espresso at regular intervals using citric or tartaric acid.

We do, however, advise you to use the **Krups descaling accessory, reference 054**, which

is available from approved Krups service centers. You must never, under any circumstances, use classic sulphamic acid or other products containing this acid as there is a risk of damaging the appliance. Carefully check the composition of the descaling products you intend to use.

- Then use the following method:

- Remove the filtration cartridge (n) by unscrewing it using the key (n1).
- Unscrew the grille of the percolation head and clean it (13).
- Dissolve 2 tablespoons of descaling product or half a sachet of accessory 054 in half a litre of lukewarm water and pour it all into the empty water tank.
- Press the "on/off" control «Ⓜ» (e2), and its indicator light will flash.
- Turn the tap (i1) to the «☕» position.
- Place a container under the nozzle (i2) (8). If necessary, adjust the height of the grille support (4). The tip must not touch the bottom of the container so as not to obstruct the passage of the water.

As soon as the appliance reaches the right temperature, the indicator light of the control (e2) stops flashing.

- Press the «☕» control (e5).
- Run through 1/3 of the mixture by turning the function selector (d) to the «☕» position.
- Then, reset the function selector (d) to «☕» and press the «☕» control (e5) to deactivate the hot water function.
- Move the container under the percolation head. Run through the second third of the mixture, by pressing as many times as necessary on the «☕» control (e6).
- Press the "on/off" control «Ⓜ» (e2) to turn off the appliance and wait 10 to 15 minutes to allow the descaler to work.
- Then, press the "on/off" control «Ⓜ» (e2), and its indicator light will flash.

As soon as the appliance reaches the right temperature, the indicator light (e2) stops flashing.

- Press as many times as necessary on the «☕» control (e6) to allow the rest of the mixture to run through into the container placed beneath the percolation head.

- Run through two tanks of fresh water to rinse the percolation head and the nozzle. (See paragraph «Rinsing the water system»).
- Replace the grille on the percolation head (see “Maintenance” section).
- Refit the filtration cartridge (see “Before first use” section).

It is now necessary to inform the scale monitoring system that the descaling operation has been performed. To do this:

The appliance must be plugged in but the «on/off» control «**1**» (e2) is not activated (indicator light off).

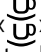
- Press simultaneously on the «» control (e7) and on the “on/off” control «**1**» (e2) until the indicator lights come on. Release the controls.

All the indicator lights will flash then go out. The scaling monitoring system has taken note of the descaling operation which has just been performed. During future use of the machine, the «» indicator light (e1) will remain off until it is again time to descale the machine.

Notes :

In the case of serious scaling, soak the the grille of the percolation head for 5 minutes in 1/3 of the mixture obtained during the first run-through. Then rinse and dry it.

If necessary, this operation can also be performed with the steam nozzle :

- To do this, dismantle the nozzle as instructed in the paragraph «Maintenance» and soak the scaled parts for 5 minutes in 1/3 of the mixture obtained during the first run-through. Rinse the various parts thoroughly before replacing them.

Problems, likely causes and corrective actions

Problems	Likely causes	Corrective actions
Espresso not hot enough.	The accessories are cold (cups and filter holder).	Pre-heat the accessories See the paragraph «Espresso function».

	The appliance is not hot enough.	Wait for the indicator light (e2) to stop flashing.
Leak of coffee around the filter holder	The filter holder is not fitted correctly.	See paragraph «Rinsing the water system».
	There is still some coffee on the edge of the filter.	Clean around the filter and the seal.
	The seal of the percolation head is dirty.	Clean the seal with a damp cloth.
	The seal of the percolation head is defective.	Contact an approved KRUPS service center.
Very loud noise from the pump.	No water in the tank.	Fill the tank.
	Tank badly fitted.	Press firmly on the tank
	Ground coffee too old or very dry.	Use freshly ground coffee.
Water does not run through.	No water in the tank.	Fill the tank.
	Tank badly fitted.	Press firmly on the tank.
	The filter holder is blocked, the ground coffee is too fine or too compacted.	Clean the filter holder and the grille of the percolation head. See the paragraph «Maintenance» and try using a coarser ground or less compacted coffee.
	Grille of the percolation head is encrusted.	Put the grille to soak in the descaling solution. See the paragraph «Descaling».
	Appliance needs descaling, indicator light (e1) is lit.	See the paragraph «Descaling».
Water passes too quickly.	Ground coffee coarse.	Try a finer ground coffee.
	Insufficient quantity of ground coffee.	Use the spoon supplied to measure out the coffee.

	Ground coffee not compacted.	Compact the ground coffee more.
The espresso has no head (foam on the coffee).	Ground coffee too coarse.	Try using a finer ground coffee.
	Ground coffee not compacted enough.	Compact the ground coffee more.
	Ground coffee old or too dry.	Use a fresh ground coffee.
The milk is not very foamy.	Nozzle blocked	See paragraph «Maintenance».
	Milk too old.	Use fresh milk.
	Milk is lukewarm.	Put the milk in the refrigerator
When using E.S.E, coffee leaks around the filter holder.	Measure badly positioned.	Position it correctly (See paragraph «Preparing an espresso with an «ESE» measure»).
	Filter holder not tightened properly.	Tighten it until it locks (click).
Lots of water in the ground coffee.	Ground coffee not compacted.	Compact the ground coffee.
	Insufficient quantity of ground coffee.	Increase the quantity of ground coffee.
There is water around the appliance.	The drip tray is overflowing.	Empty it regularly.

Limited One Year Warranty

Your KRUPS #F927 is covered by the following warranty :

If within one year from date of purchase this KRUPS product fails to function because of defects in materials or workmanship, KRUPS North America will, at its option, repair or replace the unit without charge, provided the owner has a proof of date of purchase.

This warranty will be void if malfunction was caused by damage to the product by accident, misuse, use on frequency or voltage other than marked on the product and/or described in the instructions, abuse including tampering, damage in transit, or use for commercial purposes. This warranty gives you specific legal rights, and you may also have other rights which may vary from state to state.

Accessories

You can obtain the following accessories from your retailer or from an approved KRUPS service center:

- . Filtration cartridge: ref. 088
- . Descaling kit: ref. 054

GUARANTEE OF PERFORMANCE

This fine KRUPS product is manufactured according to a rigid code of quality standards, and, with minimum care, should provide quality service. However, should the need arise for repairs or for replacement parts within or after the warranty period, please call our CONSUMER SERVICE DEPARTMENT:

USA : (800) 526-5377
24-hours a day, 7 days a week
Canada : (905) 669-0114
Monday-Friday 8:00 a.m - 4:30 p.m

**You will be provided with specific instruction on how to get your product repaired.
The department will also be able to answer any general product questions you may have.**

**Before calling the Consumer Service Department, please have the type number of your KRUPS appliance available.
You must have this information before calling our Consumer Service Department so that we may better answer your questions. The type number can be located by looking at the bottom of your appliance.**

This product is Type #F927

Any general correspondance can be addressed to:

USA : KRUPS North America, Inc.
P.O. Box 3900
Peoria, IL 61612

Canada : KRUPS Service
20 Caldari Rd
Concord, Ontario
L4K 4N8