

INGCO



Rotary Hammer

RH12508
URH12508

INDUSTRIAL

EN Rotary Hammer
ES Martillo Perforador



English.....Page 3-11
Español.....Page 12-15

Safety/Instructions



WARNING Read all safety warnings and all instructions. Failure to follow all warnings and instructions may result in electric shock, fire and/or serious injury.

Save all warnings and instructions for future reference.

The term "power tool" in the warnings refer to your mains operated (corded) power tool or battery operated (cordless) power tool.

Work area

- a) Keep work area clean and well lit. Cluttered and dark areas invite accidents.
- b) Do not operate power tools in explosive atmospheres, such as in the presence of flammable liquids, gases or dust. Power tools create sparks which may ignite the dust or fumes.

Keep children and bystanders away while operating a power tool. Distractions can cause you to lose control.

Electrical safety

- a) Power tool plugs must match the outlet. Never modify the plug in any way. Do not use any adapter plugs with earthed (grounded) power tools. Unmodified plugs and matching outlets will reduce risk of electric shock.
- b) Avoid body contact with earthed or grounded surfaces such as pipes, radiators, ranges and refrigerators. There is an increased risk of electric shock if your body is earthed or grounded.
- c) Do not expose power tools to rain or wet conditions. Water entering a power tool will increase the risk of electric shock.
- d) Do not abuse the cord. Never use the cord for carrying, pulling or unplugging the power tool. Keep cord away from heat, oil, sharp edges or moving parts. Damaged or entangled cords increase the risk of electric shock.
- e) When operating a power tool outdoors, use an extension cord suitable for outdoor use. Use of a cord suitable for outdoor use reduces the risk of electric shock.
- f) If operating a power tools in a damp location is unavoidable, use a residual current device (RCD) protected supply. Use of an RCD reduces the risk of electric shock.

3) Personal safety

- a) Stay alert, watch what you are doing and use common sense when operating a power tool. Do not use a power tool while you are tired or under the influence of drugs, alcohol or medication. A moment of inattention while operating power tools may result in serious personal injury.

- b) Use safety equipment. Always wear eye protection. Safety equipment such as dust mask, non-skid safety shoes, hard hat, or hearing protection used for appropriate conditions will reduce personal injuries.
 - c) Avoid accidental starting. Ensure the switch is in the off position before plugging in. Carrying power tools with your finger on the switch or plugging in power tools that have the switch on invites accidents.
 - d) Remove any adjusting key or wrench before turning the power tool on. A wrench or a key left attached to a rotating part of the power tool may result in personal injury.
 - e) Do not overreach. Keep proper footing and balance at all times. This enables better control of the power tool in unexpected situations.
 - f) Dress properly. Do not wear loose clothing or jewellery. Keep your hair, clothing and gloves away from moving parts. Loose clothes, jewellery or long hair can be caught in moving parts.
 - g) If devices are provided for the connection of dust extraction and collection facilities, ensure these are connected and properly used. Use of these devices can reduce dust related hazards.
- 4) Power tool use and care
- a) Do not force the power tool. Use the correct power tool for your application. The correct power tool will do the job better and safer at the rate for which it was designed.
 - b) Do not use the power tool if the switch does not turn it on and off. Any power tool that cannot be controlled with the switch is dangerous and must be repaired.
 - c) Disconnect the plug from the power source before making any adjustments, changing accessories, or storing power tools. Such preventive safety measures reduce the risk of starting the power tool accidentally.
 - d) Store idle power tools out of the reach of children and do not allow persons unfamiliar with the power tool or these instructions to operate the power tool. Power tools are dangerous in the hands of untrained users.
 - e) Maintain power tools. Check for misalignment or binding of moving parts, breakage of parts and any other condition that may affect the power tools operation. If damaged, have the power tool repaired before use. Many accidents are caused by poorly maintained power tools.
 - f) Keep cutting tools sharp and clean. Properly maintained cutting tools with sharp cutting edges are less likely to bind and are easier to control;
 - g) Use the power tool, accessories and tool bits etc., in accordance with these instructions and in the manner intended for the particular type of power tool, taking into account the working conditions and the work to be performed. Use of the power tool for operations different from intended could result in a hazardous situation.
- 5) Service

- a) Have your power tool serviced by a qualified repair person using only identical replacement parts. This will ensure that the safety of the power tool is maintained.

Special Warning for Electric hammer

- Wear ear protection. Exposure to noise can cause hearing loss.
- Use auxiliary handle with the tool. Loss of control can cause personal injury.

Additional safety instructions for your hammer drill

- Wear protective goggles.
When working, sparks or flying splinters, shavings, and dust can cause loss of vision.

Symbol



"WARNING -- To reduce the risk of injury, user must read instruction manual"

Environmental Protection



Waste electrical products should not be disposed of with house hold waste, Please recycle where facilities exist. Check with your local Authority or retailer for recycling advice.

Product specifications

Model No.:	RH12508	URH12508
Voltage:	220-240V	110-120V
Frequency:	50-60Hz	60Hz
Power input:	1250W	1250W
No load speed:	800rpm	800rpm
Impact rate:	3000/min	3000/min
Drilling capacity:		
Concrete:	32mm	1-1/4"
Steel:	13mm	1/2"
Wood:	40mm	1-9/16"

Source of protection

Vibration:

"hammer drilling concrete": $a_{h,ISO} = 7.16 \text{ m/s}^2$, $K = 1.5 \text{ m/s}^2$

"chiselling": $a_{h,ISO} = 18.60 \text{ m/s}^2$, $K = 1.5 \text{ m/s}^2$

noise:

sound pressure level: chiseling mode: $L_{pA} = 98 \text{ dB(A)}$ $K_{pA} = 3 \text{ dB}$; rotary hammer mode: $L_{pA} = 96 \text{ dB(A)}$ $K_{pA} = 3 \text{ dB}$

sound power level: chiseling mode: $L_{WA} = 109 \text{ dB(A)}$ $K_{WA} = 3 \text{ dB}$; rotary hammer mode: $L_{WA} = 107 \text{ dB(A)}$ $K_{WA} = 3 \text{ dB}$

Intended Use

The machine is intended for hammer drilling in concrete, brick and stone. It is likewise suitable for drilling without impact in wood, metal, ceramic and plastic.

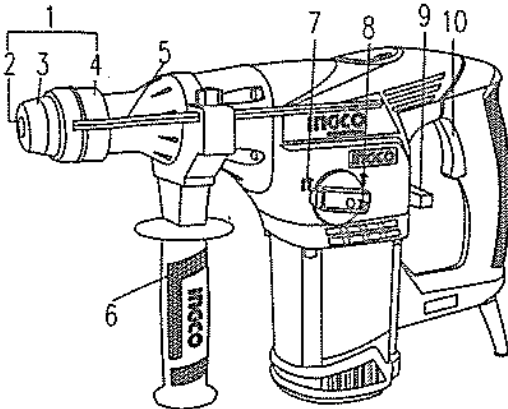
Product Elements

1. SDS-plus replacement drill chuck
2. Tool holder (SDS-plus)
3. Dust protection cap
4. Locking sleeve
5. Depth stop
6. Auxiliary handle
7. Unlocking button
8. Operational mode selection switch 1
9. Operational mode selection switch 2
10. On/Off switch

Not all the accessories illustrated or described included in standard delivery.



Working safely with this machine possible only when the operating and safety information are read completely and the instructions contained therein are strictly followed.



Before using for the first time, ask for a practical demonstration.

if the cable is damaged or cut through while working, do not touch the cable but immediately pull the mains plug.

Never use the machine with a damaged cable.

Wear safety glasses, protective gloves and sturdy shoes.

Wear ear protection to prevent damage to your hearing.

The machine must not be damp and must not be operated in a wet environment.

Keep long hair away from the machine.

Do not operate while wearing loose clothing.

- Connect the mains plug only when the tool is switched off. After using, pull the mains plug.
- Always direct the cable to the rear away from the machine.
- Do not carry the machine by the cable.
- When working with the machine, always hold it firmly with both hands and provide for a secure stance.
- During pauses in the work, when not in use or during work on the machine itself (e.g., changing of the working tools, repairs, cleaning, adjustment), pull the mains plug.
- Persons under 16 year of age are not permitted to operate this machine.
- Keep the tool accessories out of the reach of children.
- Only use original accessories.

Before Use

Be careful of hidden electrical lines or gas and water pipes. Check the working area, e.g. with a metal detector.

Always use the correct supply voltage!

The voltage of the power source must agree with the value given on the nameplate of the machine. RH12508 Machines designated for 230-240 V can also be operated

with 220 V. URH12508 Machines designated for 110-120V can also be operated with 127 V.

Tool Changing

Take care that the dust protection cap 3 is not damaged when changing tools.

SDS-plus Tools



The SDS-plus tool is designed to be freely movable. This causes eccentricity when the machine is offload. However, the drill automatically centres itself during operation. This does not affect drilling precision.

Inserting

Clean and lightly the tool before inserting.

Insert the dust-free tool into the tool holder 2 with twisting until it latches.

The tool locks itself. Check the locking by pulling on the tool.

Removing

Pull the locking sleeve 4 to the rear (a) and hold while removing the tool (b).

Tools without SDS-plus

Do not use tools without SDS-plus for hammer drilling or chiselling!

Use only screwdriver bits that fit the screw heads. Screwdriver bits may also be inserted without a bit holder.

Putting into Operation

Operation

Switching on: Press the on- off switch 10

Switching off: Release the on- off switch 10

Working instructions

Overload Clutch

If the drill bit becomes jammed or caught, the drive to the drill spindle is interrupted.

- Because of the forces that occur as a result, always hold the machine with both hands and take a secure stance. The machine should be used only with an auxiliary handle.

Auxiliary Handle

You will be able to obtain a safe position when working by rotating the handle attachment. Loosen and turn the

handle attachment in an anticlockwise direction.

The tighten the handle attachment.

Depth Stop

Loosen the winged screw 16 on the auxiliary handle 6.

Adjust the drilling depth 1 on the depth stop 5.

Retighten the winged screw.

Operating modes



Warning!

When switching operation modes , Please trigger ON/OFF switch slightly.

1. Hammer drill mode:

Turn the mode selector switch 9 to "  " (Fig.

I) ,and turn switch 8 to the "  " direction.(Fig.III).

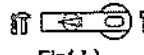

Fig (I)

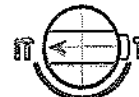
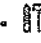
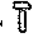

Fig (III)

2. Chisel mode

Turn the mode selector switch 9 to "  " (Fig.

I),and then turn switch 8 to the "  " direction.(Fig. IV)

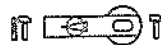



Fig (I)



Fig (IV)

3. Drill mode

Turn the mode selector switch 9 to "  " , (Fig. II),then

turn switch 8 to "  " direction. (Fig.III).



Fig (II)



Fig (III)

Sharpening the Chiselling Tools

With sharpened insertion tools, one achieves good

working performance and long service life. Therefore, sharpen the chisel regularly.

Sharpen the chisel regularly.

Sharpen the tool on a grinding wheel (e.g. alumina oxide) with constant water supply.

Maintenance and Cleaning

Before any work on the machine itself, pull the mains plug.

For safe and proper working, always keep the machine and the ventilation slots clean.

Clean the tool mount daily.

Replacing the Dust Protection Cap

Damaged dust protection caps should be replaced as possible since dust that enters the tool holder can cause malfunctions.

Pull back and hold the locking sleeve 5, pull off the dust cap 4 with a suitable tool.

With the locking sleeve pulled back, pull on the new dust cap until it sits firmly over the tool holder and the locking sleeve can again be slid forward.

If the machine should happen to fail despite the care taken in manufacture and testing, repair should be carried out by an authorised customer services agent for Bosch power tools.

For all correspondence and spare parts orders, always include the 10-digit order number of the machine.

Environmental Protection



Recycle raw materials instead of disposing as waste.

Machine, accessories and packaging should be sorted for environment-friendly recycling.

These instructions are printed without chlorine.

The plastic components are labelled for categorized recycling.

Guarantee

We guarantee Bosch products in accordance with statutory/country-specific regulations (proof of purchase by invoice or delivery note).

Damage attributable to normal wear and tear, overload or improper handling will be excluded from the guarantee.

In case of a claim, please send the machine, completely assembled, to your dealer or the service Centre for electric power tools.

INGCO**SPARE PART LIST****RH12508,URH12508 Spare Part List**

NO.	Part Description	Qty	NO.	Part Description	Qty
1	Front Cap	1	32	O-Ring 55.5x2.5	1
2	Circlip 18X2	1	33	Circlip 47	1
3	Slider Washer	1	34	Oily Bearing	1
4	Slider	1	35	Crankshaft Case	1
5	Slider Spring28.9x33.8x65	1	36	Small Bevel Gear	1
6	Cylinder Case	1	37	Flat Pin 4x4X14	1
7	Bolt M4x16	4	38	Bearing 6002-2z	1
8	Spring Washer 4	4	39	Washer 20x12.2x0.5	1
9	Flat Washer 4	4	40	Needle Bearing HK1210	2
10	O-Ring 20x2	2	41	Wheel Core	1
11	Guard Ring Sleeve	1	42	Tripping Spring 5.5x1.1x12	10
12	Steel Ball Φ 7.14	5	43	Steel Ball ϕ 5.5	10
13	O-Ring 11x2	2	44	Second Gear	1
14	Second Stricker	1	45	Circlip ϕ 52	1
15	O-Ring 18x3	2	46	Washer 16.5x7x1	1
16	Ram	1	47	Circlip ϕ 12	1
17	Circlip 27.3x2	1	48	Clutch	1
18	Oil Seal 48x33.8x7	1	49	Spring 19x12x1x21	2
19	Oil Seal Washer 55x45x1.25	1	50	Washer 20x12.2x1	1
20	Bearing 61907	1	51	Bearing 627-2z	1
21	Steel Ball Φ 7.94	3	52	Screw M4x8	1
22	Cylinder	1	53	Stop Plate	1
23	Flat Pin 3x3x18	2	54	Grease Window Knob	1
24	Circlip 35x2	1	55	Grease Window Seat	1
25	Big Bevel Gear	1	56	Grease Window Cap	1
26	Piston Pin 6x23	1	57	O-Ring 38x2	1
27	Piston	1	58	Crankshaft	1
28	Connecting Rod	1	59	Steel Ball ϕ 5.5	3
29	Needle Bearing HK0810-WJS	1	60	Bearing 6202-2z	1
30	Rubber Ring 55x47x7	1	61	Circlip 13.5x1	1
31	Bush	1	62	Circlip ϕ 35	1



SPARE PART LIST

RH12508,URH12508 Spare Part List

NO.	Part Description	Qty	NO.	Part Description	Qty
63	First Gear	1	94	Power Cord	1
64	Needle Spring	1	95	Shifting Fork	1
65	Support Pillar	1	96	Pin B4X40	1
66	Anti-Friction Ring	1	97	Balance Spring	1
67	Paper Washer	1	98	Circlip ϕ 15	1
68	Screw M4x8	2	99	Knob Handle	1
69	Locking Plate	1	100	Screw M3X16	1
70	Crankshaft Case	1	101	Spring Washer ϕ 3	1
71	O-Ring	1	102	Flat Washer ϕ 3	1
72	Function Switch Knob	1	103	Side Knob	1
73	Label	1	104	Knob Spring	1
74	Bearing 6001-2RS	1	105	Locating Piece	1
75	Rotor	1	106	Screw M5X20	2
76	Bearing 608-2Z	1	107	Screw M5X35	2
77	Self-tapping Screw ST4.8X65	2	108	Depth Gauge	1
78	Air Guider	1	109	Auxiliary Handle	1
79	Right Shell	1	110	Pin 6x20	1
80	Self-tapping Screw ST4X19	14	111	Bolt	1
81	Label	1	112	Chuck Ring	1
82	Stator	1	113	Plastic Cap Screw	1
83	Motor Housing	1	114	Handle Clamp	1
84	Screw M5x28	4	115	Nut M6	1
85	Brush Holder	1	116	Depth Gauge Clamp	1
86	Self-tapping Screw ST4X12	4	117	Self-Tapping Screw ST4X25	2
87	Carbon Brushes	2	118	Rear Handle	1
88	Bottom Cover	1	119	Self-tapping Screw ST4.2X52	1
89	Left Shell	1	120-1T	Speed Dial (30C3-1T)	1
90	Switch	1	120-1	Handle Cover (30C3-1)	1
91	Cord Sheath	1	120-1-1	Outer Cover	1
92	Cord Clamp	1	120-1-2	Inner Cover	1
93	Self-tapping Screw ST4X16	2	120-1-3	Self-tapping Screw ST4X19	1

INGCO

EXPLODING VIEW

RH12508,URH12508 Exploding view

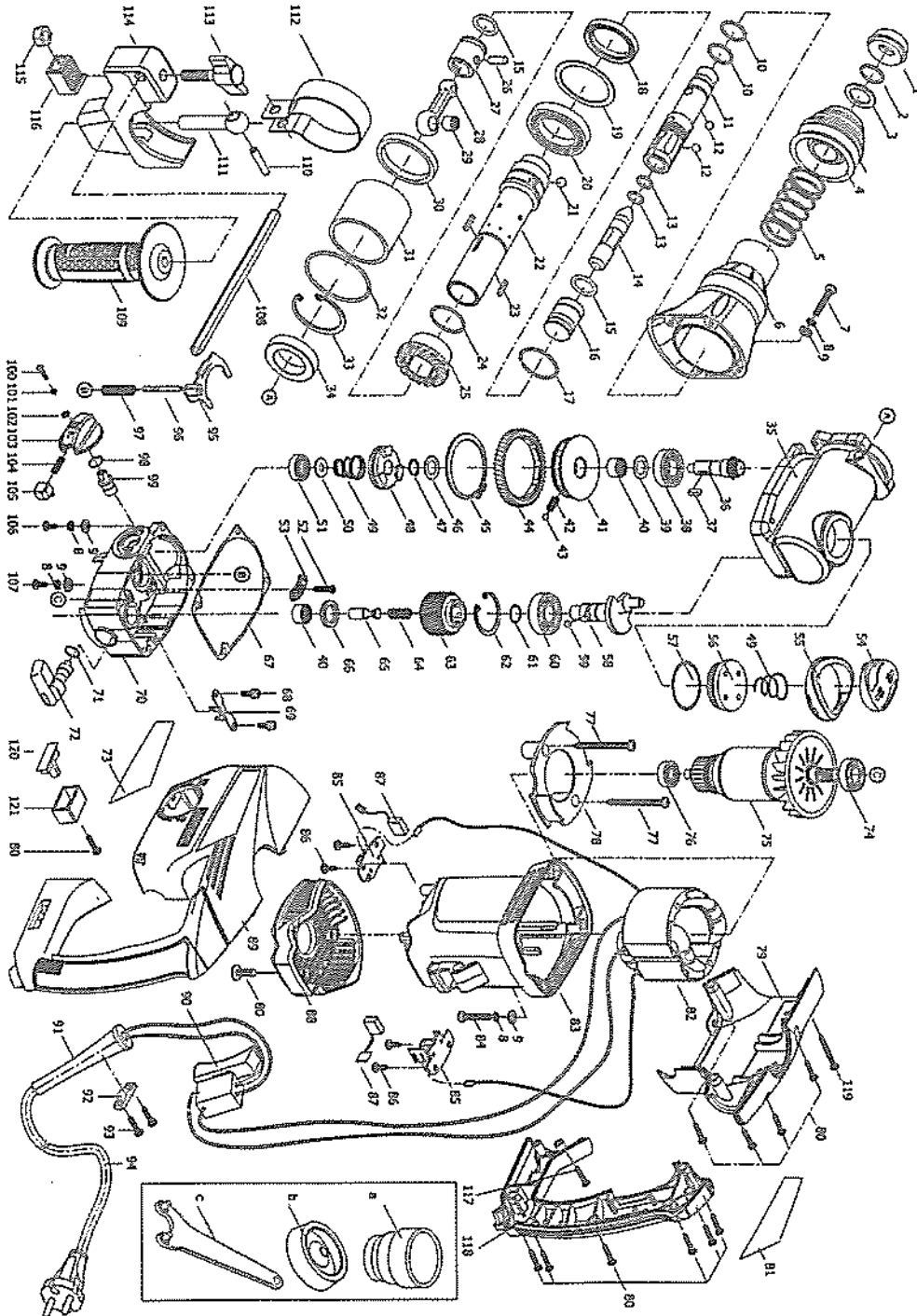



Instrucciones de seguridad

¡Importante! Cuando se utilice una herramienta eléctrica hay que protegerse contra el riesgo de una descarga eléctrica, lesiones e incendio, es imprescindible tomar las siguientes precauciones básicas de seguridad. Lea y tenga en cuenta estas instrucciones antes de utilizar la máquina.

- Compruebe la tensión (voltios) marcada en la placa.
- Cuando utilice tambores de cable, corra todo el cable fuera del tambor. La mínima sección transversal de conductor es de 1,0 mm².
- Si utiliza martillo eléctrico de percusión al aire libre, conecte el martillo a la red eléctrica con cable de extensión tipo de HO7RN-F3G con sección transversal de 1,5 mm² y enchufes con protección de agua de lluvia que estén en buenas condiciones de funcionamiento.
- Asegúrese de mantener un buen equilibrio en escaleras y andamios durante la perforación.
- Utilice un detector de metales para localizar en las paredes las tuberías ocultas con cables eléctricos, agua o gas. Evite tocar componentes vivos o conductores.
- Use tapones para oídos para proteger su audición. La pérdida de audición puede ser un proceso gradual!
- Use gafas y cuando el trabajo genere polvo, use una máscara para polvo.
- No utilice la máquina en lugares donde haya gases o líquidos inflamables.
- Desconecte siempre el cable de la toma de corriente antes de limpiar o hacer cambios en la máquina.
- Proteja el cable de alimentación de daños. El petróleo y los ácidos pueden dañar el cable.
- No sobrecargue la máquina.
- Ajuste bien todas las piezas de trabajo.
- ¡Importante! Es imprescindible seguir las normas de seguridad nacionales en materia de instalación, operación y mantenimiento.
- Las brocas y cincel pueden ser lanzados por accidente fuera de la máquina y pueden causar lesiones graves.
- Antes de empezar a trabajar, compruebe siempre que el cincel o la broca de perforación esté correctamente fijada en la porta broca.
- Examine regularmente la porta broca para detectar señales de desgaste o daño.
- Nunca poner en marcha una herramienta de martillo hasta que esté en contacto con la superficie de trabajo (pared, techo, etc)
- A la hora de terminar el trabajo, desconecte el martillo de percusión de la red eléctrica y retire el cincel o la broca de la máquina.
- Desconecte siempre el martillo de percusión de la red eléctrica antes de cambiar un cincel o una broca.
- Proteja sus ojos y los de las personas que estén cerca del sitio de trabajo de partículas en el aire y astillas. ¡Use casco! ¡Instale los tabiques!
- Use guantes de trabajo para proteger sus dedos de golpes y la formación de ampollas.
- Las vibraciones pueden dañar sus manos y brazos. Mantenga la exposición a la vibración tan corto como sea posible.
- Siempre lleve los cables de alimentación desde el dispositivo hacia atrás.
- Guarde el dispositivo en el lugar que sea inaccesible a niños.
- Durante del trabajo, sostenga siempre el dispositivo con ambas manos y asegúrese de que tenga una posición de pie estable. En el folleto adjunto, encontrará más instrucciones de seguridad para herramientas eléctricas.

2.7 Martillo y la función de perforación

Gire el interruptor de palanca (7) a la izquierda a la posición de , presione el pasador de bloqueo (9) y gire el selector de la palanca (8) para que la marca  coincida con la flecha en el máquina.

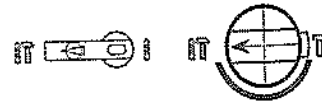

¡Importante!

Cuando se trabaje con el martillo percutor rotativo se necesita baja presión. Demasiada presión ocasiona una carga innecesaria en el motor. Revise las brocas con regularidad. Vuelva a afilar o reemplazarlas si es necesario.

3. Mantenimiento

- 3.1 Retire el enchufe del tomacorriente antes de realizar cualquier trabajo en el dispositivo.
- 3.2 Mantenga su máquina limpia en todo momento.
- 3.3 Nunca use agentes cáusticos para limpiar las piezas de plástico.
- 3.4 Al final de su trabajo, para evitar acumulaciones de polvo debe usar el aire comprimido (máx. 3 bares) para limpiar las ranuras de ventilación.
- 3.5 Comprobar las escobillas de carbón (escobillas de carbón sucias o desgastadas ocasionan excesivas chispas y fallas en la velocidad).
- 3.6 Abrir la tapa del aceite con la llave suministrada para añadir grasa periódicamente

4. Solución de problemas

- 4.1 Si el martillo percutor rotativo no funciona, revise la corriente en el enchufe de la red.
- 4.2 Si la broca no corta correctamente, compruebe la nitidez de la broca, reemplace la broca si está desgastada. Compruebe que el martillo esté en la posición de rotación hacia adelante, para uso normal.
- 4.3 Si la falla no puede ser rectificada, entregue el martillo a personal calificado para el servicio.

INGCO

RH12508,URH12508 Rotary Hammer

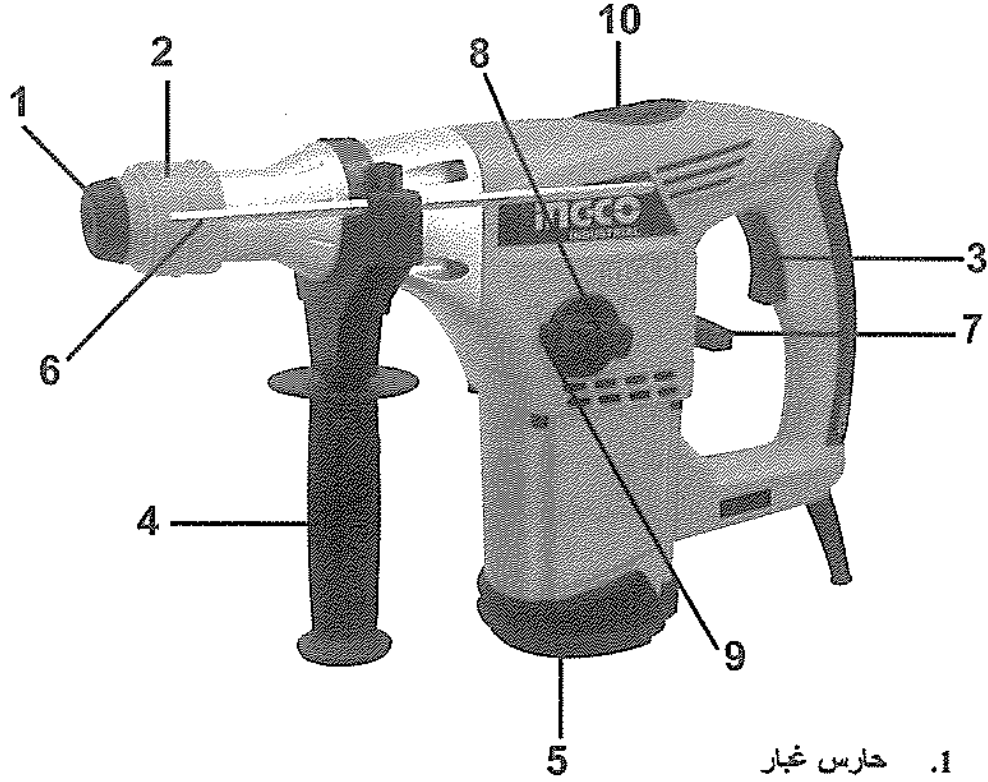

1. حارس غبار
2. طرف شاكوش
3. مفتاح تشغيل وإيقاف
4. المقبض المساعد
5. الغطاء الخلفي
6. توقف عمق
7. توقف مطرقة
8. توقف مثقاب
9. دبوس قفل
10. غطاء زيت

المنشأ صنع في الصين

.....

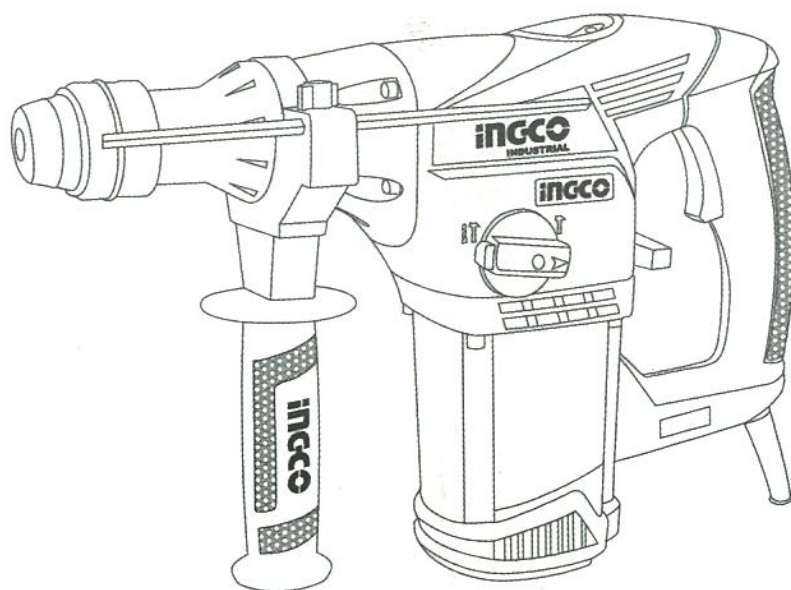

Rotary Hammer

INGCO TOOLS CO., LIMITED
www.ingcotools.com
MADE IN CHINA
0214.V02