

How to use and control / 如何使用和控制

Filter indicator / 滤器指示灯



- When the orange filter indicator lights on the window completely, remove dust before using the vacuum cleaner.
- 當濾器指示燈窗口的橘黃色濾器指示燈完全亮時，請在吸塵器使用前將灰塵清除。



Caution: When filter indicator lights on, do not use the vacuum cleaner without dust removal. Doing so may decrease suction power and cause overheating. The motor may be burned out.



注意事項: 當濾器指示燈亮時，在未清灰塵前請勿使用真空吸塵器，否則可能會降低吸力並導致過熱，馬達可能被燒壞。

- To check the filter indicator, adjust to the highest electronic power level and lift nozzle from the floor.
- 要檢查濾器指示燈，把電子功率調到最高，並將吸嘴從地板上提起。

Caution and maintenance / 注意事项和保养



Caution
注意事项



Direction
使用说明



Prohibition
禁止



If the power cord or the vacuum cleaner is damaged, contact the manufacturer or service agent to repair it.

如果电源线或真空吸尘器受损，请联系制造商或服务机构维修。

- Do not operate the vacuum cleaner if the cord is damaged.
- 如果电源线受损，请勿使用真空吸尘器。

- Do not block air vent.
- 请勿堵塞排气口。

- Do not use the vacuum cleaner to clean gasoline, benzene, flammable gas or cigarette ash.
- 请勿用真空吸尘器清除汽油、苯、易燃气体或烟灰。

- Do not use the vacuum cleaner to clean wet or damp area.
- 请勿用真空吸尘器清除潮湿的地方。

- Do not wash the vacuum cleaner.
- 请勿清洗真空吸尘器。

- Do not allow your children to play with the vacuum cleaner.
- 请勿让您的孩子玩弄真空吸尘器。

- Do not use the vacuum cleaner near any flammable materials.
- 请勿在任何易燃材料附近使用真空吸尘器。

- Do not connect the plug with a loose socket, it may cause the melted plug.
- 请勿将插头接到宽松的插座，否则可能导致插头熔化。

- Always disconnect power plug after using the vacuum cleaner.
- 真空吸尘器用过后，总是断开电源插头。

- Always disconnect power plug before repairing.
- Use only Hitachi carbon brush.
- If vacuum cleaner is used for cleaning wet surface or outdoor cleaning, it may cause electric shock.
- 维修前总是先断开电源插头。
- 必须使用日立碳刷。
- 如果用真空吸尘器清除湿润表面或在户外使用，可能会引起触电事故。

- Warning:** The appliance is not intended for use by children or infirm person without supervision.
- Children should be supervised to ensure that they do not play with the appliance.
- 儿童或虚弱人士若无监护人请勿使用本电器。
- 儿童需有人监护禁止玩弄本电器。

- 警告:** This product conforms with the safety requirements of council directives IEC60335-1, IEC60335-2-2.
- 本产品符合有关电磁兼容性的欧盟理事会指令 IEC60335-1, IEC60335-2-2。

HITACHI

THE HITACHI ATAGO BLDG.

15-12, Nishi-Shinbashi 2-chome, Minato-ku, Tokyo, 105-8410 Japan
Tel.: Tokyo (03) 3502-2111

3-M2971-2

Instruction Manual 使用说明书 Vacuum Cleaner 真空吸尘器 CV-BM16

HITACHI
Inspire the Next

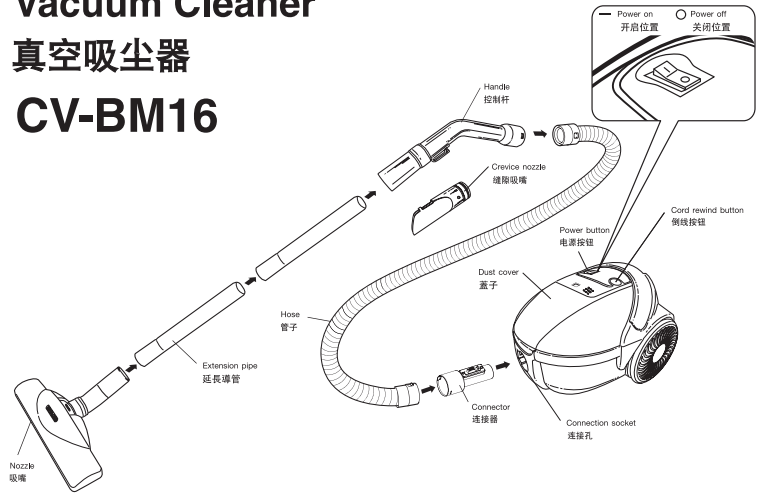

Accessories and preparation before use

附件和用前准备

| Accessories / 附件 | | | How to connect the extension pipe 如何连接延长管 |
|-----------------------|-------------------------------|--------------------------------|---|
| <p>Nozzle 吸嘴</p> | <p>Extension pipe 延长管</p> | <p>Crevice nozzle 缝隙吸嘴</p> | <p>Extension pipe 延长管</p> <p>Twist tightly 拧紧</p> |
| <p>Handle 控制杆</p> | <p>Hose 管子</p> | <p>Connector 连接器</p> | |

Accessories and preparation before use

附件和用前准备

How to remove accessories / 如何拆下附件

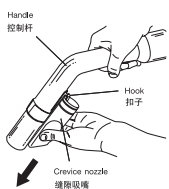

How to assemble nozzle / 如何安装吸嘴

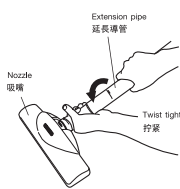

How to assemble connector / 如何安装连接器

- Align the claw of hose with the connector and push until the "click" sound is heard.
- 对齐管子和连接器的卡爪并推动，直到发出“滴答”声。

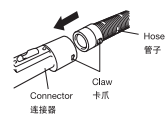

How to assemble handle / 如何安装控制杆

- Align the claw of hose with the handle and push until the "click" sound is heard.
- 对齐管子和控制杆的卡爪并推动，直到发出“滴答”声。

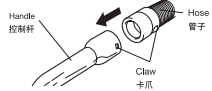

How to assemble hose to the unit / 如何将管子安装到设备上

- Insert the hose into the connection socket of the unit until the "click" sound is heard.
- 将管子插入设备的连接接口，直到发出“滴答”声。



- To remove, press the lock button and pull out.
- 若要拆下，按下锁定按钮并拔出。

How to connect handle to the extension pipe / 如何连接控制杆和延长管



How to use and control / 如何使用和控制

Automatic cord rewind / 自动倒线



- For automatic cord rewind, press the cord rewind button of the unit.
- 要自动倒线，按下设备的倒线按钮。

- Direction:** If the cord is not rewinded completely, pull the cord slightly. Then press the button once.
- 使用说明:** 如果倒线不彻底，则可先轻拉一下，然后再按一次倒线按钮。

How to control suction power with handle / 如何用控制杆控制吸力

- To decrease suction power, turn the adjustment ring so that the air could pass through the hole.
- 要减小吸力，转动吸力环，使空气可以从孔中通过。

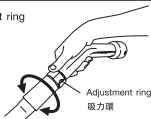

How to store / 如何存放

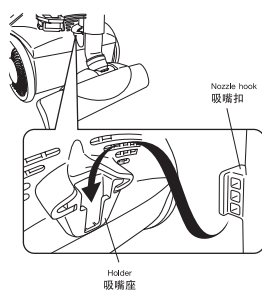

How to use and control / 如何使用和控制

Dust removal / 清除灰尘

- Place the unit in an up-right position and open the upper cover.
 - 将设备竖放，并打开设备上的盖子。
- Pull the (green) hook in the direction of the arrow in the example.
 - 顺着图上箭头的方向拉并扣子（绿色）。
- Remove the dust bag pad from the hook.
 - 将集尘袋垫子从扣子上取出。
- Empty the dust bag.
 - 取出并清空集尘袋。

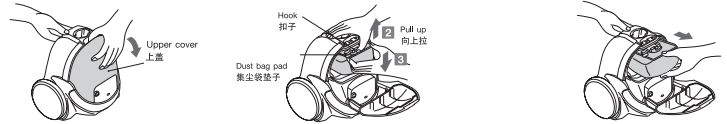

Caution: Carefully remove the dust bag. Do not spill dirt or dust, as this may cause motor damage.

注意: 慢慢取出集尘袋，请勿让尘屑或灰尘掉进马达，否则会导致马达受损。

If the dust fabric bag may be removed for cleaning / 集尘袋能够取出并进行清洗的情况下



- Slide the bag clip out and empty the dust. Clean the bag with water.
- 移出袋夹后，清除灰尘，并用水清洗。

Direction: Regular cleaning of the dust fabric bag will help to prolong product life.

使用说明: 经常清洗集尘布袋能够延长设备的使用寿命。

Caution: The dust bag should not be machine-washed, and should be hung in the shade to dry before reuse.

注意: 请勿用洗衣机清洗，应在阴凉处晾干后再使用。

How to assemble the dust bag / 如何安装集尘袋

- Arrange the bag so that the mark on the dust bag pad is on the upper side.
 - 把集尘袋垫子上的凹口置子上面。
- Insert the bag into the hole and push it towards the (green) hook.
 - 插入槽中并用力向扣子（绿色）处压紧。
- Close the upper cover.
 - 盖好上盖。

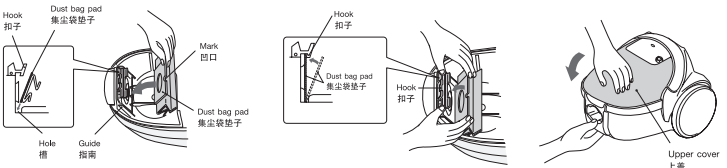

How to remove the motor protection filter / 如何拆卸马达防护滤片

- Open the upper cover. Pull the rubber fender upwards, and then remove the filter. Rinse the filter with water and hang in the shade to dry.
 - 打开上盖，提起缓冲橡胶，取出滤片并用水清洗。
- Pull the rubber fender up and replace the filter (with the mark on the lower side).
 - 提起缓冲橡胶，把滤片置于原处。（让凹口在下面）
- Return the protruding edge of the rubber fender to its original position.
 - 把缓冲橡胶突出的边缘装回原处。

