

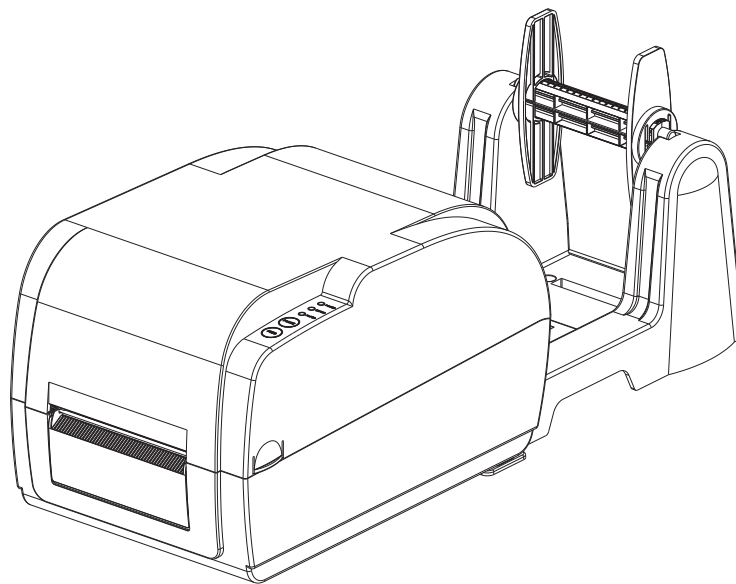

User's Manual

GP-9034T/9035T

Thermal Transfer Barcode Printer



Customer service hotline : 400 611 3828

CONTENTS

1. The printer	02
1.1 Introduction	02
2. Application Field	02
2.1 Product features.....	03
2.1.1 Standard equipment	03
2.1.2 Optional accessories	03
2.2 Specifications	03
2.3 Printing specification	04
2.4 Ribbon specification.....	04
2.5 Paper specification	04
3. Specification.....	05
4. Printer Introduction	06
4.1 Open and check	06
4.2 Printer components.....	07
5. Installation	09
5.1 Cable connection.....	09
5.2 Ribbon installation	09
5.3 Paper installation	10
6. LED Indicator and Function.....	11
6.1 LED indicator.....	11
6.2 Button Function	12
6.3 Power on Function	12
7. Maintenance	17

1. The printer

1.1 Introduction

Thanks for choosing GP-9034T, GP-9035T series direct thermal and thermal transfer label printer.

This series printer is built with 2 sets of gear to drive motor, with capability of handling 300 meters long ribbon and large label roll. Printer inner volume is fit for 5" OD (Outer Diameter) paper roll, if using external paper holder, you can install 8.4"OD industrial grade label roll.

This printer is designed for real-time and batch label printing, with serial, parallel, USB and Ethernet connection port. Direct thermal printing and thermal transfer printing modes are all in one printer body, so you can choose various kinds of printing materials, for example: thermal paper, plain paper, coated paper, silver paper, plastic paper etc.

Common 1D barcode and 2D barcode fonts are built inside printer, also it support 4 direction printing, characters can be enlarged from 1 to 10 times. Besides, it supports 5 different size bitmap fonts, OCR-A and OCR-B fonts, together with 300dpi higher print resolution, this series printer are your best choice among the same class.

Declaration: This is a class A product , fit for Non Tropic regions installation . This product may cause radio interference in life environment , users may need to take adequate preven-tive measures.

2. Application Field

Manufacturing & Warehousing logistic industry

- Product labeling and marking
- Warehouse management label
- Category marking label
- Operation instruction marking label
- Distributing instruction marking label

Healthcare

- Patients marking
- Medicine marking
- Specimen marking

Parcel Post

- Mailing label

Office & Studio

Retail

- Price Label marking
- Product item marking
- Jewelry product marking

2.1 Product features

2.1.1 Standard equipment

Product standard	300 DPI								
Ribbon printing	<input type="radio"/>								
Direct Thermal printing	<input type="radio"/>								
ABS plastic housing	<input type="radio"/>								
Gap sensor	<input type="radio"/>								
Ribbon sensor	<input type="radio"/>								
The print head open sensor	<input type="radio"/>								
USB 2.0(full speed)Communication interface	<input type="radio"/>								
2 MB SDRAM Memory	<input type="radio"/>								
2 MB FLASH Memory	<input type="radio"/>								
Feed button & LED indicator	<input type="radio"/>								
Built-in 8 kinds of dot matrix fonts	<input type="radio"/>								
The character and the bar code can be printed in four directions (0,90,180,270 degree).	<input type="radio"/>								
Built in simplified Chinese, traditional Chinese and Korean font for programming.	<input type="radio"/>								
Can print text, bar code, pictures									
<table border="1"> <thead> <tr> <th colspan="2">Support bar code</th> <th>Support picture</th> </tr> </thead> <tbody> <tr> <td>1D Barcode</td> <td>2D Barcode</td> <td rowspan="2">BMP, PCX</td> </tr> <tr> <td>Code 39 Code 93,ITF, EAN 128, Code 128 subsets A,B,C, Codabar, EAN-8,EAN-13, UPC-A,UPC-E, EAN and UPC 2(5) digits add-on,MSI,MSIC, PLESSEY,CPOST, ITF 14,EAN 14</td> <td>QR code</td> </tr> </tbody> </table>		Support bar code		Support picture	1D Barcode	2D Barcode	BMP, PCX	Code 39 Code 93,ITF, EAN 128, Code 128 subsets A,B,C, Codabar, EAN-8,EAN-13, UPC-A,UPC-E, EAN and UPC 2(5) digits add-on,MSI,MSIC, PLESSEY,CPOST, ITF 14,EAN 14	QR code
Support bar code		Support picture							
1D Barcode	2D Barcode	BMP, PCX							
Code 39 Code 93,ITF, EAN 128, Code 128 subsets A,B,C, Codabar, EAN-8,EAN-13, UPC-A,UPC-E, EAN and UPC 2(5) digits add-on,MSI,MSIC, PLESSEY,CPOST, ITF 14,EAN 14	QR code								
	<input type="radio"/>								

2.1.2 Optional accessories

External stand is standard accessory for GP-9035T, optional for GP-9034T.

2.2 Specifications

Printer size	186(W)x180(H)x290(D)
Printer weight	2.4KG
Power Supply	Input: AC 100-240V Output: DC 24V 2A
Environment	Storage Environment: -10~50°C (-10~140°C), Humidity:10~90%,no condensation Operation Environment:5~45°C(41~104°C), Humidity:25~85%,no condensation

2.3 Printing specification

Model	GP-9034T	GP-9035T
The print head	300 dots/inch(12dots/mm)	
Print mode	Ribbon / thermal	
Dot size (widthxlength)	0.084 × 0.084 mm (1 mm = 11.8 dots)	
Print speed (inches per second)	2~4 inch/s	2~5 inch/s
Maximum print width	81 mm(3.18")	
Maximum print length	1524 mm(60")	1651 mm(65")
Pulse excitation	1X10 ⁸ pulses	
Thermal print head reliability	50km	

2.4 Ribbon specification

Ribbon diameter	Max. 67 mm
The ribbon length	300 m
The ribbon axis size	1 inch (25.4 mm)
The ribbon width	Max. 90 mm
	Min. 30 mm
Ribbon winding way	Outward winding

2.5 Paper specification

Model	GP-9034T	GP-9035T
The maximum capacity of internal paper roll diameter	127 mm(5") OD	
Paper type	Continuous paper , paper with interspaces , folding paper ,sprocket paper	
The paper winding way	Printing side outward or inward winding	
The width of the paper (upper & bottom paper)	Max. 90 mm(3.54")	
	Min. 20 mm(0.78")	
The thickness of the paper (upper & bottom paper)	Max.0.254 mm(10 mil)	
	Min.0.06 mm(2.36 mil)	
Roll axis size	25.4 mm~38 mm(1"~1.5")	
Label length	10~1524 mm(0.39"~60")	10~1651 mm(0.39"~65")
	Note : If label length less than 25.4mm(1 inch),label paper with perforations are recommended, labels can be torn off easily.	
Gap size	Min.2 mm(0.09")	

3. Specification:

- ★ 300dpi High resolution, 5 inch/sec high print speed.
- ★ 90mm width paper exit design for more label options.
- ★ Completely new motherboard with 4 interfaces to meet different connection need.
- ★ Newly added thermal transfer printing method, consumer option more flexible, storage period more longer.
- ★ Separate mechanism structure, compact and practical, support Thermal transfer and direct thermal line printing.
- ★ Large gear in mechanism and newly designed transmission system, enable paper roll to feed more smoothly.
- ★ External paper holder are optional for $\Phi 8.4$ " industrial-grade large roll.
- ★ Built with 2-motor gear-driven engine, GP-9035T is able to handle 300 meters long ribbon and big label roll.

	GP-9034T	GP-9035T
Resolution	300 dpi	300 dpi
Print speed	2~4 inch/s	2~5 inch/s
Dot density	300 dots/inch(12dots/mm)	300 dots/inch(12dots/mm)
Print method	Ribbon/Direct thermal line	Ribbon/Direct thermal line
Dot size	0.084×0.084 mm (1 mm = 11.8 dots)	0.084×0.084 mm (1 mm = 11.8 dots)
Interface	USB+Serial+Parallel	Ethernet+USB+Serial+Parallel
Print width(max.)	81mm(3.18")	81mm(3.18")
Print length(max.)	1524mm(60")	1651mm(65")
Ribbon diameter	Max. 67mm	Max. 67mm
Ribbon length	300m	300m
Ribbon core size	1 inch (25.4 mm)	1 inch (25.4 mm)
Ribbon width	Max.90mm , Min.30mm	Max.90mm , Min.30mm
Ribbon rolling up method	Outward rolling	Outward rolling
Paper roll diameter (Max.)	127 mm(5")OD	127 mm(5")OD
Paper type	Continuous, gap, folded, punched	Continuous, gap, folded, punched
Paper rolling up method	Printing side outward rolling / inward rolling	Printing side outward rolling / inward rolling
Paper width (Label+backing sheet)	Max.90 mm(3.54") Min.20 mm(0.78")	Max.90 mm(3.54") Min.20 mm(0.78")
Paper thickness (Label+backing sheet)	Max.0.254 mm(10 mil) Min.0.06 mm(2.36 mil)	Max.0.254 mm(10 mil) Min.0.06 mm(2.36 mil)
Paper roll core size	25.4 mm~38 mm(1"~1.5")	25.4 mm~38 mm(1"~1.5")
Paper gap	2 mm(0.09") min.	2 mm(0.09") min.
Label length	10~1651 mm(0.39"~65")	10~1524 mm(0.39"~60")
Remark: If label length less than 25.4mm(1 inch), label paper with perforations are recommended, labels can be torn off easily.		
Dimension	186(W)*180(H)*290(D)	
Weight	2.4KG	
Work environment	Temperature 5~45℃ ; Humidity 25~85%	
Storage environment	Temperature -10~50 ℃ ; Humidity 10~90%	
Power	Input: AC 100V/240V , Output: DC 24V/2A	
Accessories	Extenal-holder as option	Extenal-holder as standard accessory
Mechanism Reliability	50km	

4. Printer Introduction

(a.) Open and check

This series printer is with special package to prevent damage in transportation. If there is any unexpected damage occurred, please put in clean and stable surface and carefully open the package to check, inform local distributor with damage details, and keep packing materials well in case you need to mail the printer.

Packing list:

- ◆ One Label printer
- ◆ CD (Driver, Nice label software)
- ◆ Power Adapter
- ◆ Power Cord
- ◆ USB cable (Parallel cable, serial cable optional)
- ◆ Ribbon roller & Ribbon
- ◆ Label roller & Label paper
- ◆ External paper holder (Standard for GP-9035T)

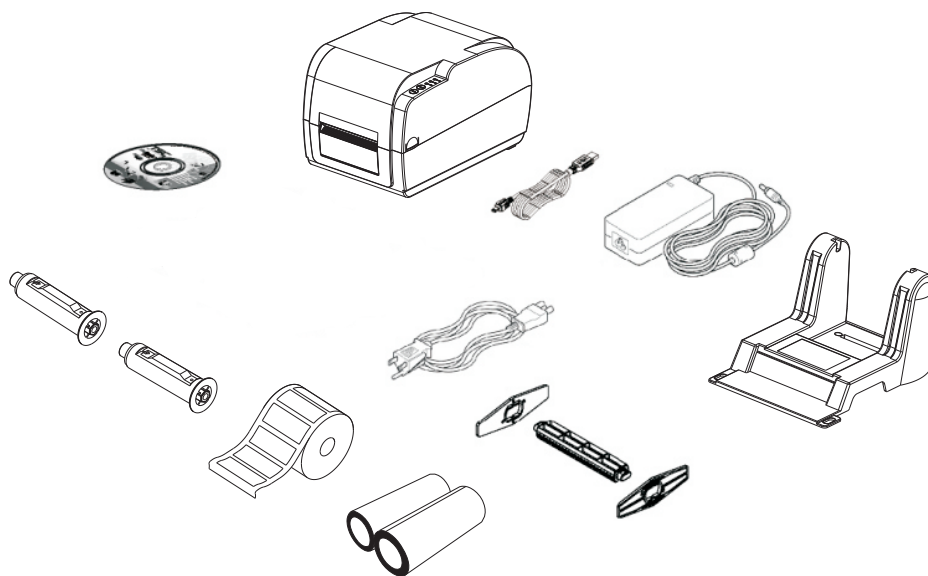

<Picture 1>

(b.) Printer components

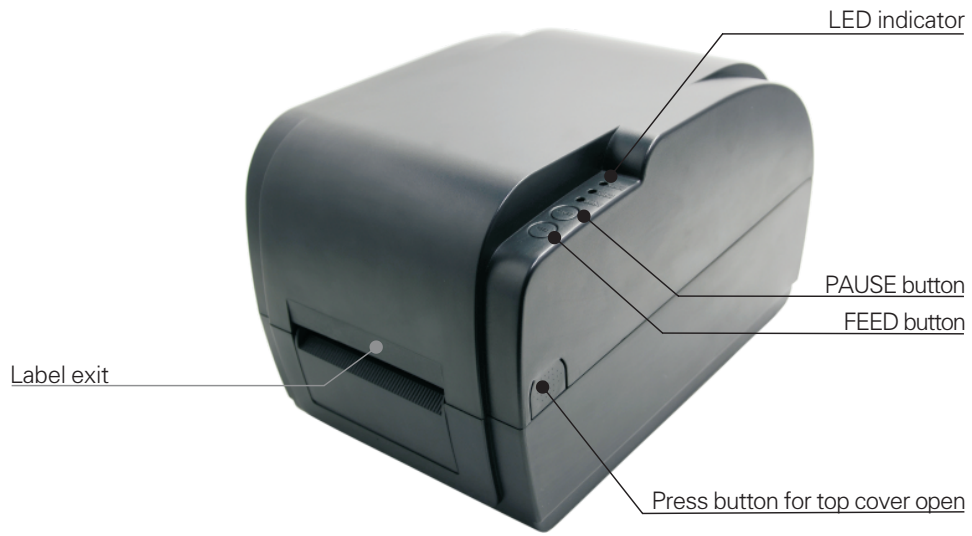

<Picture 2>



<Picture 3>

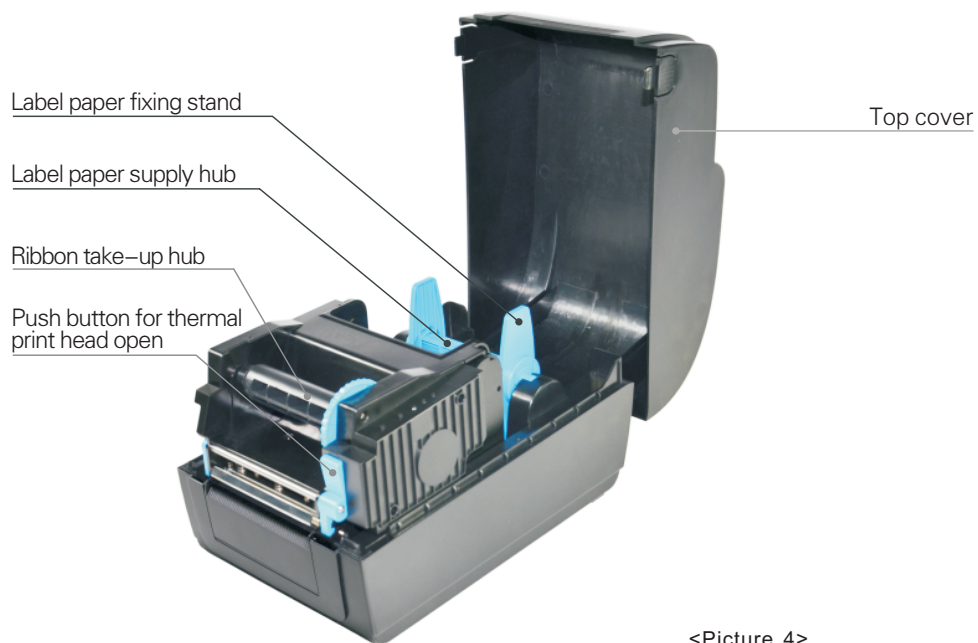

<Picture 4>

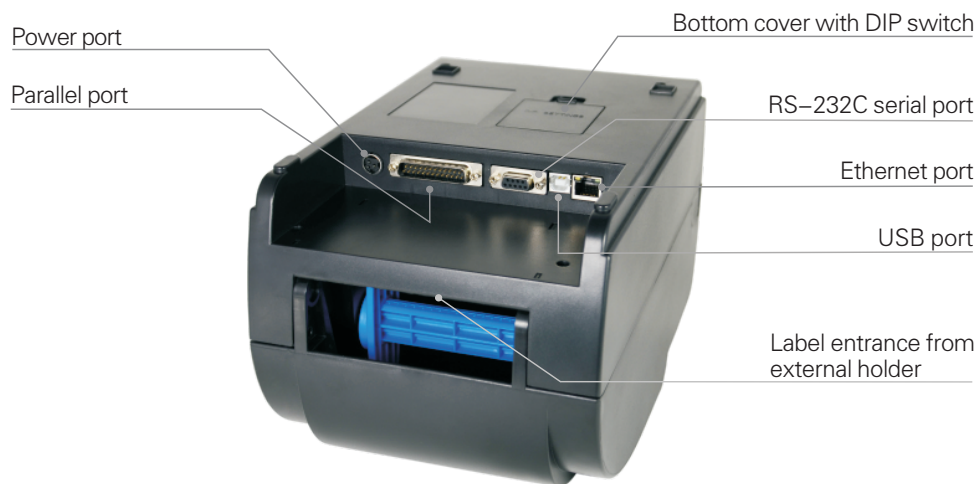

<Picture 5>

Note: Picture showing printer port is for GP-9035T.

5. Installation

(a.) Cable connection

1. Please put the printer on the stable surface.
2. Make sure printer power is turned off, please do not plug the power cable when the printer power is turned on.
3. Connect serial or USB or Parallel or Ethernet cable to printer and PC.
4. Connect power plug to power supply socket.

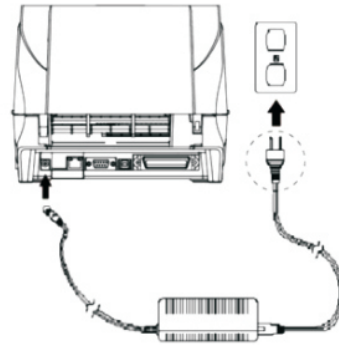

<Picture 6>

(b.) Ribbon installation

	<ol style="list-style-type: none"> 1. Press two press buttons on left and right side to open printer top cover.
	<ol style="list-style-type: none"> 2. Put empty paper tube into ribbon take-up hub if you buy new ribbon which one side is no contact with paper tube. After that, install ribbon take-up hub left side and right side onto printer.
	<p>Remark: Factory standard ribbon two sides already fixed well on paper tube. Go ahead to step 3 instead of step 2.</p>
	<ol style="list-style-type: none"> 3. Press the Push button to open print head.
	<ol style="list-style-type: none"> 4. Insert black ribbon supply hub into new ribbon. Then install ribbon and supply hub from left side to right side, refer to picture.
	<ol style="list-style-type: none"> 5. If install factory supplied new ribbon, please refer to step 2: install ribbon and ribbon take-up hub. If you buy and use new ribbon, firstly you roll up the ribbon onto the empty paper tube.
	<p>After that please adjust the big blue gear according to the direction of arrows to let ribbon touch the take-up hub flatly and smoothly without wrinkle.</p>
	<ol style="list-style-type: none"> 6. Close the print head by pressing two arrow locations, Confirm print head two sides are closed correctly to ensure you get printing in good quality.

● Ribbon installation diagram

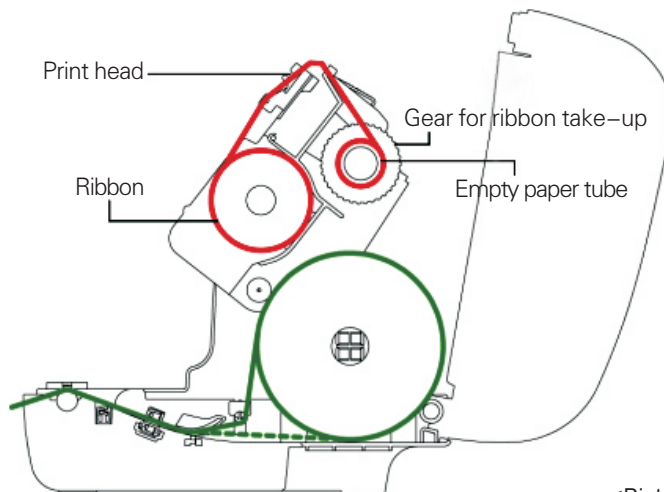

<Picture 7>

(c.) Paper installation

	<p>1. Open printer top cover; Insert blue label supply hub into label roll and fix onto printer.</p>
	<p>2. Press Push button to open print head to install label paper same as picture showing.</p>
	<p>3. Close the print head by pressing two arrow locations. Confirm print head two sides are closed correctly to ensure you get printing in good quality.</p>
	<p>4. Close printer top cover.</p>

● Paper installation diagram

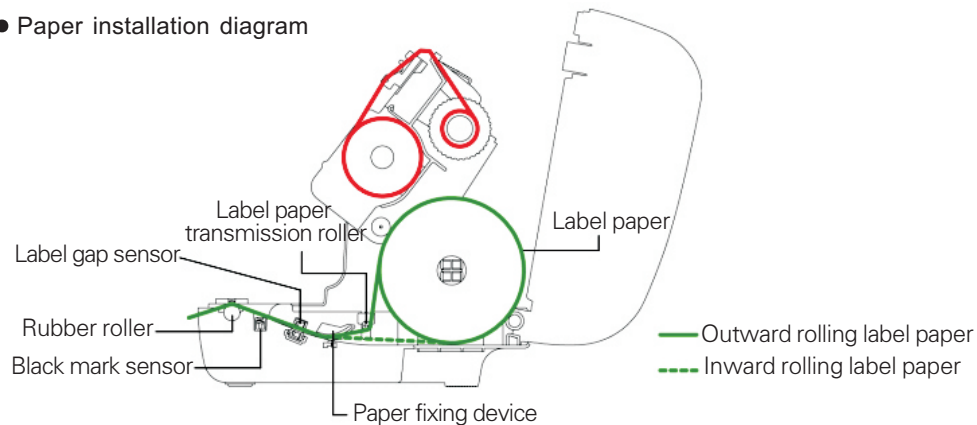

<Picture 8>

6. LED Indicator and Function

There' re two buttons and three LED indicators, many functions can be realized through using different button, indicator and power on/off switch.

6. 1 LED indicator

6. 1. 1 Direct thermal printing method

LED Indicator status	Descriptions
Power indicator is on, Error indicator is off	Printer is powered on and in normal printing status
Power indicator flashes every 640ms, Error indicator is off	Printer is paused
Power indicator is off, Error indicator goes on for 80ms, then goes off for 160ms, printer start beeping.※	Printer cover is opened
Power indicator is off, Error indicator goes on for 500ms, then goes off for 6s	Label gap detection error
Power indicator is off, Error indicator flashes every 160ms, after two times flashing, Error indicator goes off for 320ms, printer start beeping. ※	Paper out
Power indicator is off, Error indicator flashes every 160ms, after three times flashing, Error indicator goes off for 320ms, printer start beeping. ※	Black mark detection error
Error indicator flashes every 160ms.	Printer overheated protection mode is activated. After 1 minute, the printer CPU will check print head temperature again. When temperature return normal, printer will work normally.

※ Beeper function can be enabled through setting DIP switch.

6. 1. 2 Thermal transfer printing

LED Indicator status	Description
Ribbon indicator is on	Ribbon is installed successfully
Ribbon indicator flashes every 300ms, beeper sounds every 2.4s ※	Ribbon improperly installed: no ribbon, or ribbon end, or ribbon broken

※ Beeper function can be enabled through setting DIP switch.

6. 2 Button Function

6.2.1 FEED button

When the printer is ready (Blue LED lights), press FEED button , label will feed one by one.

6.2.2 Printing pause

when you press PAUSE button during printing is in progress, printing job will be paused, At this moment, POWER indicator will flash, again press PAUSE button, printing job will continue.

6. 3 Power on Function

Power on functions can be used to set or test printer hardware and enabled by pressing different buttons and checking different LED indicators while you turn on the printer power, please follow below instructions:

Function	Descriptions
Self-test page	<p>A.Turn off the printer. B.Make sure the paper roll is installed correctly and the printer top cover is closed. C.Press and hold FEED button and turn on the printer. Self-test page will be printed, then release FEED button.</p> <p>Note: You can use this function to check if printing function is normal or not.</p> <p style="text-align: right;"><Please see page 12, page view of self></p>
Print DIP Switch page	<p>A.Turn off the printer. B.Make sure the paper roll is installed correctly and the printer top cover is closed. C.Press and hold PAUSE button and turn on the printer. When paper is feeding and then release PAUSE button, DIP switch functions details will be printed out.</p>
Debugging Mode	<p>A.Turn off the printer. B.Make sure the paper roll is installed correctly and printer top cover is closed. C.Press and hold PAUSE and FEED button, and turn on the printer. When Power indicator(blue) and Error indicator (red) are on at the same time, release PAUSE and FEED button, printer goes to Debugging Mode, and you will find below page printed out:</p> <div style="border: 1px solid black; padding: 10px; margin: 10px auto; width: fit-content;"> <pre>***** * NOW IN DUMP MODE * *****</pre> </div> <p>Please put 3" label paper, all label data received in this mode will be printed by machine code. Right side is ASCII character strings, left side are hexadecimal value of ASCII character strings. This function is for user or engineer to debug the program. If you turn off printer and then turn on, printer will go back to normal printing mode.</p>

SELFTEST

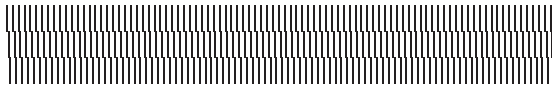

MODEL:GP-9034T
 VERSION:V1.1(2014-04-28)
 INTERFACE:USB & SERIAL & PARALLEL
 SERIAL PORT:SERIAL 9600,N,8,1
 LABEL VALUE: MAX=783 MIN=771 VAL=230
 SPEED:4
 DENSITY:7
 SIZE: 80mm,40mm
 GAP : 0mm,0mm
 CODE PAGE:437
 MILAGE(m): 118.9876543
 REFERENCE:0 mm , 0 mm
 DIRECTION:0 , 0
 SHIFT:0
 OFFSET:0
 SET PEEL:OFF
 SET TEAR:ON
 SET HEAD:ON
 SET PRINTKEY:OFF
 SET REPRINT:OFF
 SET KEY1(FEED):ON
 SET KEY2(PAUSE):ON
 TAIWANESE BIG5:TST24.BF2
 CHINESE GB2312:TSS24.BF2
 KOREAN KSC5601:K
 BEEPER: ENABLED
 RIBBON ROLL POWER:NORMAL
 RIBBON END DECTECT:ENABLE
 GAP SENSOR SENSITIVITY:NORMAL

DRAM FILE:	0	FILE (S)	
FLASH FILE:	0	FILE (S)	
SECTOR SIZE:	4	KB	
PHYSICAL DRAM:	2048	KBYTES	
AVAILABLE DRAM:	1024	KBYTES	FREE
PHYSICAL FLASH:	2048	KBYTES	
AVAILABLE FLASH:	1024	KBYTES	FREE

<Picture 9>

SELFTEST

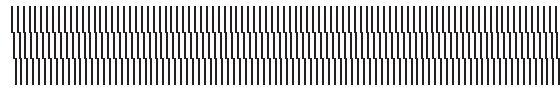

MODEL:GP-9035T
 VERSION:V1.0 (2014-02-20)
 INTERFACE:USB & SERIAL &
 ETHERNET(10BASE/100BASE)
 SERIAL PORT:SERIAL 9600,N,8,1
 ETHERNET PROTOCOLS:TCP/IP
 MAC ADDRESS:0-71-80-100-40-124
 IP ADDRESS:192.168.123.100
 GATE WAY:192.168.123.1
 NETMASK:255.255.255.0
 DHCP MODE: DISABLED
 DHCP TIMEOUT(S) : 90
 LABEL VALUE:MAX=880 MIN=877 VAL=298
 SPEED:3
 DENSITY:7
 SIZE:80 mm , 40 mm
 GAP:0 mm , 0mm
 CODE PAGE:437
 MILAGE(m):14.8765432
 REFERENCE:0 mm , 0 mm
 DIRECTION:0 , 0
 SHIFT:0
 OFFSET:0
 SET PEEL:OFF
 SET TEAR:ON
 SET HEAD:ON
 SET PRINTKEY:OFF
 SET REPRINT:OFF
 SET KEY1(FEED):ON
 SET KEY2(PAUSE):ON
 TAIWANESE BIG5:TST24.BF2
 CHINESE GB2312:TSS24.BF2
 KOREAN KSC5601:K
 BEEPER: ENABLED
 RIBBON ROLL POWER:HIGH
 RIBBON END DECTECT:ENABLED
 GAP SENSOR SENSITIVITY:NORMAL

DRAM FILE:	0	FILE (S)	
FLASH FILE:	0	FILE (S)	
SECTOR SIZE:	4	KB	
PHYSICAL DRAM:	2048	KBYTES	
AVAILABLE DRAM:	1024	KBYTES	FREE
PHYSICAL FLASH:	2048	KBYTES	
AVAILABLE FLASH:	1024	KBYTES	FREE

<Picture 10>

Skip AUTO.BAS program	<p>User can use TSPL2 command to save a code auto–running file (AUTO.BAS) into flash. When turn on printer, printer will run the program automatically.</p> <p>If you want to skip AUO.BAS program on power–up, then follow below steps:</p> <p>Press and hold PAUSE and FEED button, then turn on the printer. When Power indicator (blue) is off and Error indicator(red)is on, release PAUSE and FEED button, printer will skip running AUTO.BAS program, and then Power indicator will be on.</p>
Ribbon Detection	<p>When printer power turn on, printer will automatically detect ribbon status, to check if ribbon installed, or ribbon end, or work normally. After ribbon detecting, printer will be set to thermal transfer printing mode or direct thermal printing mode. If no ribbon, system will go to direct thermal printing mode and close ribbon rolling motor function.</p>
Printer Initialization	<p>A. Turn off the printer. B. Press and hold PAUSE and FEED button, then turn on the printer. When Power indicator(blue)is on and Error indicator (red) is off, release PAUSE and FEED button, all data in printer DRAM will be cleared and printer setting will be restored to factory default setting. Then power indicator will be on and printer goes to ready status.</p> <p>Note: Factory default settings do not include ribbon setting.</p>

* The printer default values are as below.

Parameter	Default setting
Speed	4inch/sec (101.6mm/sec), 300dpi
Density	7
Gap	0mm
Direction	Printing content are placed on page from top to bottom
Reference	Top left corner from printing direction
SHIFT	0
OFFSET	0
SET TEAR	ON
SET HEAD(Cover open detect)	ON
Set PRINTKEY	OFF
SET REPRINT	OFF
SET KEY1(FEED)	ON
SET KEY2(PAUSE)	ON
CLEAR RAM	CLEAR
CLEAR FLASH	NOT CLEAR

Troubleshooting

Below table contains common problem descriptions and the solution which we can use in daily operation. If you follow below method and the failures still do not remove, please contact the local distributor or factory for further support.

Problems	Possible Reasons	Solution and Suggestion
Power indicator not "ON"	Plug to AC outlet and plug to printer not well connected	Check power connector and AC outlet if plugs are correctly connected
	Printer power not turned on	Turn on power switch
	Print head not well closed	Close print head by pressing whole print head mechanism (or 2 arrow locations)
	Ribbon end	Change new ribbon
	Ribbon improperly installed	Refer to Ribbon Installation steps in User Manual to re-install ribbon
	Label paper end	Change new label paper
	Label paper improperly installed	Refer to Paper Installation steps in User Manual to re-install paper
	Label paper jammed inside printer	Adjust paper specification and print again
Not printing	Gap sensor detection error	Clear jamed paper
	Serial cable improperly connected	<ol style="list-style-type: none"> 1. Check if Pin configuration in cable two sides are matching each other; 2. Check if baud rate setting on PC and printer are the same, If in TPSL comma -nd mode, We suggest 9600, n, 8, 1 to ensure higher reliability. 3. Change a new cable.
	Ethernet cable improperly connected	<ol style="list-style-type: none"> 1. Check if RJ-45 green/orange LED indicator is on. When printer receive and process printing data, LED will be orange color; 2. Check if printer IP is assigned in DHCP mode. 3. Check if fixed IP address is correctly set in printer property. Wait for some minutes to make sure printer is connect -ed server and printing a selftest page to confirm printer IP address. 4. Change a new ethernet cable.
	USB cable improperly connected	Check if USB cable connected well or change a new cable
	Ribbon non standard	Check if ribbon model and specification

Not printing	Ribbon printing side wrong installed	Check and re-install ribbon to make sure printing side touch label paper
	Print head not clean	Clean print head and print again
	Print density setting wrong	Suggest density set to be 7
	Print head cable not well connected	Re-connect print head cable
	Step Motor cable not well connected	Re-connect step motor cable
	Command setting wrong	Check if there is PRINT command at the end of printing file; or if there is CRLF command at the end of every line.
Not good printing quality	Ribbon and label improperly installed	Re-install ribbon and/or label
	Too much dust or adhesive on print head	Clean print head and print again
	Print head damaged	Take selftest page to check if printing are completely to confirm if necessary to change new print head
Data miss printing in one or two sides	Label paper size wrong setting	Check if label size set correctly and same as your label paper
Ribbon wrinkle	Print head unbalanced stress; ribbon & label improperly installed; Label feeding not smoothly	Reset the label print density and adjust paper width fixing stand to fit your label paper size.
Printing not stable	Printer in HEX Dump mode or RS-232 setting wrong	Restart your printer and leave Dump Mode or reset RS-232 PARAMETER

7. Maintenance

7.1 Printer Cleaning

To ensure the printing quality, please proceed this maintenance section to keep your printer in good conditions and extend its life as well.

Please use one of following material to clean the printer.

- ★ Cotton swab
- ★ Lint-free cloth
- ★ Vacuum cleaner or air brush
- ★ 100% ethanol

7.2 The cleaning process is described as following:

Parts to be cleaned	Step	Recommend cleaning frequency
Print head	1. Turn off the printer. 2. Allow the print head to cool for at least one minute. 3. Use a cotton swab and 100% ethanol to clean the print head surface.	When change new label paper
	<p>The diagram illustrates two types of thermal transfer printing heads. On the left is a 'Direct thermal printing head' which has a single nozzle. On the right is a 'Thermal transfer printing head' which has multiple nozzles. Labels with leader lines point to each type of head.</p>	
Rubber roller	1. Turn off the printer. 2. Rotate the platen roller and use a cotton swab to clean with 100% ethanol.	When Change new label paper
Paper tear bar	Use a cotton swab and 100% ethanol to clean.	When necessary.
Sensor	Use air brush or vacuum to clean dust of sensor.	Monthly.
Inner side of printer	Use air brush or vacuum to clean the dust.	When necessary.

Note:

- ※ Always turn off the printer power before cleaning the printer.
- ※ Do not touch print head by finger.
- ※ Please use 100% ethanol, Do not use medical alcohol to avoid damage to print head.

