

# User manual

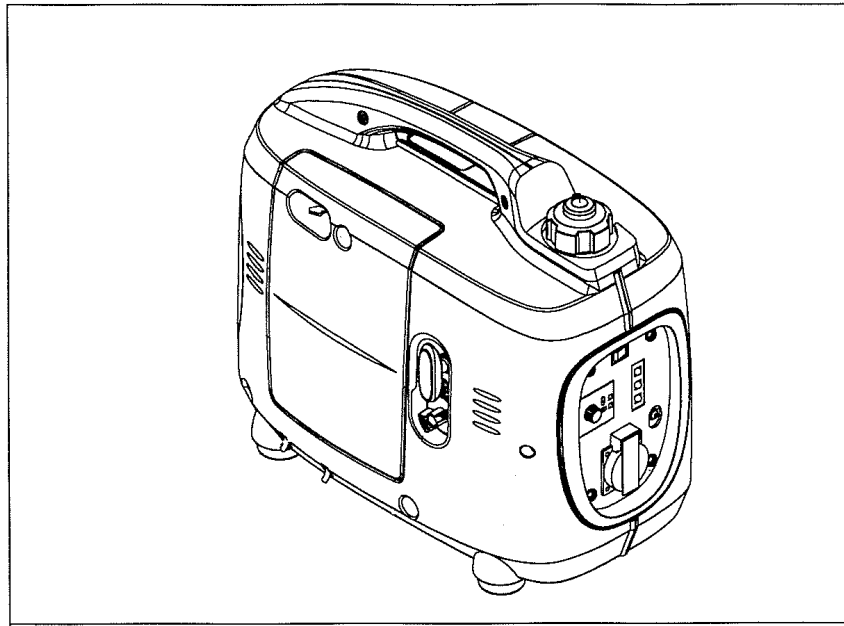

B950i, B1000i, B2000i, B3000i



- Always read the user manual thoroughly before using the generator.
- Never use the generator in a closed room/area. Exhaust may cause suffocation.
- The exhaust pipe becomes very hot during operation. Do not touch the exhaust pipe after use.
- Only use approved cables.
- Fuel is very flammable, be careful when filling with gasoline. Do not fill when you are close to open fire, lighted cigarettes, sparks or similar. Always clean up spilled gasoline.
- Standby power generators for buildings must only be connected by an authorised electrician, who must comply with the regulations in question. Incorrect connection can make the power/electricity run back to the generator. This can cause an electric shock if a person gets in contact with the generator. After the power has been restored the generator may explode, burn or cause a burn in the electric system.
- Always inspect all connections before you start the machine. This can prevent an accident.
- Always place the generator 1 meter away from buildings or other equipment during operation.
- Only use the generator on a horizontal surface.
- Draw attention to how the generator is to be stopped and understand all its functions. Never leave the use of the generator to persons who has not received any instruction about the operation.
- Keep children away from the generator during operation.
- Using the generator with wet hands may lead to electric shock.
- Never use the generator in rain or snow. Always make sure that the generator does not become wet.

**NOTE** If you are going to use the generator in thin stratum of air, higher than 1500 meter above water surface you shall contact your dealer for guidance.

## 1. Contents

---

1. Contents .....	21
2. Identification of components .....	22
3. Automatic current control (SMART) .....	22
4. Before start - Oil .....	23
4.1. Before start - gasoline .....	24
4.2. Before start - air filter .....	24
5. Start .....	25
6. Operation of the generator .....	27
6.1. Alternating current .....	27
6.2. Indicators .....	28
6.3. Direct current .....	28
6.4 Oil warning .....	30
6.5 Stop .....	30
7. Maintenance .....	31
7.1 Changing oil .....	31
7.2 Air filter .....	32
7.3 Spark plug .....	33
8. Transport and storage .....	33
9. Specifications .....	35
10. Trouble shooting .....	36

### **Spare parts**

Part list and explosive drawings for the specific product, please contact your dealer.

If you help find part numbers yourself, it will ease the service.

For purchase of spare parts, please contact your dealer.

## 2. Identification of components

---

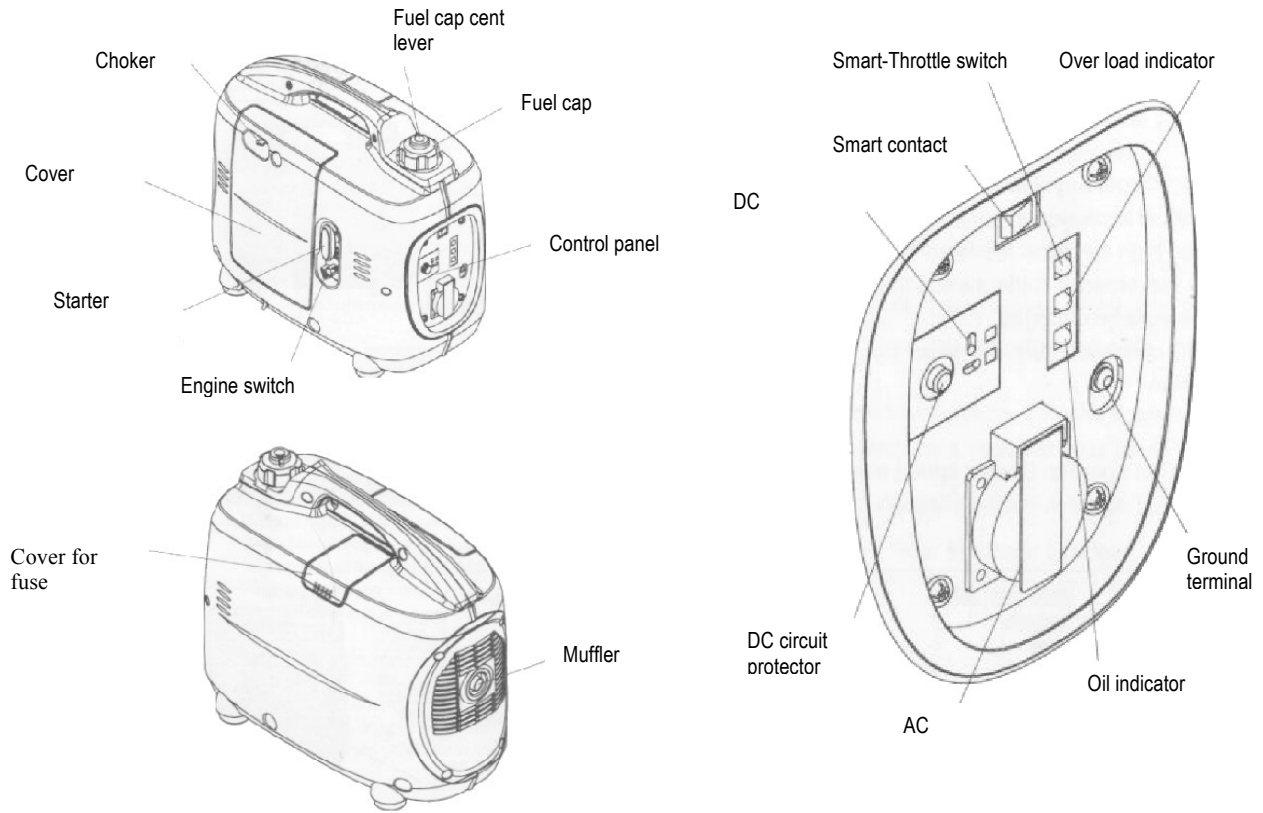

## 3. Automatic current control (SMART)

---

The engine speed is automatically adjusted, when the current is disconnected. The same way the speed goes up when you connect the current. This ensures the fuel consumption being held at a minimum.

**Warning** - The automatic regulation does not work effectively if an even electric current is needed.

**Warning** - When the generator is to produce a heavy, even current you shall place the switch in the OFF position in order to reduce changes in the current.

**Warning** - When you work with DC (Direct Current), always place the switch in the OFF position.



## 4. Before start - Oil

### NOTE

- Always inspect the generator on a horizontal surface with a turned-off engine.
- The in-built alarm system will automatically stop the engine before the oil level drops under the approved level. In order to avoid unpredicted disconnection you shall check the oil level regularly.
- Using the generator with too little oil can cause severe damages to the wear parts of the engine.

Use full-synthetic premium 4-stroke oil, which meets the demands in question.(API)

Loosen the screws that tighten the plate on the backside of the generator and remove the plate. Check the oil level by removing the oil stick, clean it with a dry clean cloth. Insert the oil stick without screwing it in. See the oil level on the stick. Fill with oil if necessary.

Oil capacity: 0,25/0,40 L.

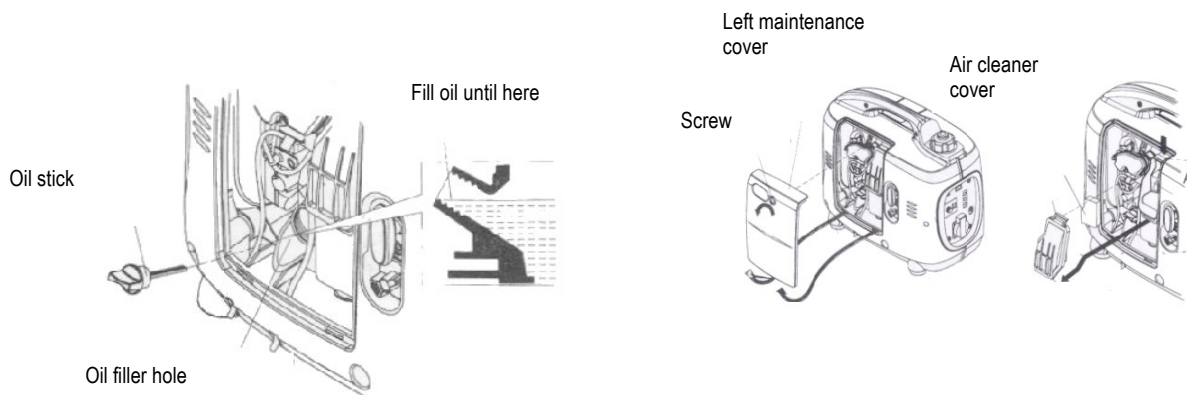

#### 4.1. Before start - gasoline

---

- Use regular unleaded 95 octane gasoline.
- Avoid getting dust, dirt or water in the tank.
- After filling, fasten the tank cover securely.
- Only fill fuel to the indicated marking (see figure below).

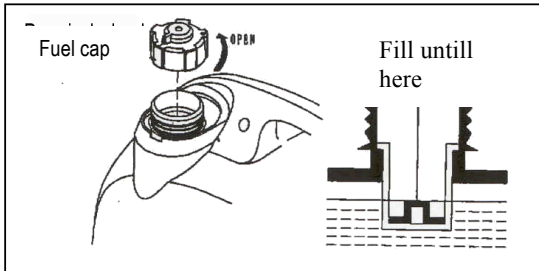

#### NOTE

- By transport you always turn the upper part of the gasoline cover to the "OFF" position.

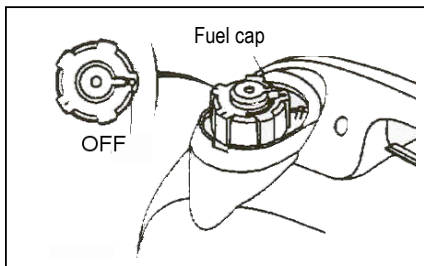

#### 4.2. Before start - air filter

---

Check that the air filter is clean and in good shape.

#### PROCEDURE

Loosen the screws that fasten the plate on the backside of the generator and remove the plate. On the top of the air filter a tap is placed, press this down and the air filter is loosened. Check the filter and clean it, replace if necessary.

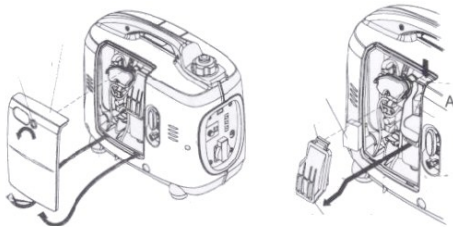

#### WARNING

Never use the generator without an air filter. This will result in dirt being drawn into the carburettor of the engine.

## 5. Start

### WARNING

Disconnect all machines connected to the generator before starting.

### WARNING

Before use the generator must be grounded. Connect the ground take off on the generator with a frame connection e.g. an earth auger.

1

Turn the upper part of the fuel cover clockwise to the "ON" position.

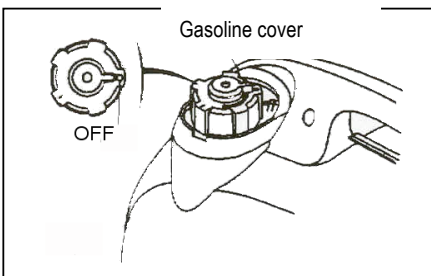

2

Turn the ignition switch to the "ON" position.

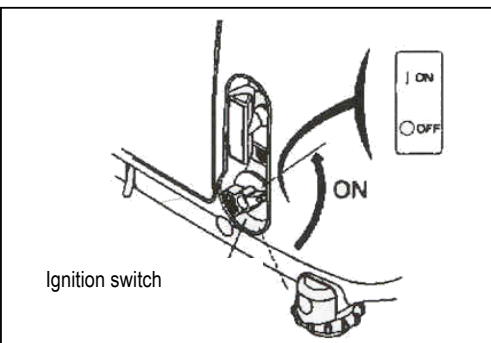

3

Place the choke of the machine in open position. To the right.

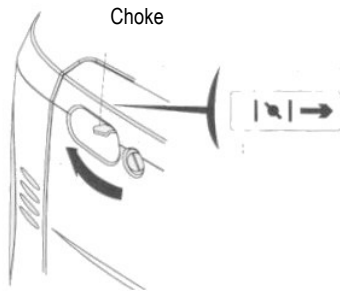

4

Pull slowly in the starting cord of the engine until you feel resistance. Then you pull one heavy long draw. Never let the starting cord run back by itself, always follow it with your hand.

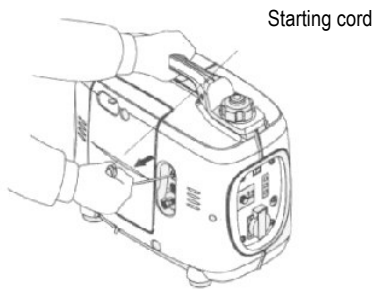

5

Close the choke by placing it in the right position while the engine is warming up.



## 6. Operation of the generator

---

### WARNING

In order to prevent electric shock, the generator must be grounded. This is done by connecting the frame take off of the generator with a frame connections e.g. an earth auger.

### NOTE

- Do not exceed the voltage limit stated for a regular plug.
- Do not connect the generator to a closed system in e.g. a house. This may cause damages on both the circuit and the generator.
- Do not make any amendments to the generator.
- Do not connect more generators in a parallel connection.
- Do not extend the exhaustion on the generator.
- By using an extension cord you shall use a heavy and flexible cable.
- Maximum length of extension cords:
  - 1.5 mm<sup>2</sup> = 60 meters
  - 2.5 mm<sup>2</sup> = 100 meters
- During operation you must not place the generator close to any other electrical cables.
- The DC exit can be used together with the AC exit, but draw attention to the current intensity being able to vary if the load is too high.

## 6.1. Alternating current

---

### PROCEDURE

1. Start the generator and note that the green light in the panel goes green.
2. Make sure that the apparatus you want to use has been turned off.
3. Insert the plug into the generator.
4. Turn the apparatus on\*.

### NOTE

- Continued overload of the generator (indicated by a red light) can damage the generator and shorten the life of the engine.
- Always inspect that the receiver apparatus works and is in good shape before use.
- If the apparatus starts performing irregularly or if the engine suddenly stops during operation you shall stop the generator and disrupt the current by removing the plug from the generator.

## 6.2. Indicators

---

1

- The running indicator will be lit during regular running (green light).
- If the generator is overloaded the green light will turn itself off and the red indicator for overload will be lit. At the same time the current for the apparatus will be disconnected. In this case you must stop the generator and inspect it for the source of the overload.

2

When starting the generator it may occur that both the green as well as the red indicator is lit. The red indicator should turn itself off in a few seconds. If not you must stop the generator and inspect it for the source of the overload. You can also contact your dealer.

3

When starting if the green indicator is not lit, but the red indicator is, you must stop the generator and retry.

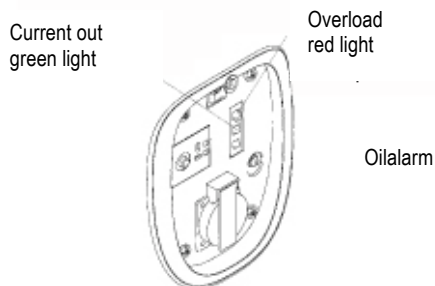

## 6.3. Direct current

---

- 6.3.1 Connect the charging cables on the DC take-off on the generator to the correct poles as shown on the drawing.

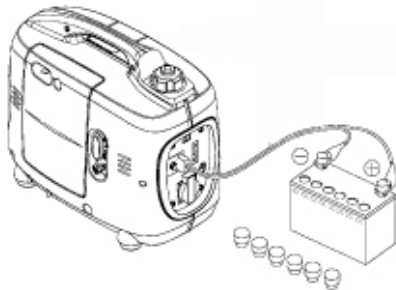

NOTE: Avoid 12 volt charging directly to batteries as this may cause overheating of the battery. Texas recommend only to use a 230 volt battery charger. Charging of batteries should only be done in ventilated places due to risk of sparkling gasses.

- 6.3.2 Start the generator.  
The take off for alternating current can be used with the direct current take-off.

**NOTE**

12 V take-off on the generator must only be used for charging 12 V automobile batteries.  
By use of direct current take off the automatic current control must be turned off.

**WARNING**

- In order to prevent the possibility of a spark close to the battery, you must first connect the charging cable to the generator and thereafter to the battery.  
When dismounting, start by dismounting the battery.
- When charging batteries which are still mounted in cars, it is important that the frame cable has been removed from the pole of the battery. After charging the frame cable is mounted on the correct pole.
- This procedure prevents the risk of a short circuit between generator and the chassis of the car.

**NOTE**

- Do not try to start a car while the generator is connected to the battery of the car. The generator may be damaged.
- Always check that the generator has been correctly connected to the battery.

**WARNING**

Always respect the indicated instructions for use of battery

## 6.4 Oil warning

There is an inbuilt oil alarm on the generator. This means that if the generator is lacking oil during operation the generator will stop automatically. At the same time the oil lamp in the panel will be lit.



## 6.5 Stop

### NOTE

In case of emergency the generator can be turned off on the ON/OFF switch on the side of the generator.

1

Turn the apparatus off and remove the plug from the generator.

2

Turn the generator off on the ON/OFF switch on the side of the generator.

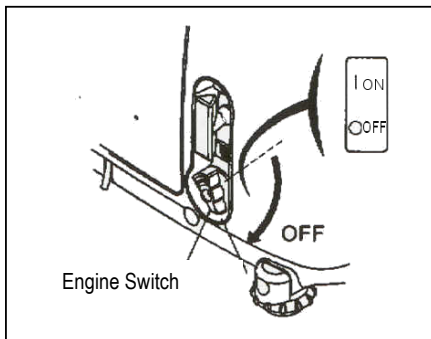

3

Turn the upper part of the gasoline cover anti-clockwise to the "OFF" position.

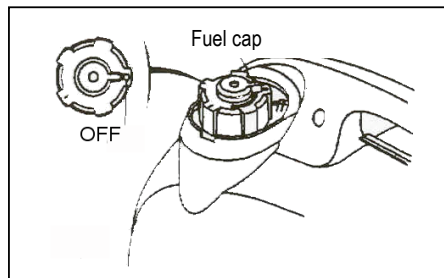

## 7. Maintenance

---

### NOTE

- The purpose of the maintenance is to keep the generator in its best possible shape.
- Repairs should always be carried out by an authorized Texas Power Line dealer.

Part		Every use	1. month or 10 hours	every 3. month. or 50 hours	every 6. month. or 100 hours	every year or 300 hours
		<b>Oil</b>	<i>Check</i>	X		
	<i>Replace</i>		X		X	
<b>Air filter</b>	<i>Check</i>	X				
	<i>Clean</i>			X1		
<b>Sparking plug</b>	<i>Clean – adjust</i>				X	
<b>Sparking plug – spark screen</b>	<i>Clean</i>				X	
<b>Gasoline- tank / filter</b>	<i>Clean</i>					X
<b>Gasoline hose</b>	<i>Check</i>	Every 2nd year (replace if necessary)				

Check should be carried out more often if the generator is being used in dusty areas.

### 7.1 Changing oil

---

### WARNING

The ignition switch and upper part of the gasoline cover of the generator must always be in the OFF position when changing oil.

### NOTE

- Replace oil while the oil is still warm this gives a complete and quick oil change.

### PROCEDURE

- Unfasten the screws that fasten the plate on the back side of the generator and remove the plate.
- Remove the oil stick.
- Pour the used oil into a can.
- Fill with the recommended oil and check the oil level.
- Put the plate back in its place and fasten the screws safely.



### NOTE

Always get rid of the used oil in the best way so that you save the environment as much as possible.

## 7.2 Air filter

### WARNING

Never use gasoline or other flammable fluids to clean the air filter.

### PROCEDURE

- Unfasten the screws that fasten the plate on the back side of the generator and remove the plate.
- On the top of the air filter a tap is placed, press this down and the air filter is loosened.
- Wash the air filter thoroughly in mild soapy water. Rinse with warm water. Let the air filter dry thoroughly .
- Soften the filter in pure engine oil and squeeze the filter for redundant oil.
- Put the filter back in its place in the holder and in the machine.
- Put the plate back in its place and fasten with screws.

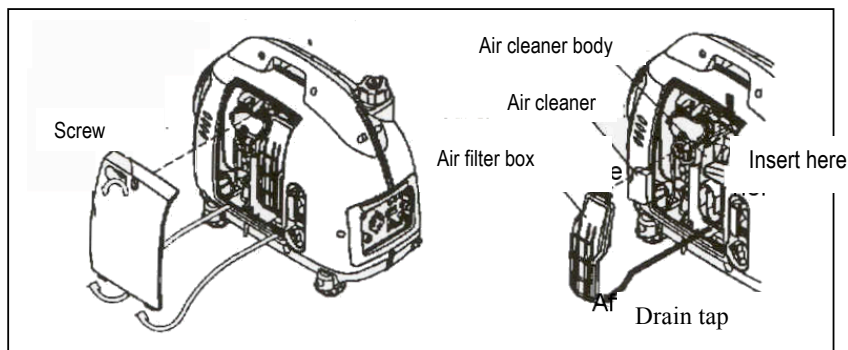

### 7.3 Spark plug

Recommended spark plugs: NGK CR5HSB / DENSO U16FSR-UB

#### PROCEDURE

- Remove the cover at the top of the generator.
- Remove the sparking plug cover.
- Remove dirt around the sparking plug.
- Use a sparking plug wrench to unfasten the sparking plug.
- Check the sparking plug, replace if the isolation has cracked.
- Clean the sparking plug with a steel brush if you want to reuse it.
- Measure the electrode distance, be careful not to damage the sparking plug.
- The distance should be 0,6 mm – 0,7 mm.
- Insert the sparking plug carefully and fasten it with a sparking plug wrench.
- Normally you have to fasten a new sparking plug by  $\frac{1}{2}$  turn by the means of the sparking plug wrench.
- You only have to fasten a used sparking plug by  $\frac{1}{8}$  –  $\frac{1}{4}$  turn.
- Mount the sparking plug cover .
- Put the cover back on the generator.

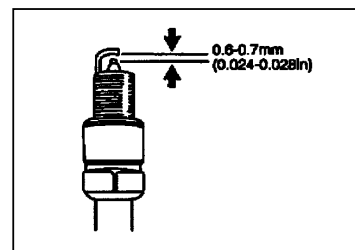
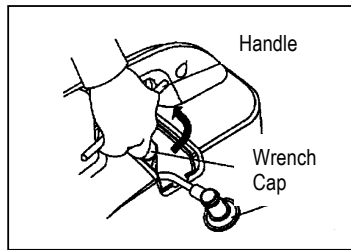
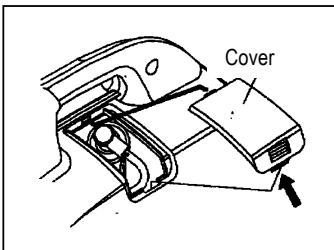

### 8. Transport and storage

#### NOTE

By transport the generator must be placed in normal standing position and the upper part of the gasoline cover is turned anti-clockwise to the "OFF" position.

#### WARNING

- Never overfill the fuel tank.
- Never use the generator while it is onboard a vehicle, only operate the generator in an open and ventilated area.
- By transport you must avoid direct sun light. If the generator is exposed for direct sun light for many hours, gasoline steams may evaporate and self-ignite.
- By transport on uneven roads for longer periods of time you should drain all gasoline.
- Always draw attention to the storage area being free for dust and damp.
- Drain all fuel from the generator before storage.

### PROCEDURE - GASOLINE

- Drain all gasoline from the tank into a container.
- Turn the ignition switch of the generator to the ON position.
- Loosen the delivery screw of the carburettor and drain all the fuel of the carburettor into a tank.
- Remove the sparking plug cover and pull the starting cable 3-4 times. Thereby the fuel is drained in the gasoline pump.
- Turn the ignition switch of the generator to the OFF position
- Fasten all screws securely

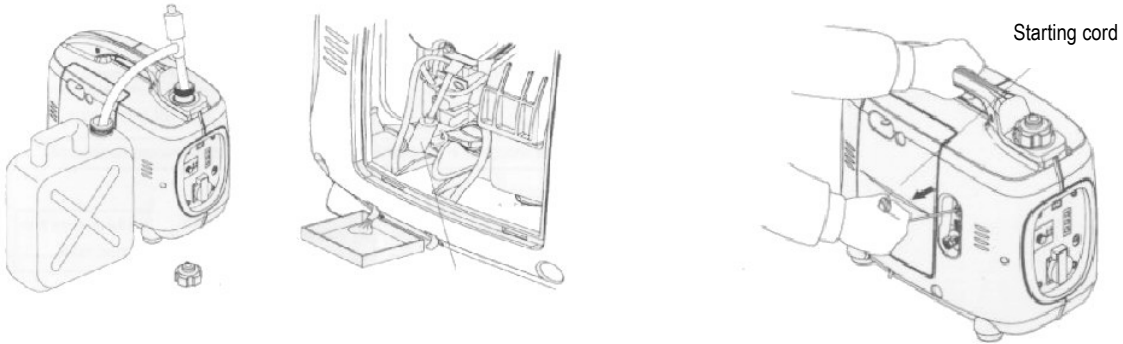

### PROCEDURE - OIL

- Change the oil on the generator.
- Remove the sparking plug and pour app. one spoonful of pure engine oil into the cylinder.
- Pull the starting cable 3 - 4 times, so that the oil is allocated. Put the sparking plug back in its place.
- Pull the starting cable of the generator slowly until you feel resistance.
- Now the generator is ready to be stored.



## 9. Specifications

---

### Dimension and weight

	B1000i	B2000i
L x B x H	450 x 240 x 380 mm	549x291x405 mm
Dry weight	14 kg	22 kg

### Engine

Model	KG55	KG105
Engine	4-stroke, OHV	
Stroke volume (drilling x stroke length)	55 cc (43,5 x 36,0mm)	64 cc (56,0 x 40,0 mm)
Compression	8,5 : 1	
Engine speed	rev/min (with automatic regulation switched off)	
Cooling	Air	
Ignition	Transistors	
Oil capacity SAE 30	0,25 Liter	0,40 Liter
Fuel tank capacity	2,1 Liter	4,1 Liter
Noise level at 7 metres distance	64 dB(a)	59 dB(a)

### Generator

Model	B1000i	B2000i	
AC ud	Volt(V)	230	
	Frequency(Hz)	50	
	Ampere(A)	3,9	7,0
	Effect (KVA)	0,9	1,6
	Max effect (KVA)	1	2,0
DC out	Only for charge of car batteries. Max load effect: 8A		

## 10. Trouble shooting

---

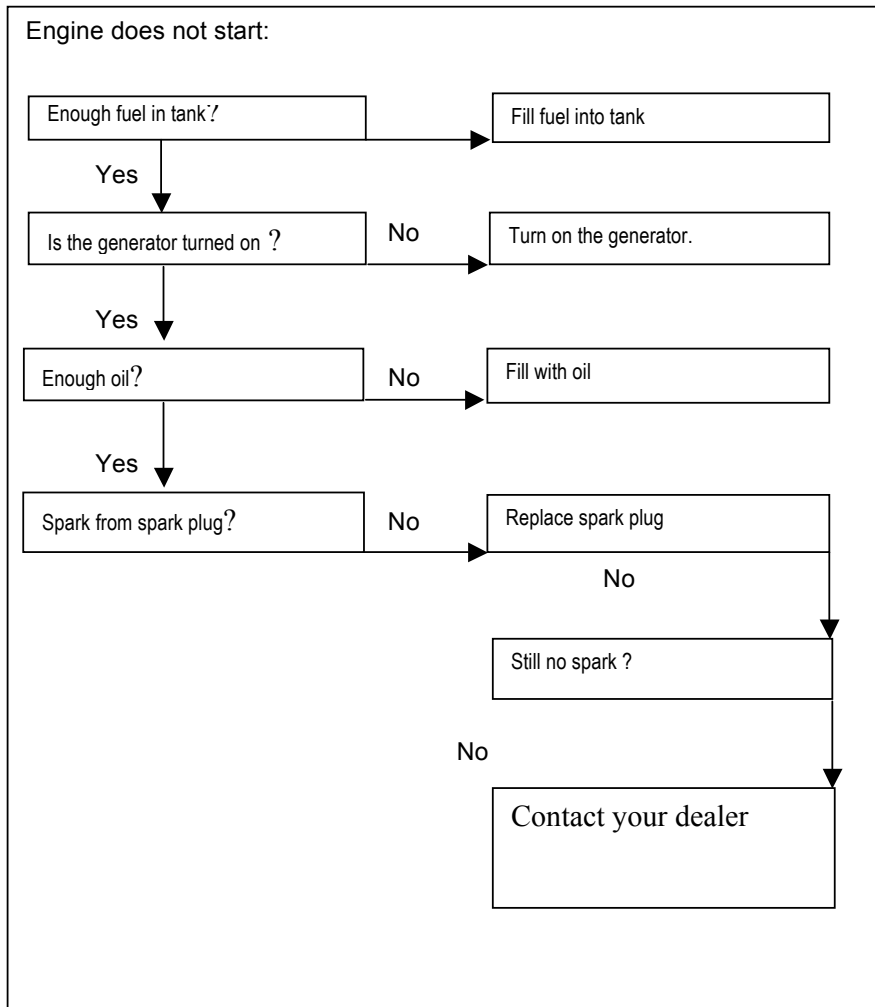

Connected tool/apparatus does not work.

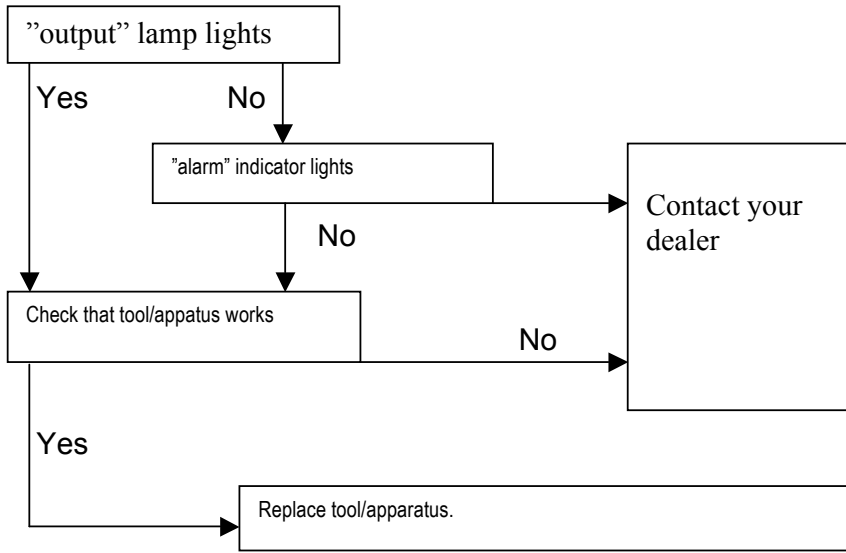

No power from DC outlet

