

***challenge***<sup>®</sup>

**12 LITRE DEHUMIDIFIER  
INSTRUCTION MANUAL**



Thank you for selecting super quality dehumidifier. Please be sure to read this manual carefully before using it. Keep the manual for future reference.

## **SAFETY INSTRUCTIONS**

Please read the operating instructions carefully before using your dehumidifier for the first time.

1. Install the appliance on flat and hard place to avoid occurrence of vibration and noise.
2. Never immerse the appliance in water or other liquids.
3. Never operate the appliance if the cable or connector is damaged, or there is something abnormal may happen.
4. Disconnect the appliance from power supply when it is not in use, or before relocating or cleaning it.
5. Operate the appliance only at the voltage specified.
6. The appliance is for indoor use only, do not use it for other purpose.
7. Do not put heavy objects on the appliance.
8. Do not cover the unit.
9. To prevent spilling, empty the water tank before restarting the appliance.
10. Do not put the unit close to heat-generating devices or near flammable and dangerous materials, don't tip the appliance to any side as spilt water could damage the appliance.
11. Never insert any slim rod and hard object into the unit body to avoid occurrence of hazard or unit failure.
12. Always store the unit upright in order to maintain the compressor in a proper working condition. Leave the unit upright for at least 24 hours before operating.
13. This appliance is not intended for use by persons (including children) with reduced physical, sensory or mental capabilities, or lack of experience and knowledge, unless they have been given supervision or instruction concerning use of the appliance by a person responsible for their safety. Children should be supervised to ensure that they do not play with the appliance.



Don't try to repair, dismantle or remold such appliance, or it may make some damage. Even if the supply cord is damaged, it must be replaced by the manufacturer or its service agent or a similarly qualified person in order to avoid a hazard.

## PLACEMENT

When positioning the dehumidifier, ensure that it is placed on a level surface and that there is a minimum of 10cm of space on either side of the unit to allow for efficient airflow.

We do not recommend the use of an extension lead, so please try to ensure that the unit is sufficiently close to a fixed main socket. If it is necessary to use an extension lead, please ensure the diameter of the wires of the cable is at least 1 mm<sup>2</sup>.

When the dehumidifier is in operation, outside doors and windows should be closed when necessary for most efficient use.

Make sure that there is no obstruction around the air inlet and the air outlet. The position of the air inlet and outlet is as below:

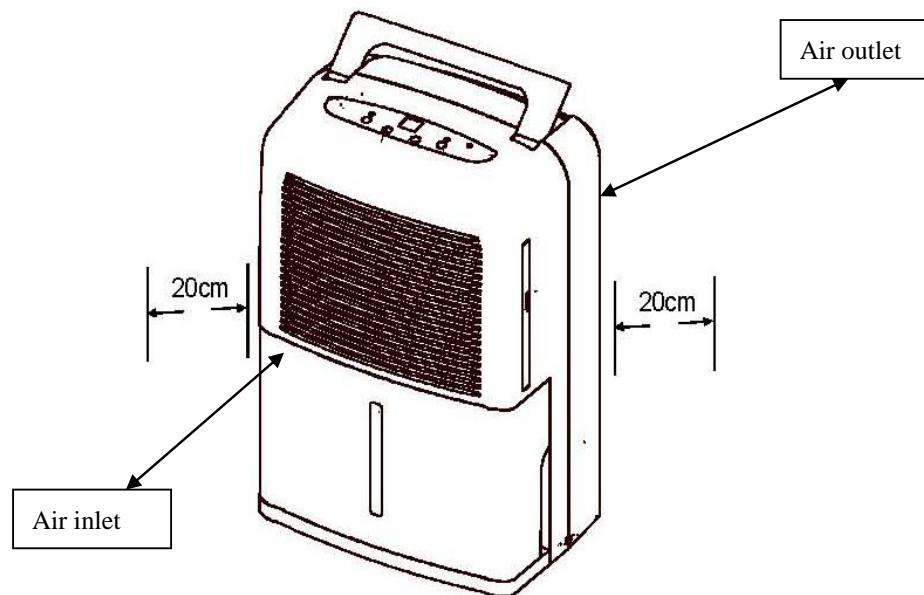

# KNOW YOUR APPLIANCE

## MAIN UNIT

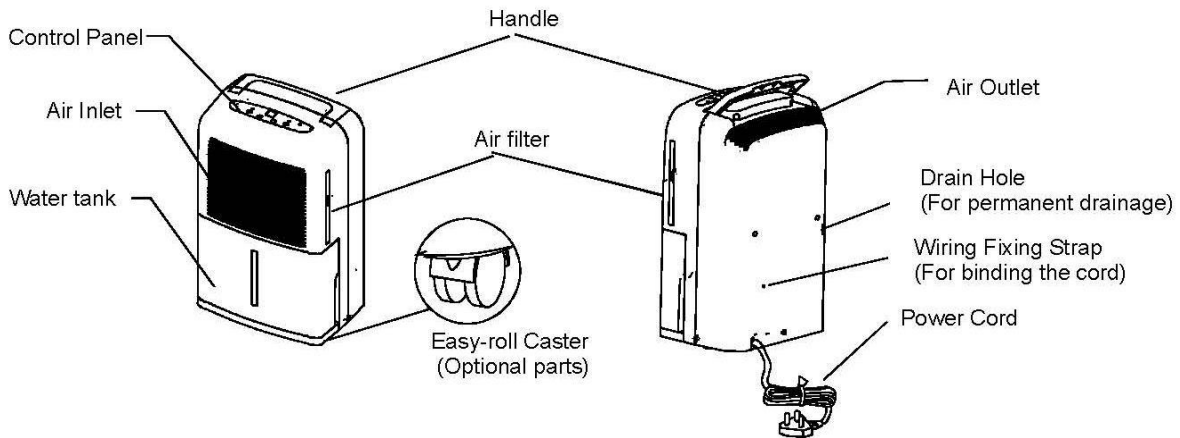

## CONTROL PANEL

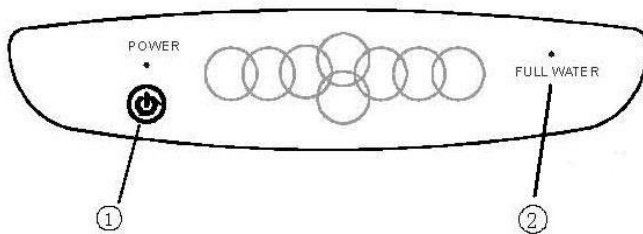

- (1) ON/OFF button
- (2) Full water indicator

## Operation

- Plug the unit into a correct mains socket.
- Press the "ON/OFF" button once. The unit will start to work and the power indicator light will illuminate.
- Press the "ON/OFF" button again. The unit will stop and the power indicator light will go off.

## Note:

1. Do not use the machine when the temperature is **over 35°C or below 5°C**.
2. When the unit has been turned off, please wait for at least 5 minutes before turn it on again. Fails to do this will damage the compressor.
3. This unit is fitted with an auto defrosting function. It will start when the evaporator generates frost. This function will start to running when the temperature goes down to 5 °C.

## DRAINAGE

While the water tank is full, the compressor will stop and the water full indicator light will illuminate.

To remove the water tank, pull it out carefully from the unit.

After emptying the water tank, place the tank back to the unit. Make sure it is properly positioned, in order for the water full indicator light to go out and your dehumidifier is operating.

Please note, in case, the water tank has not been positioned well, the water full indicator light will still illuminate.

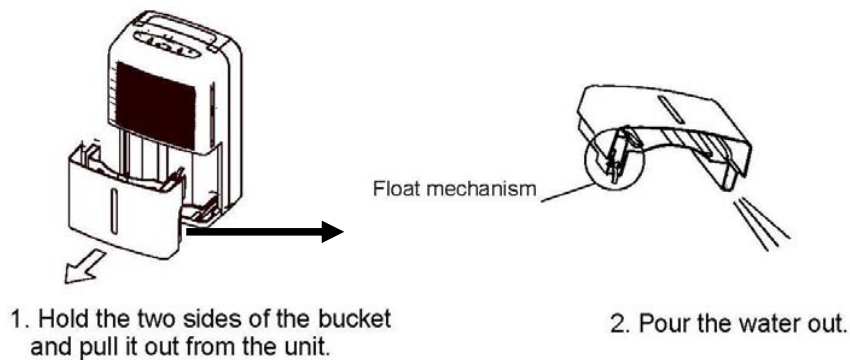

## CONTINUOUS DRAINAGE

When the dehumidifier is operated at very high humidity levels, the water tank will require more frequent drainage. In this situation, it may be more convenient to set the unit up for continuous drainage with the following procedures:

1. Remove the water tank from the unit.
2. Remove the rubber water stopper in the continuous drainage port. Keep the rubber water stopper in a safety place for future use.
3. Remove the plastic cover carefully at the back of the unit.
4. Prepare the water tube (not included) with 13.5mm internal diameter and 1.5mm thickness.
5. Insert the tube through the hole at the back to the front.
6. Connect the tube to the continuous drainage port.
7. Put the water tank back to the unit.
8. Ensure the water will always drain away freely and the tube will remain in right place & the water tank is in correct position.

**NOTE :** In very cold weather conditions, precaution should be taken to prevent the water tube from freezing.

If it is no longer to use the continuous drainage, please follow the below procedures :

1. Remove the water tank from the unit.
2. Remove the water tube from the continuous drainage port. Then pull it out from the hole at the back of the unit.

3. Insert the rubber water stopper to the continuous drainage port.
4. Put the water tank back to the unit.

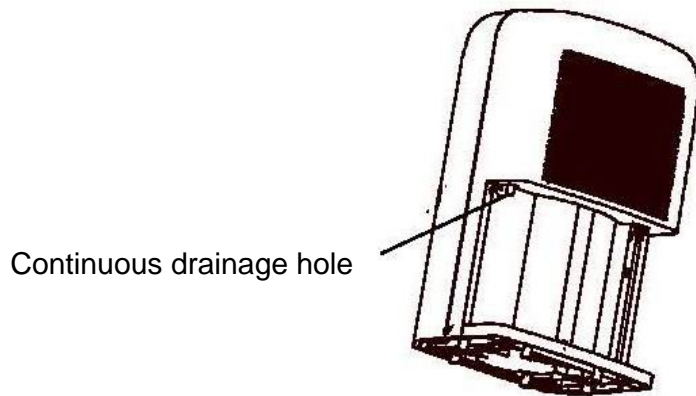
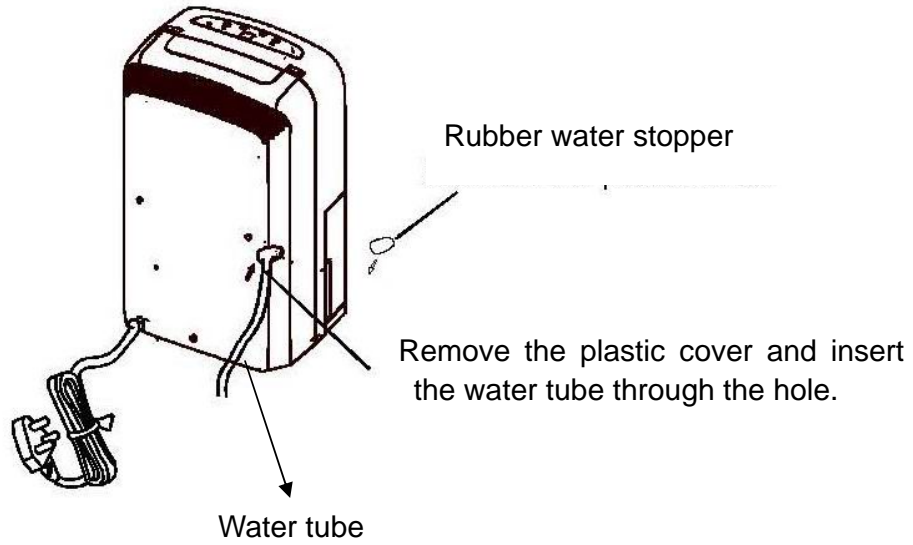

# CLEANING

Always unplug the unit from the power supply before beginning cleaning to avoid electric shocks.

## Housing

- Use a soft, damp cloth to wipe the cabinet clean. Never use strong chemicals, oil-based products, detergents, chemically treated cloths or other cleaning solution. These could damage the cabinet.

## Filter

- It is recommended to clean the air filter once every two weeks.

-Remove the water tank and extract the filter holder.

-Use a vacuum cleaner or tap the filter lightly to remove loose dust and dirt from the filter.

Rinse the filter frame thoroughly under running water.(Do not warmer than 40°C).

- Dry thoroughly before replacing.

- Do not expose the filter to sunlight.

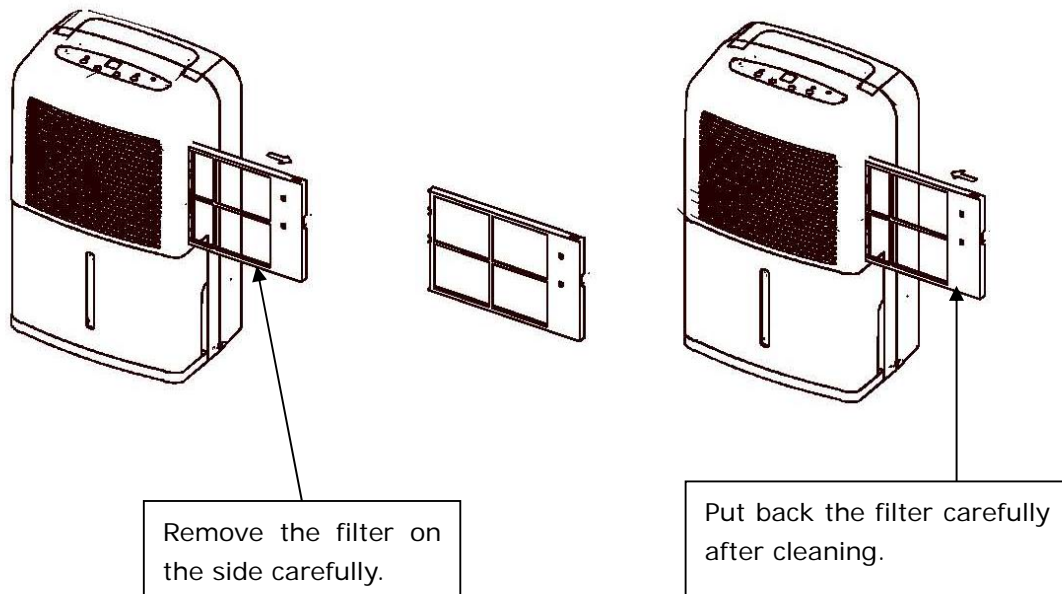

**WARNING: Never operate the dehumidifier without the filters.**

## STORAGE

If not use the unit for an extended period of time. Please:

- Turn the unit off and unplug it from the mains.
- Completely empty the water tank and wipe it clean.
- Cover the unit and store where it will not receive direct sunlight.

## TROUBLE SHOOTING

Never try to repair or dismantle the dehumidifier yourself. Incompetent repairs result in loss of warranty and can endanger the user and the property.

Problem	Possible Cause	Solution
The unit doesn't operate	Has the power cord been disconnected?	Plug the power cord into the outlet.
	Is the tank full indication blinking? (the tank is full or in a wrong position)	Empty the water in the drainage tank and then reposition the tank.
	Is the temperature of the room above 5°C or below 35°C?	The protection device is activated and the unit cannot be started.
The dehumidifying function doesn't work	Is the air filter clogged?	Clean the air filter as instructions.
	Is the intake duct or discharge duct obstructed?	Remove the obstruction from the discharge duct or intake duct.
No air is discharged	Is the air filter clogged?	Clean the air filter as instructions.
Operation is noisy	Is the unit tilted or unsteady?	Move the unit to a stable, sturdy location.
	Is the air filter clogged?	Clean the air filter as instructions.



## TECHNICAL DATA

Model	MDF-12DMN3	
Mains		220V-240V ~50Hz
Power	W	260W
Ampere consumption	A	1.4 A
Dehumidification capacity (30°C RH 80%)	L/24h	10 L/24h
Dehumidification capacity (32°C RH 90%)	L/24h	13 L/24h
Air volume(max)	m <sup>3</sup> /h	120 m <sup>3</sup> /h
Refrigerant load	g	R134a/130 g
Compressor		TATUNG FE140Y-E
Recommended room size	m <sup>2</sup>	Up to 20 m <sup>2</sup>
Water tank	L	3 L
Dimensions(W*H*D)	mm	315*505*235mm
Weight	Kg	15.5Kg



WASTE ELECTRICAL PRODUCTS SHOULD NOT BE DISPOSED OF WITH HOUSEHOLD WASTE. PLEASE RECYCLE WHERE FACILITIES EXIST CHECK WITH YOUR LOCAL AUTHORITY FOR RECYCLING ADVICE.

## CONNECTION TO POWER ( FOR UK ONLY)

Before Switching on make sure that the voltage of your electricity supply is the same as that indicated on the rating plate.

### MAIN CORD

**Wiring Instructions: Should it be necessary to change the plug please note the wires in the mains lead are coloured in accordance with the following code :**

**BLUE - NEUTRAL  
BROWN - LIVE  
GREEN AND YELLOW - EARTH**

As the colours of the wires in the mains lead of this appliance may not correspond with the coloured markings identifying the terminals in your plug, proceed as follows:

1. The **BLUE** wire is the **NEUTRAL** and must be connected to the terminal which is marked with the letter **N** or coloured **BLACK**.
2. The **BROWN** wire is the **LIVE** and must be connected to the terminal which is marked with the letter **L** or coloured **RED**.
3. The **GREEN/YELLOW** is the **EARTH** and must be connected to the terminal which is marked with the letter **E** or  $\oplus$  or coloured **GREEN OR GREEN/YELLOW**.
4. Always ensure that the cord grip is positioned and fastened correctly.

If a **13 Amp (BS 1363)** fused plug is used it must be fitted with a **13Amp** fuse. If in doubt consult a qualified electrician.

### Wiring for a 13 Amp Plug (BS1363)

Please note. The Earth Terminal is marked with the letter **E** or Earth Symbol  $\oplus$ .

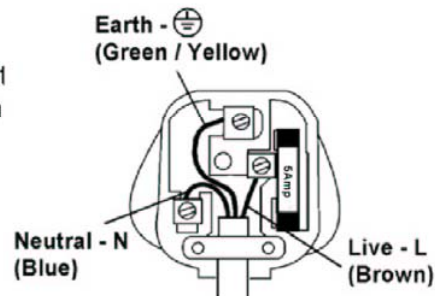

### IMPORTANT

If a 13 Amps (BS 1363) plug is used, it must be fitted with a 13 Amp Fuse conforming to BS1362 and be ASTA approved. If in doubt consult a qualified electrician who will be pleased to do this for you.



## PRODUCT GUARANTEE

This product is guaranteed against manufacturing defects for a period of



This product is guaranteed for twelve months from the date of original purchase. Any defect that arises due to faulty materials or workmanship will wither be replaced, refunded or repaired free of charge where possible during this period by the dealer from whom you purchased the unit.

The guarantee is subject to the following provisions:

- The guarantee does not cover accidental damage, misuse, cabinet parts, knobs or consumable items.
- The product must be correctly installed and operated in accordance with the instructions contained in this manual.
- It must be used solely for domestic purpose.
- The guarantee will be rendered invalidated if the product is re-sold or has been damaged by inexpert repair.
- Specifications are subject to change without notice.
- The manufacturer disclaims any liability for the incidental or consequential damages.
- The guarantee is in addition to, and does not diminish your statutory or legal rights.

Guarantor: Argos Ltd  
489-499 Avebury Boulevard  
Central Milton Keynes  
MK9 2NW