

Specifications ES80 Eclipse Series Wireless Loudspeakers

Power	120 Watts power handling all speakers wired
Frequency Response	125-20000Hz
Efficiency	88 dB@1watt 1 metre
Impedance	8 Ohms nominal
Components	2 x 75mm (3 inch) paper cone drivers 1 x 25mm (1 inch) silk soft dome tweeter
Connections	Gold plated push terminals
Dimensions	Front and rear 1018H x 135W x 132D (mm) with base Centre 110H x 360W x 145D (mm)
Weight	Front kg each, centre kg, rear kg each
Transmitter Voltage	240 Volts ~50 Hz +- 10%
Transmission	2.4000 ~ 2.4835 GHz with Auto Seeking channels
Rear Speaker Amplifier	100 watts output with adjustable volume level
Colour	Black piano & PVC finish
Standby	Uses 1 watt of power in auto standby mode

ES 80.1 Powered Subwoofer Specifications Upgrade

Amplifier	Digital Switch Mode Amp. 300 Watts RMS
Voltage	240 Volt 50 Hz +- 20%
Frequency Response	25-200 Hz
Driver	1 x 250mm (10 inch) paper cone driver
Passive Radiator	1 x 250mm (10 inch) paper cone radiator
Volume	Variable 0-10
Phase	Variable 0-180 degrees
Crossover Control	Variable 40-200 Hz
Main Power Switch	Switches Off, On
Standby	Switches Auto, On. Uses 1 watt of power in standby
Fuse	Protection 2.5 amp
Input	RCA socket
Output	RCA socket
Dimensions	350H x 320W x 375D (mm)
Weight	19kg
Colour	Black piano finish top

This system complies with AS/NZ4268: 2003

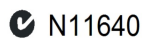

Accusound Australia Pty, Ltd
Unit 3, 17-19 Marshall Road,
Kirrawee NSW 2232
Ph (02) 9545-3905 Fax (02) 9545-3902
Email: info@accusound.com.au
www.accusound.com.au



Quality Sound by Design

Eclipse Series Home Theatre System ES 80 Wireless Instruction Manual



Please read these instructions carefully
before turning on your speakers.

Contents

Carton 1
2 x Front speakers
1 x Centre speaker / Wireless Transmitter
2 x Wireless surround speakers
4 x Front & rear speaker bases
3 x AC Power leads for wireless transmitter and 2 surrounds
8 x 30mm screws for bases

Carton 2
1 x Powered Subwoofer

Congratulations! You have purchased the Accusound Eclipse Series ES80 Wireless Home Theatre System. This Wireless system has taken 12 months of development. Designed in Australia to the closest tolerance make this the leading wireless system on the market today. The ES80 Wireless system has been designed to work on any digital receiver on the market. The system will give you clear vocals and crisp high-end response from all 5 speakers and solid bass performance from the powered subwoofer that many other leading brands lack.

Unpacking

On the large carton fold back the carton flaps, turn the carton upside down and remove the carton. There are 4 floor standing speakers, 4 bases, 1 centre speaker with a wireless transmitter built in. Slide out each speaker from the foam inserts leaving the speakers in the cloth bags which will protect them until you have installed the system. All the parts are located in a box. Remove these parts and check against the contents list. Screw the bases on to the 4 floor speakers using the 8 x 30mm screws supplied x (2 for each base). Unpack the second carton this contains the subwoofer.

Just in Case: If you ever move, keep the cartons and packing to ensure protection against damage.

Room Placement

In a 5.1 setup your front speakers should be positioned on either side of the screen as wide apart in the room as possible. The centre speaker sits in a horizontal position on or in an entertainment cabinet facing towards the rear surround speakers with a clear line of sight to the surround speakers. Depending on your room the best position for the left and right surround speakers are slightly back on either side of your seating position facing you (this is position 1 in the diagram). If there are windows and doors in the way place the speakers in either corner of the back wall of your room facing up the room (this is position 2 in the diagram). Each speaker is marked on the back with its position. You should always look towards the front where the TV is for your position. Front left, centre, front right, rear surround left is on your left as you look forward and rear surround right is on your right as you look forward. This is very important as each speaker is tuned for its position. The positioning also depends on power at the back of the room as each surround speaker is wireless and has to be plugged into the power. Each surround speaker has a built-in amplifier to produce the sound and is fitted with a receiver to receive the signal. The ES 80 subwoofer is also powered by its own built-in amplifier. You can place the subwoofer anywhere in the room.

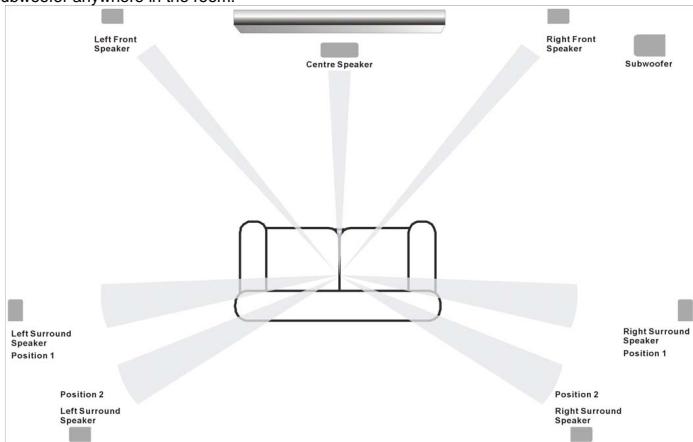

Room Placement

SPEAKER LEVELS - DO NOT PERFORM THE AUTO CALIBRATION

Most home theatre receivers have an auto speaker set up. Some have a microphone that sets the level of each speaker. The Accusound ES 80 Wireless surrounds are powered and your receiver will not understand that the surround speakers are plugged into a wireless transmitter. Follow the speaker set up mode on your receiver. Your receiver should be set as follows. Fronts, centre, surrounds, subwoofer all to 0dB. Confirm with your receiver's manual how their settings are configured as we are basing this on -12 to +12 for each individual channel. Zero is 0dB. Some receivers have -20dB to 0dB so -10 is in the middle. These settings are separate to your main volume control.

Listen to hear if all speakers are balanced. You may have to turn the centre up or down for vocals, surrounds for effects and the subwoofer for bass to get the correct level. Make sure you do not produce distortion as this can damage the speakers. You also have a further adjustment on the rear panel of the surround speakers if you need to turn the volume up or down. This was set to zero initially. Do not turn past +2.

Subwoofer Set up

Use a good quality subwoofer RCA cable (not supplied) from your receiver's subwoofer output and plug into the subwoofer **IN** on the rear panel of the subwoofer. There is a main power **off/on** switch at the bottom of the subwoofer panel. Turn to **on**. At the top of the panel there is an **On/Auto** switch. **On** will have the subwoofer running all the time, in the **auto** position the subwoofer will automatically turn on when a signal is received from your receiver. After a short time of not receiving a signal the subwoofer will turn to standby. There is a light on the subwoofer. Red is for stand-by and green is for on. This is a power saving function and also saves turning the power switch on and off every time you use the subwoofer and system. Leaving the subwoofer in **auto** is the standard setting. When the system is not being used for a period of time or during electrical storms, turn the subwoofer **off** at the main power switch.

Non Wireless Surround Speaker and Subwoofer Connection

You have the choice to bypass the Wireless surrounds and connect them in a wired format. Remove the power lead from the rear speakers and connect speaker wire from the receiver's surround speaker outputs to each surround speaker. You can NOT connect wireless and wired together. If you do this it will damage the surround speakers. This method does not require the transmitter to be connected to the receiver.

Breaking In Your Speakers

The Accusound ES 80 Wireless Series loudspeaker system requires a break-in period to reach its full potential. This is done by playing with a wide variety of frequencies (highs through lows) at a medium volume for at least 30 hours. You can turn the system up during this time but this is not recommended for long periods. We use high quality components with tight build tolerances and they require this break-in time. After this period you will hear a refinement in the bass reproduction and the treble will become clearer and more defined. The system is designed to have power connected all the time. This system has the new 1 watt standby mode. When your system is in standby it will only draw 1 watt of power.

With any electrical equipment you can have problems with lightning strikes. If you have an electrical storm, turn your equipment **off** and use a good quality surge protector. If you are going away for a period of time turn your entire system **off** at the power.

ES 80 Wireless 5.1 System

Now it's time to sit back and enjoy your new Accusound Home Theatre Loudspeaker System. This is an investment in quality sound that you will appreciate time and time again for many years to come. Thank you for choosing Accusound!



Volume Control

Subwoofer Control Panel

The volume control runs from 0-10. We suggest the volume be set to 5 - 7 and then controlled by the subwoofer setting on your receiver. When listening to movies or music make sure that the subwoofer does not go into distortion. You can hear this as a distorted crackling sound which is usually caused when the subwoofer level on your receiver is set too high. Ease the volume back so you get a good solid bass. This will ensure the subwoofer will play for years to come.

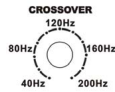

Crossover

The crossover is the heart of the ES 80 system. As you turn the crossover control up you add upper bass. The best setup is to fill the gap between the speakers that can not produce lower bass. At normal levels the speakers go down to 120Hz. The control starts at 40Hz and goes to 200Hz. We suggest around 120 Hz to start. You can add or decrease the frequency to achieve the correct balance for either music or movies. The control only adds higher frequency. It does not alter the low frequency.



Phase Control

This function adjusts the phase of the subwoofer driver. This adjustment is required to ensure that the subwoofer and all other associated loudspeakers operate "in sync." If your main speakers are at the front of the room the woofers are pushing forward. If your subwoofer is at the front of the room the woofer will be pushing forward. Turn the phase control to 0. At the back of the room the subwoofer is pushing in an opposite direction. Turn the phase control to 180 degrees and the subwoofer will fire in the opposite direction and be in sync. If you place the subwoofer at the side of the room you run between 40-160 degrees. To hear bass all around the room you will have to adjust the phase to find the best setting.

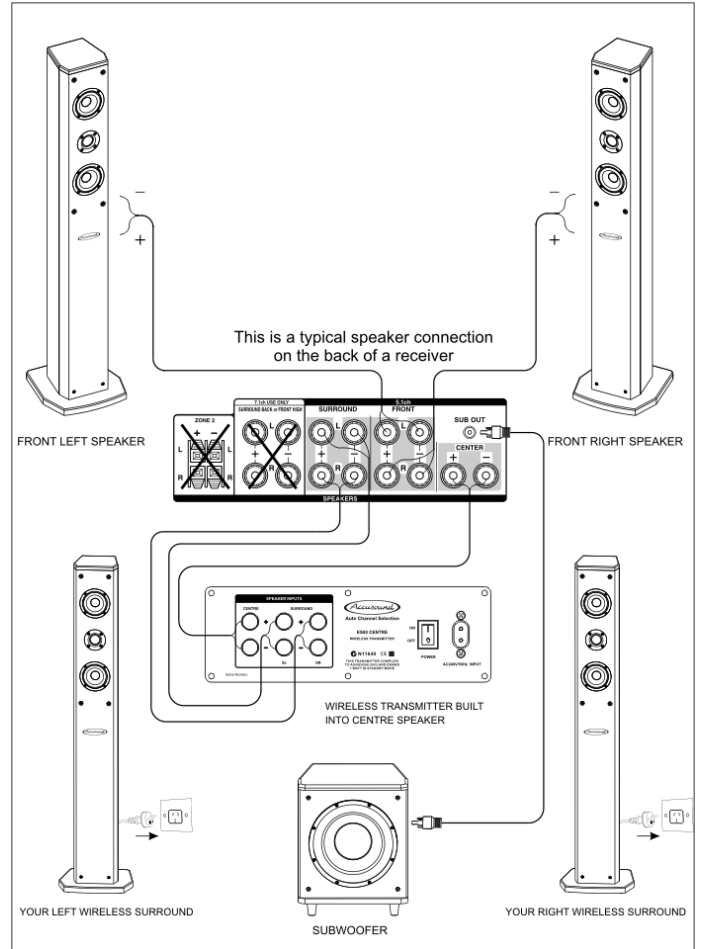

Wiring Diagram

Speaker Terminals

Speaker wire can be inserted into the hole in the shaft of the speaker's and transmitter terminals. Simply strip away approximately 10mm of the wire jacket, push the connection terminal in and insert the wire through the hole in the shaft. Release the terminal and it holds the speaker wire in place. Make sure no stray wire strands touch the opposite terminal. If a wire is loose, it can cause a crackling or static type sound that can be heard through the speaker. If it comes loose and touches the other terminal, it can cause your receiver to go into protection mode.

Front Speaker Connections

On the back of the 2 front speakers are 2 push in connection terminals. Red is positive (+) and Black is negative (-). From your receiver's positive terminal connect the speaker wire to the (+) mark which is the Red terminal on the speaker. Push the terminal in and insert the wire into the hole. Release the terminal and the wire is connected. Connect the negative (-) wire to the Black terminal.

Centre Speaker / Wireless Transmitter

On the back of the transmitter there are 3 sets of speaker connections. Look at the wiring diagram on page 3 for the connections. Connect speaker wire from your receiver's surround speaker terminals and the centre speaker terminals to the left and right inputs and centre input on the transmitter. Please ensure that the left surround output goes to the left surround input and the same for the right side. Do the same with the centre speaker connection. . Make sure the polarity + to + and - to - is correct.

Power Switch

There is a 2 pin power socket on the back of the centre/transmitter. Plug the power cable supplied in. There is a power switch. Turn this on and leave it on as this goes to standby when the system is not being used.

Wireless Surround Speaker Connection

Plug the surround speakers into the power. Turn on the rear power switch and set the volume control at zero. This can be adjusted to fine tune later. When you are not using the system for a long period or go on holidays, turn the power switch to **off** on the back of each surround speaker.

Wireless Transmitter Surround set up

To get connected turn your receiver on and have a movie or music playing. If you have a setting called All Channel on your receiver, use this for the set up as it will give you sound in all the speakers. If you play a 5.1 movie you may not get sound out of the wireless surround speakers unless the movie is producing sound from the surround speakers.

Wireless Transmitter built into Centre Speaker

The wireless transmitter works on 2.4000GH to 2.4835GH. The transmitter finds a clear channel if you have interference with cordless hand phones, wireless internet or microwave ovens.

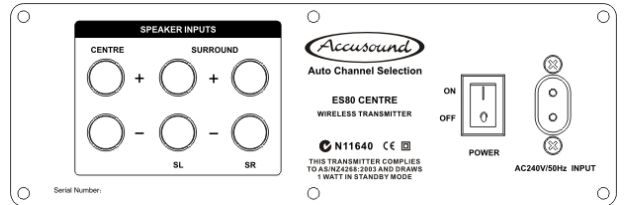

Wireless Transmitter Rear Panel

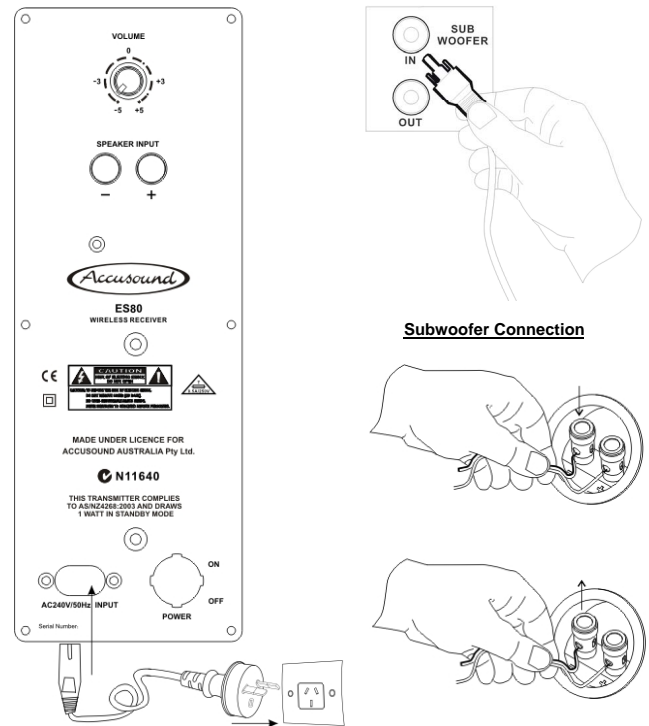

Wireless Receiver

Speaker Terminal Connection