

THANK YOU FOR CHOOSING AEG

Follow these instructions to successfully install your AEG solar inverter of the series AS-IC01-2:

AS-IC01-2 three-phase grid-tied solar inverter, 2 MPPT; AS-IC01-4000-2/5000-2/6000-2/8000-2/10000-2

CONTENTS

1. Safety Recommendations
2. Product unpacking and inspection
3. Before installation
4. Mechanical installation
5. Electrical installation
6. Operation
7. More information / Contacts

1. SAFETY RECOMMENDATIONS

General safety recommendations

- Only qualified electricians are allowed to install the inverter.
- Make sure the installation site is not accessible to children or non-authorized personnel.
- Remove metal accessories such as rings or bracelets before installation and electrical connection to avoid electric shock.

Product safety recommendations

- Do not put and install the inverter on or close to combustible materials.
- Install the inverter far from devices with strong electromagnetic interference.
- To avoid product damage, ensure the inverter input voltage does not exceed the maximum input voltage.
- Ensure a stable installation and a reliable electrical connection, as well as proper grounding of the inverter; improper connection or no grounding may cause the inverter to stop functioning.
- To avoid irreparable damage, ensure that the positive and negative poles of solar modules are not grounded.

2. PRODUCT UNPACKING AND INSPECTION

2.1 Product inspection

Double-check the order information and the product nameplate to ensure the products are of the ordered type and that the package is not damaged. Should you find any problems, contact your supplier as soon as possible.

In the packaging of your AEG inverter you will find:

Model	4000-2 5000-2 6000-2 8000-2 10000-2
Inverter	1
Installation bracket	1
Quick installation guide	1
Communication connector	1
Expansion bolts	4 (M6*60)
DC connector	1
AC connector	1

Table 1: Three-phase inverter packing list

2.2 Product look

Front and side view of AEG AS-IC01-2 three-phase grid-tied solar inverter

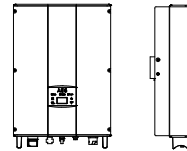

3. BEFORE INSTALLATION

Before installing your AEG grid-tied solar inverter, please take in consideration the following aspects:

3.1 Installation place

- Select the installation place considering that:
- 1- The environment temperature should be between -25°C and 60 °C.
 - 2- The installation surface should be perpendicular to the horizontal line. Please refer to figure 2 here below.

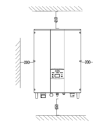

Figure 1: Installation space (mm)

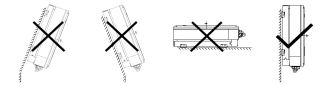

Figure 2: Installation position

3.2 Cable specifications

Select connection cables according to the below table:

Model	DC side	AC side
	Cross-section	Mini cross-section
AS-IC01-4000-2/ 5000-2/ 6000-2/ 8000-2/ 10000-2	4 mm ² (12 AWG)	4 mm ² (12 AWG)

Table 2: Cable specifications

4. MECHANICAL INSTALLATION

We take as reference a typical installation environment, such as a concrete wall.



Figure 3: Installation brackets, AS-IC01-2 4000 to 10000

Model	Installation hole
	A x B
AS-IC01-4000-2/ 5000-2/ 6000-2/ 8000-2/ 10000-2	260 mm x 45 mm

Table 3: Size of installation bracket

Follow these steps to install your AEG inverter:

1- Define the installation hole with aid of the installation bracket, and use the expansion bolts to fix the installation brackets to the designed location on the wall.

2- Lift the inverter to suspend it to the installation brackets and fasten with M8 hex socket cap screws.

3- Fasten the M5 screws and fasten the inverter to the bracket. Make sure the inverter is fastened firmly to the bracket.

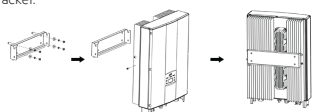

Figure 4: Installation brackets, AS-IC01-2 4000 to 10000

5. ELECTRICAL INSTALLATION

Follow the next step to carry out the electrical wiring of your AEG inverter:

1- Before connecting the three-phase AC grid cable to the inverter, take lightning and short circuit protection measures in accordance with the local electrical safety codes.

2- As shown in Figure 6 below, connect and fasten L1, L2, L3, N (optional) and PE conductors of the three-phase common grid to the AC terminal, and then connect the terminal to the inverter's AC port.

3- Fix and connect the DC output cables of the PV module with the matching DC connectors, and then connect the connectors to the inverter's DC port.

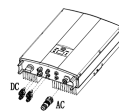

Figure 5: Electrical wiring of the inverter

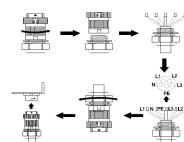

Figure 6: Connection of the AC to the inverter

6. OPERATION

6.1 Pre-operation inspection

Before starting inverter operations, please make sure to:

- 1- Check that the voltage of the components is in the allowed input voltage range of the inverter.
- 2- Check that the voltage of the AC grid is regular.
- 3- Check that the inverter is well grounded.
- 4- Ensure that all the switches are positioned on „OFF“
- 5- Ensure that all electrical safety precautions are clearly identifiable at the installation site.
- 6- Make sure that the WiFi stick (if used) is well connected.

6.2 Commissioning

To start the inverter:

- 1- Switch on the integrated DC switch.
- 2- Should you wish to change the default country, currency and time settings (Netherlands, EUR, GMT+1) of the inverter, you can use the External Display or the WiFi Stick (local monitoring mode via the app AEG InverterControl).

In this case Install the WiFi Stick and the App as described in chapter 3 and 4.1 (page 6) of this guide, then connect your phone with the wireless network „AEG WiFi“ (generated by the WiFi Stick). Launch the App and select: Local Monitoring > click on your WiFi Stick picture > More > Parameter > change the individual parameters)

- 3- Switch on the breakers at the AC side
- 4- Check the LED indicators and the information displayed on the LCD screen / on the external display.

	Run Alarm Fault	The green indicator blinks, the other indicators are off: the inverter is on and is in self-inspection mode
	Run Alarm Fault	The green indicator is on, the other indicators are off: the inverter is in power generation mode after self-inspection. The inverter was successfully commissioned

	Run Alarm Fault	„Alarm“ or „Fault“ indicators are on or blinking: the inverter is on, but faults are occurring
	Run Alarm Fault	

For the complete list of errors and warnings, see the extended version of the installation manual at www.aeg-industrialsolar.de/aeg-inverter-service

6.3 Accessories (Complements) and wiring

Complements to the inverter are :
-the External Display (optional)
-the WiFi Stick

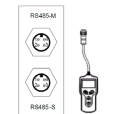

Figure 8: Complements to the inverter

6.4 Regular maintenance

To carry out maintenance, inspection or troubleshooting operations on the inverter, stop the device as follows:

- 1- Switch off the breakers at the AC side.
- 2- Switch off the integrated (inverter's) DC switch
- 3- Contact your local distributor or the AEG Inverter Service.

7. MORE INFORMATION / CONTACTS

You can download the extended version of the AEG grid-tied three-phase solar inverter and the related Warranty Conditions at www.aeg-industrialsolar.de/aeg-inverter-service.

Solar Solutions GmbH
Schneckenhofstrasse 19
60596 Frankfurt am Main
Germany
service@aeg-industrialsolar.de

Last updated: March 2018
AEG is a registered trademark used under license from ElectroLux AB (publ).

AEG

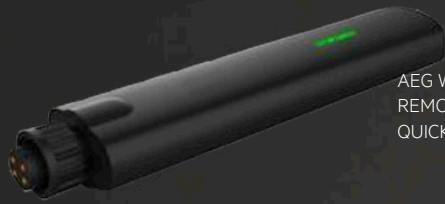

AEG WiFi STICK
REMOTE MONITORING
QUICK SETUP GUIDE

DOCUMENT REVISION: PL201803 EN V1-18

THANK YOU FOR CHOOSING AEG

Follow these instructions to successfully monitor the performances of your AEG grid-tied solar inverter with the AEG WiFi Stick. This guide is meant to provide a reference for setting up the AEG WiFi Stick in Remote Monitoring modus with the aid of the AEG InverterControl App.

The AEG WiFi Stick is a communication module enabling the transmission of relevant performance data from your AEG inverter to the monitoring software (AEG InverterControl App and AEG InverterControl Monitoring Webportal)

CONTENTS

1. Safety Recommendations
2. Product unpacking and inspection
3. Mechanical installation
4. Configuration
5. Monitoring your plant
6. Troubleshooting

1. SAFETY RECOMMENDATIONS

General safety recommendations

- Only qualified electricians are allowed to install the AEG WiFi Stick.
- Make sure the installation site is not accessible to children or non-authorized personnel.
- Remove metal accessories such as rings or bracelets before installation and electrical connection to avoid electric shock.

Product safety recommendations

- Do not store, place or install the AEG WiFi Stick on or close to combustible materials.
- Ensure reliable connection between the AEG WiFi Stick and the inverter.

2. PRODUCT UNPACKING AND INSPECTION

2.1 Product unpacking

Double-check the order information and the product nameplate to ensure the products are of the ordered

type and that the package is not damaged. Should you find any problems, contact your supplier immediately.

IMPORTANT: Please keep the package of the AEG WiFi Stick. On the box you will find relevant information such as the Serial Number and the Product Key which are needed to complete the configuration process.

2.2 Product inspection

Product look



Figure 1: AEG WiFi Stick look

3. MECHANICAL INSTALLATION

The AEG WiFi Stick should be fastened to the installed AEG solar inverter following the steps below:

- 1- Complete the installation of your AEG inverter in the selected place.
- 2- Connect the DC input and switch on the inverter without the AC grid (AC disconnect / switch off)
- 3- Fasten up the WiFi Stick to the RS485 port of your AEG inverter.
- 4- Wait until the hotspot „AEG WiFi“ can be found. Check the available wireless networks from your mobile or PC to understand if the hotspot was successfully set up.
- 5- Now you can proceed to configuring the WiFi Stick.

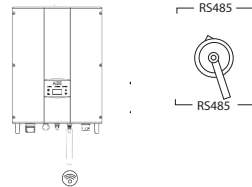

Figure 2: AEG WiFi Stick connected to an AEG inverter

4. CONFIGURATION

Before starting with the Remote Monitoring configuration of the AEG WiFi Stick, you first need to register a Remote Monitoring Account via the AEG InverterControl App.

4.1 The AEG InverterControl App



The AEG InverterControl App for iOS and Android is available in the App Store and Google Play respectively.



4.2 Registering an account via the App

1	Download the AEG InverterControl App from the App Store / Google Play	
2	Launch the App and select „Remote Monitoring“	
3	You will be prompted to the Login and Registration page. Click on the „Register“ button.	
4	Fill in the data. Please make sure that you choose a User Name without special characters / blank spaces. Press „Register“ to confirm.	
5	Return to the main interface of the app. Select „Remote Monitoring“	

6	Login with the Remote Monitoring Account you just created.	
7	Click „+“ to add a new plant.	
8	Fill in the required data and confirm with „OK“.	
9	Now add the WiFi Stick: select your plant and click on „+“	
10	Click on „Device Info“	
11	On the Collector page, click on „+“ to add a WiFi Stick.	

12	Input the name of the WiFi Stick (you can choose one arbitrarily) along with the Serial Number and Product Key that you will find on the WiFi Stick packaging (and/ or on the product itself).	
13	The Serial Number (1) is written under the bar code. The Product Key (2) is the 6-digit number. Press „OK“ to save the settings and proceed.	
13	Refresh the App and you will find the newly added WiFi Stick.	

If you have more inverters in your plant, please repeat steps 10 to 13 to add the extra WiFi Sticks to the plant.

You can now proceed to configure the AEG WiFi Stick for Remote Monitoring via the App following the below procedure.

4.3 Configuring the WiFi Stick for Remote Monitoring

1	Enable the WiFi on your mobile device (phone, tablet) and connect it to the hotspot „AEG WiFi“.	
2	Launch the AEG InverterControl App and select „WiFi settings“.	
3	Click the „Search“ (lens) icon to find the WiFi Stick. Alternatively, click the „+“ icon and confirm the IP address.	

You can download the extended version of the AEG WiFi Stick Installation Guide online at www.aeg-industrialsolar.de/aeg-inverter-service

5. MONITORING YOUR INVERTER

1	Launch the AEG InverterControl App, select „Remote Monitoring“ and login with your credentials.	
2	Select your plant and click on the „>“ icon.	
3	Access the general interface of your plant. By clicking on the monitoring options you can access the different reports and monitoring parameters	

6. TROUBLESHOOTING AND FURTHER INFO

Should you need to check that the connection between your WiFi Stick and the router is working correctly, connect your mobile device with the wireless network of your router and select „WiFi Settings“ in the AEG InverterControl App. If you cannot find the WiFi Stick or if the settings are not correct, reset the WiFi Stick and set the parameters again (see 4.3 „Configuring the WiFi Stick for Remote Monitoring“, steps 1 to 5).

If you need to reset the WiFi Stick, press and hold the reset button for 5 seconds.

For further configuration possibilities for your AEG WiFi Stick see www.aeg-industrialsolar.de/aeg-inverter-service.

4	Click on the WiFi Stick when the App finds it.	
5	Select the parameters as indicated here below: Net Mode: select WiFi-STA SSID: Select your WiFi router Password: input the password of your WiFi router Network Mode: select „Client“	
6	Apply the settings by clicking the „Save“ button (top right). The hotspot of the AEG WiFi Stick will now disappear.	
6	Wait for approximately 15 minutes to allow for synchronization.	
7	Launch again the AEG InverterControl App. Select „Remote Monitoring“.	
8	Login with your credentials.	
9	You have now successfully installed your WiFi Stick and you can start monitoring your inverter.	